

The Resolver Story



power is lost and restored, the exact position data will be communicated. In long cable runs a resolver signal can typically go much further than other technologies. Resolvers have long been the standard rotary position method in packaging, primary metals manufacturing, stamping, automotive, tire and rubber, paper mills and mining.

GEMCO 1986 resolvers have been the preferred source for rugged and accurate rotary positioning in a variety of industrial applications. The brushless resolver works on the same principle as a rotary transformer to couple power in the rotor. The internal brushless resolver has three separate windings: a reference winding, a SIN winding and a COS winding. The reference winding is excited by an AC voltage. The SIN and COS winding are set 90° apart and provide two different output voltages whose ratio represent absolute position of the shaft.

The advantage of resolver transducers over other rotary position products is that resolvers hold up better in harsh environments and they are always absolute, so if

GEMCO has always been a pioneer in the design and manufacturing of “built to order” resolver packages. We can mechanically and electrically match any competitor’s package while improving on the overall design to enhance the performance, accuracy or durability. Through our wide range of materials for construction and precision gear reducers we can extend your sensor’s life many times over. We offer packages with multiple sensors and gear reducers in a variety of materials. We have engineered special resolver packages with stainless steel housings, oil filled packages, high RPM, high resolution, resolver/encoder combinations and tach generators.

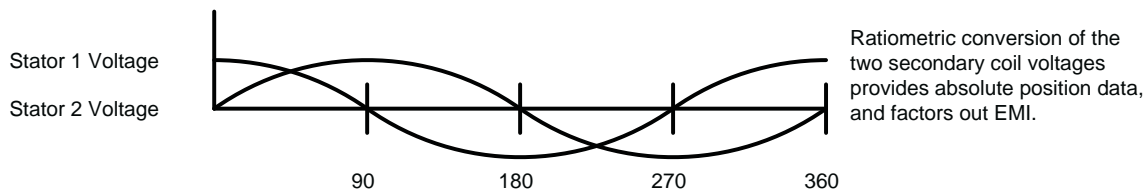

Resolver Specifications										
1986	A	B	C	D	E	F	G & GG	H	I	MD
Shaft Loading Axial	150 lbs. Max.	45 lbs. Max.	45 lbs. Max.	150 lbs. Max.	125 lbs. Max.	200 lbs. Max.	200 lbs. Max.	20 lbs. Max.	50 lbs. Max.	50 lbs. Max.
Shaft Loading Radial	100 lbs. Max.	45 lbs. Max.	45 lbs. Max.	100 lbs. Max.	75 lbs. Max.	400 lbs. Max.	400 lbs. Max.	40 lbs. Max.	100 lbs. Max.	500 lbs. Max.
Enclosure	NEMA 4	NEMA 4	NEMA 4	NEMA 4	NEMA 4	NEMA 13	NEMA 13	NEMA 13	NEMA 4	NEMA 4/13
Temperature	-40° to 125°C (DeviceNet versions -20° to 70° C)	-40° to 125°C (DeviceNet versions -20° to 70° C)	-40° to 125°C	-40° to 125°C	-40° to 125°C	-40° to 125°C	-40° to 125°C	-40° to 125°C	-40° to 125°C	-40° to 125°C
Shock	50G's for 11 mSec	50G's for 11 mSec	50G's for 11 mSec	50G's for 11 mSec	50G's for 11 mSec	50G's for 11 mSec	50G's for 11 mSec	50G's for 11 mSec	50G's for 11 mSec	50G's for 11 mSec
Vibration	5 to 2000Hz @ 20G's	5 to 2000Hz @ 20G's	5 to 2000Hz @ 20G's	5 to 2000Hz @ 20G's	5 to 2000Hz @ 20G's	5 to 2000Hz @ 20G's	5 to 2000Hz @ 20G's	5 to 2000Hz @ 20G's	5 to 2000Hz @ 20G's	5 to 2000Hz @ 20G's
RPM	5,000 Max.	5,000 Max.	5,000 Max.	5,000 Max.	5,000 Max.	5,000 Max.	5,000 Max.	5,000 Max.	5,000 Max.	5,000 Max.
Agency Approval	CE	CE	CE	CE	CE	CE	CE	CE	CE	CE



A Series

1986		A	1	X	R	X	
Mounting Configuration and Shaft Size		Single/Multi-Turn		Connection		Options	
A	Standard foot mount 3/4" input shaft	X	Single turn resolver. No gear reducer.	R	Standard rear mount connector.	X	None
		GR_	Single turn resolver with internal gear reducer. Select ratio from list below, insert after GR.	S	Side mount connector.	P	Additional protective shaft seal for high pressure washdown environments.
		GM_	Single turn resolver with internal gear multiplier. Select ratio from list below, insert after GM.	A_	Rear exit potted pigtail with bare leads. Insert cable length in feet after A.	SA	All stainless steel construction for mounting configuration "A" includes stainless steel mounting foot.
		D1	64 turn dual resolver.	B_	Side exit potted pigtail with bare leads. Insert cable length in feet after B.	E	Stainless steel input shaft and corrosion resistant epoxy coating on all exposed metal.
		D2	128 turn dual resolver.	C_	Rear exit potted pigtail with standard connector on end of cable. Insert cable length in feet after C.	Gear Multipliers	
		* Lengths may vary with gear reducer		D_	Side exit potted pigtail with standard connector on end of cable. Insert cable length in feet after D.		
Resolver Electrical Output Characteristics							
1	Standard output compatible with all Gemco electronic modules and Autotech. Resolver No. 04535001						
2	Special output compatible with AMCI resolver input devices. Resolver No. 04535076						
3	Special output compatible with GE axis positioning modules. Resolver No. 04535044						
4	Special output compatible with Modicon motion cards. Resolver No. 04535051						
5	Special output compatible with Reliance resolver input card. Resolver No. 04535023						
DN	DeviceNet output, DeviceNet only offered with rear connector. Resolver No. 04535001						

Wiring		
GEMCO and GE Resolvers		
Pin	Rotor	Wire Color
A	R1	Red/White
B	R2	Yellow/White
C	S3	Black
D	S1	Red
E	S2	Yellow
F	S4	Blue
AMCI and Modicon Resolvers		
A	R2	Yellow/White
B	R1	Red/White
E	S4	Blue
C	S2	Yellow
F	S3	Black
G	S1	Red
Namco Resolvers		
A	R1	Red/White
B	R2	Yellow/White
C	S4	Blue
E	S2	Yellow
F	S1	Red
G	S3	Black
Reliance Resolvers		
A	R1	Red/White
B	R2	Yellow/White
F	S3	Black
D	S1	Red
G	S2	Yellow
E	S4	Blue

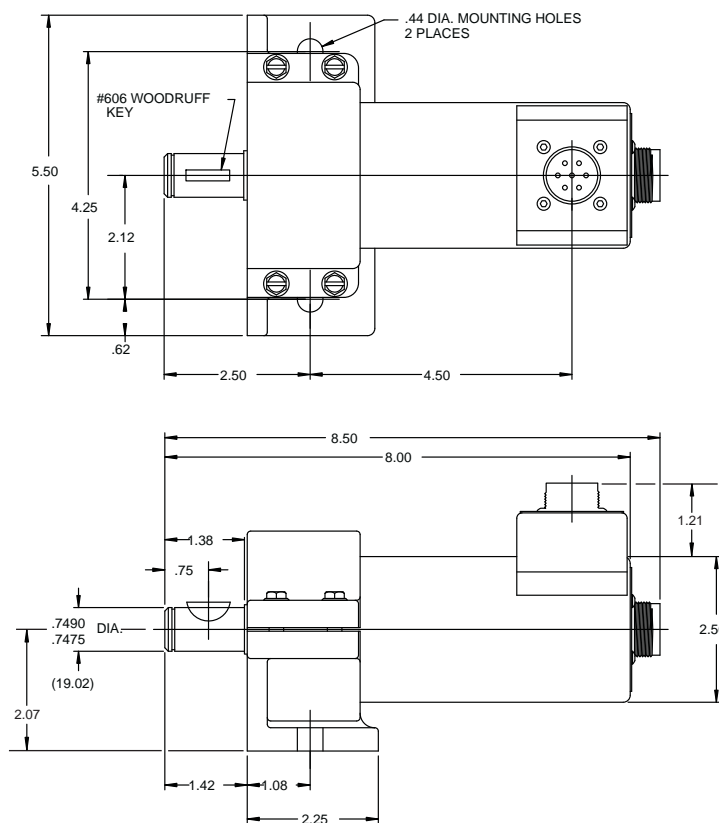

Single Resolver Gear Reducers			
1.5:1	15:1	50:1	180:1
2:1	16:1	54:1	200:1
3:1	17:1	58:1	210:1
4:1	18:1	60:1	225:1
4.75:1	19:1	64:1	250:1
5:1	19.5:1	65:1	270:1
6:1	20:1	70:1	310:1
6.15:1	21.66:1	73:1	350:1
7:1	23:1	75:1	360:1
7.5:1	24:1	80:1	400:1
7.625:1	25:1	90:1	500:1
8:1	30:1	91:1	520:1
9:1	31.25:1	100:1	1200:1
9.2:1	35:1	115:1	1500:1
9.5:1	38:1	120:1	2000:1
10:1	40:1	128:1	2150:1
12:1	42:1	150:1	2160:1
14:1	48:1	160:1	7760:1

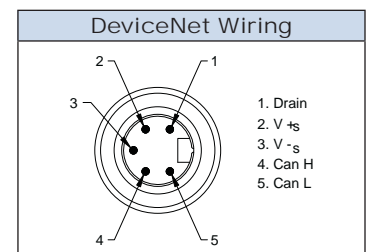

AMCI is a trademark of Advanced Micro Controls Inc. GE is a trademark of the General Electric Company. Modicon is a trademark of the Square D Company. Reliance is a trademark of Rockwell Automation. Namco is a trademark of Namco Controls Corporation. Autotech is a trademark of AVG Automation.



B Series

1986		B	1		X		R		X		
Mounting Configuration and Shaft Size			Single/Multi-Turn			Connection			Options		
B	2.25" square flange mount 3/8" input shaft		X	Single turn resolver. No gear reducer.		R	Standard rear mount connector.		X	None	
Resolver Electrical Output Characteristics			GR_	Single turn resolver with internal gear reducer. Select ratio from list below, insert after GR.		S	Side mount connector.		P	Additional protective shaft seal for high pressure washdown environments.	
			GM_	Single turn resolver with internal gear multiplier. Select ratio from list below, insert after GM.		A_	Rear exit potted pigtail with bare leads. Insert cable length in feet after A.		S	All stainless steel construction including input shaft, bearing housing and can assembly.	
			D1	64 turn dual resolver.		B_	Side exit potted pigtail with bare leads. Insert cable length in feet after B.		E	Stainless steel input shaft and corrosion resistant epoxy coating on all exposed metal.	
			D2	128 turn dual resolver.		C_	Rear exit potted pigtail with standard connector on end of cable. Insert cable length in feet after C.				
			* Lengths may vary with gear reducer		D_	Side exit potted pigtail with standard connector on end of cable. Insert cable length in feet after D.					
1	Standard output compatible with all Gemco electronic modules and Autotech. Resolver No. 04535001										
2	Special output compatible with AMCI resolver input devices. Resolver No. 04535076										
3	Special output compatible with GE axis positioning modules. Resolver No. 04535044										
4	Special output compatible with Modicon motion cards. Resolver No. 04535051										
5	Special output compatible with Reliance resolver input card. Resolver No. 04535023										
6	Special output compatible with Namco resolver input card. Resolver No. 04535053										
DN	DeviceNet output, DeviceNet only offer with rear connector. Resolver No. 04535001										
									Gear Multipliers		
									1:2 1:5 1:9		

Gear Multipliers		
1:2	1:5	1:9

Wiring		
GEMCO and GE Resolvers		
Pin	Rotor	Wire Color
A	R1	Red/White
B	R2	Yellow/White
C	S3	Black
D	S1	Red
E	S2	Yellow
F	S4	Blue
AMCI and Modicon Resolvers		
A	R2	Yellow/White
B	R1	Red/White
E	S4	Blue
C	S2	Yellow
F	S3	Black
G	S1	Red
Namco Resolvers		
A	R1	Red/White
B	R2	Yellow/White
C	S4	Blue
E	S2	Yellow
F	S1	Red
G	S3	Black
Reliance Resolvers		
A	R1	Red/White
B	R2	Yellow/White
F	S3	Black
D	S1	Red
G	S2	Yellow
E	S4	Blue

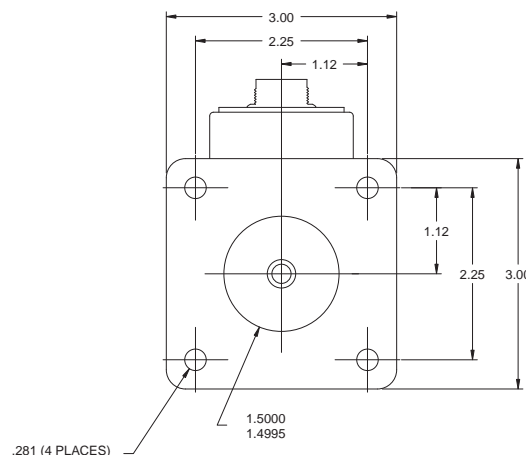
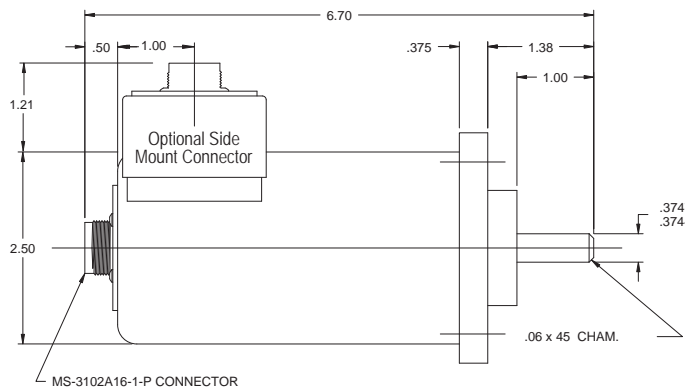

Single Resolver Gear Reducers				
1.5:1	15:1	50:1	180:1	
2:1	16:1	54:1	200:1	
3:1	17:1	58:1	210:1	
4:1	18:1	60:1	225:1	
4.75:1	19:1	64:1	250:1	
5:1	19.5:1	65:1	270:1	
6:1	20:1	70:1	310:1	
6.15:1	21.66:1	73:1	350:1	
7:1	23:1	75:1	360:1	
7.5:1	24:1	80:1	400:1	
7.625:1	25:1	90:1	500:1	
8:1	30:1	91:1	520:1	
9:1	31.25:1	100:1	1200:1	
9.2:1	35:1	115:1	1500:1	
9.5:1	38:1	120:1	2000:1	
10:1	40:1	128:1	2150:1	
12:1	42:1	150:1	2160:1	
14:1	48:1	160:1	7760:1	

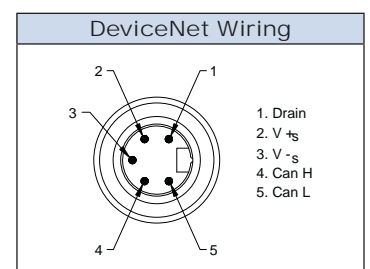



C Series

1986		C	1		X	R		X			
Mounting Configuration and Shaft Size			Single/Multi-Turn			Connection			Options		
C	2.06" square flange mount 3/8" input shaft		X	Single turn resolver. No gear reducer.		R	Standard rear mount connector.			X	None
Resolver Electrical Output Characteristics			GR_	Single turn resolver with internal gear reducer. Select ratio from list below, insert after GR.		S	Side mount connector.			P	Additional protective shaft seal for high pressure washdown environments.
			GM_	Single turn resolver with internal gear multiplier. Select ratio from list below, insert after GM.		A_	Rear exit potted pigtail with bare leads. Insert cable length in feet after A.			S	All stainless steel construction including input shaft, bearing housing and can assembly.
			* Lengths may vary with gear reducer		B_	Side exit potted pigtail with bare leads. Insert cable length in feet after B.			E	Stainless steel input shaft and corrosion resistant epoxy coating on all exposed metal.	
					D1	64 turn dual resolver.		C_	Rear exit potted pigtail with standard connector on end of cable. Insert cable length in feet after C.		
					D2	128 turn dual resolver.		D_	Side exit potted pigtail with standard connector on end of cable. Insert cable length in feet after D.		
			1	Standard output compatible with all Gemco electronic modules and Autotech. Resolver No. 04535001							
2	Special output compatible with AMCI resolver input devices. Resolver No. 04535076										
3	Special output compatible with GE axis positioning modules. Resolver No. 04535044										
4	Special output compatible with Modicon motion cards. Resolver No. 04535051										
5	Special output compatible with Reliance resolver input card. Resolver No. 04535023										
6	Special output compatible with Namco resolver input card. Resolver No. 04535053										

Resolver Electrical Output Characteristics	
1	Standard output compatible with all Gemco electronic modules and Autotech. Resolver No. 04535001
2	Special output compatible with AMCI resolver input devices. Resolver No. 04535076
3	Special output compatible with GE axis positioning modules. Resolver No. 04535044
4	Special output compatible with Modicon motion cards. Resolver No. 04535051
5	Special output compatible with Reliance resolver input card. Resolver No. 04535023
6	Special output compatible with Namco resolver input card. Resolver No. 04535053

Wiring		
GEMCO and GE Resolvers		
Pin	Rotor	Wire Color
A	R1	Red/White
B	R2	Yellow/White
C	S3	Black
D	S1	Red
E	S2	Yellow
F	S4	Blue
AMCI and Modicon Resolvers		
A	R2	Yellow/White
B	R1	Red/White
E	S4	Blue
F	S2	Yellow
F	S3	Black
G	S1	Red
Namco Resolvers		
A	R1	Red/White
B	R2	Yellow/White
C	S4	Blue
E	S2	Yellow
F	S1	Red
G	S3	Black
Reliance Resolvers		
A	R1	Red/White
B	R2	Yellow/White
F	S3	Black
D	S1	Red
G	S2	Yellow
E	S4	Blue

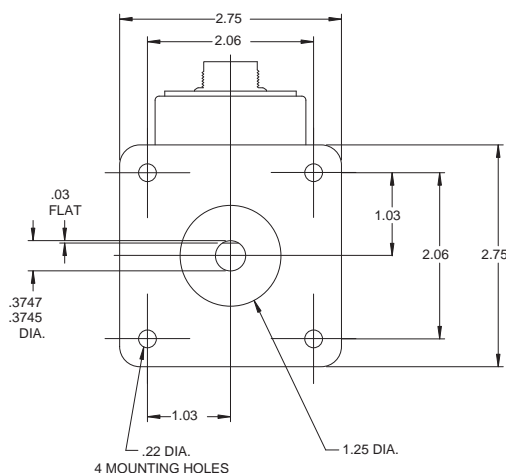
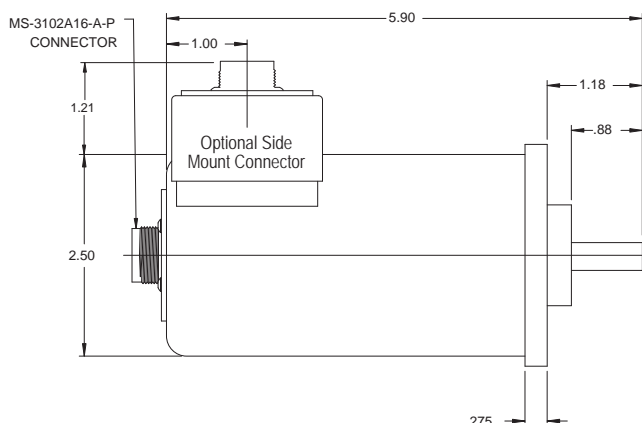

Gear Multipliers		
1:2	1:5	1:9

Single Resolver Gear Reducers			
1.5:1	15:1	50:1	180:1
2:1	16:1	54:1	200:1
3:1	17:1	58:1	210:1
4:1	18:1	60:1	225:1
4.75:1	19:1	64:1	250:1
5:1	19.5:1	65:1	270:1
6:1	20:1	70:1	310:1
6.15:1	21.66:1	73:1	350:1
7:1	23:1	75:1	360:1
7.5:1	24:1	80:1	400:1
7.625:1	25:1	90:1	500:1
8:1	30:1	91:1	520:1
9:1	31.25:1	100:1	1200:1
9.2:1	35:1	115:1	1500:1
9.5:1	38:1	120:1	2000:1
10:1	40:1	128:1	2150:1
12:1	42:1	150:1	2160:1
14:1	48:1	160:1	7760:1



D Series

1986		D	1	X	R	X
Mounting Configuration and Shaft Size						
D	2.50" diameter face mount 5/8" input shaft					
Resolver Electrical Output Characteristics						
1	Standard output compatible with all Gemco electronic modules and Autotech. Resolver No. 04535001					
2	Special output compatible with AMCI resolver input devices. Resolver No. 04535076					
3	Special output compatible with GE axis positioning modules. Resolver No. 04535044					
4	Special output compatible with Modicon motion cards. Resolver No. 04535051					
5	Special output compatible with Reliance resolver input card. Resolver No. 04535023					
6	Special output compatible with Namco resolver input card. Resolver No. 04535053					
		Single/Multi-Turn		Connection		Options
		X	Single turn resolver. No gear reducer.	R	Standard rear mount connector.	X None
		GR_	Single turn resolver with internal gear reducer. Select ratio from list below, insert after GR.	S	Side mount connector.	P Additional protective shaft seal for high pressure washdown environments.
		GM_	Single turn resolver with internal gear multiplier. Select ratio from list below, insert after GM.	A_	Rear exit potted pigtail with bare leads. Insert cable length in feet after A.	E Stainless steel input shaft and corrosion resistant epoxy coating on all exposed metal.
		D1	64 turn dual resolver.	B_	Side exit potted pigtail with bare leads. Insert cable length in feet after B.	
		D2	128 turn dual resolver.	C_	Rear exit potted pigtail with standard connector on end of cable. Insert cable length in feet after C.	
		* Lengths may vary with gear reducer		D_	Side exit potted pigtail with standard connector on end of cable. Insert cable length in feet after D.	

Wiring		
GEMCO and GE Resolvers		
Pin	Rotor	Wire Color
A	R1	Red/White
B	R2	Yellow/White
C	S3	Black
D	S1	Red
E	S2	Yellow
F	S4	Blue
AMCI and Modicon Resolvers		
A	R2	Yellow/White
B	R1	Red/White
E	S4	Blue
C	S2	Yellow
F	S3	Black
G	S1	Red
Namco Resolvers		
A	R1	Red/White
B	R2	Yellow/White
C	S4	Blue
E	S2	Yellow
F	S1	Red
G	S3	Black
Reliance Resolvers		
A	R1	Red/White
B	R2	Yellow/White
F	S3	Black
D	S1	Red
G	S2	Yellow
E	S4	Blue

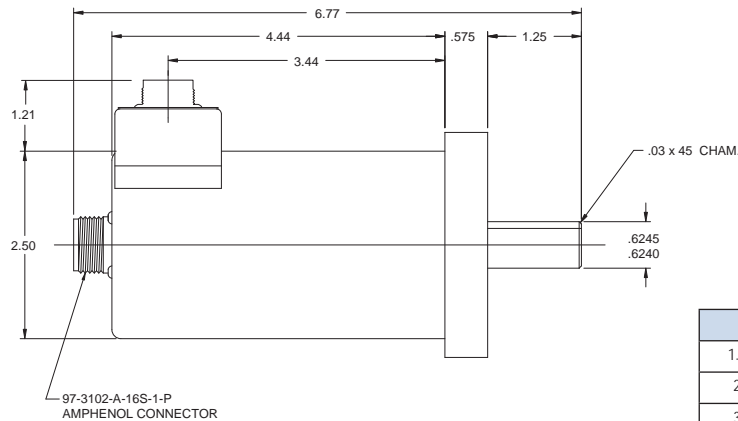

Gear Multipliers		
1:2	1:5	1:9

Single Resolver Gear Reducers			
1.5:1	15:1	50:1	180:1
2:1	16:1	54:1	200:1
3:1	17:1	58:1	210:1
4:1	18:1	60:1	225:1
4.75:1	19:1	64:1	250:1
5:1	19.5:1	65:1	270:1
6:1	20:1	70:1	310:1
6.15:1	21.66:1	73:1	350:1
7:1	23:1	75:1	360:1
7.5:1	24:1	80:1	400:1
7.625:1	25:1	90:1	500:1
8:1	30:1	91:1	520:1
9:1	31.25:1	100:1	1200:1
9.2:1	35:1	115:1	1500:1
9.5:1	38:1	120:1	2000:1
10:1	40:1	128:1	2150:1
12:1	42:1	150:1	2160:1
14:1	48:1	160:1	7760:1

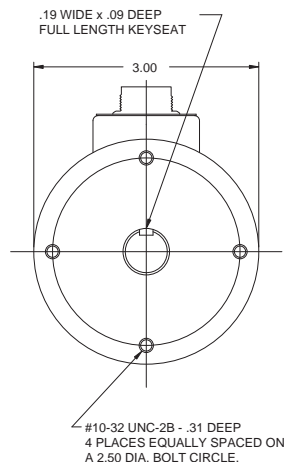

E Series



1986		E	1	X	R	X
Mounting Configuration and Shaft Size		Single/Multi-Turn		Connection		Options
E	100mm face mount 5/8" input shaft	X	Single turn resolver. No gear reducer.	R	Standard rear mount connector.	X None
Resolver Electrical Output Characteristics		GR_	Single turn resolver with internal gear reducer. Select ratio from list below, insert after GR.	P	Additional protec- tive shaft seal for high pressure washdown envi- ronments.	
1	Standard output compatible with all Gemco electronic modules and Autotech. Resolver No. 04535001	GM_	Single turn resolver with internal gear multiplier. Select ratio from list below, insert after GM.	S	All stainless steel construction including input shaft, bearing housing and can assembly.	
2	Special output compatible with AMCI resolver input devices. Resolver No. 04535076	D1	64 turn dual resolver.	E	Stainless steel input shaft and corrosion resistant epoxy coating on all exposed metal.	
3	Special output compatible with GE axis positioning modules. Resolver No. 04535044	D2	128 turn dual resolver.			
4	Special output compatible with Modicon motion cards. Resolver No. 04535051	* Lengths may vary with gear reducer				
5	Special output compatible with Reliance resolver input card. Resolver No. 04535023					
6	Special output compatible with Namco resolver input card. Resolver No. 04535053					

Wiring		
GEMCO and GE Resolvers		
Pin	Rotor	Wire Color
A	R1	Red/White
B	R2	Yellow/White
C	S3	Black
D	S1	Red
E	S2	Yellow
F	S4	Blue
AMCI and Modicon Resolvers		
A	R2	Yellow/White
B	R1	Red/White
C	S2	Yellow
F	S3	Black
G	S1	Red
Namco Resolvers		
A	R1	Red/White
B	R2	Yellow/White
C	S4	Blue
E	S2	Yellow
F	S1	Red
G	S3	Black
Reliance Resolvers		
A	R1	Red/White
B	R2	Yellow/White
F	S3	Black
D	S1	Red
G	S2	Yellow
E	S4	Blue

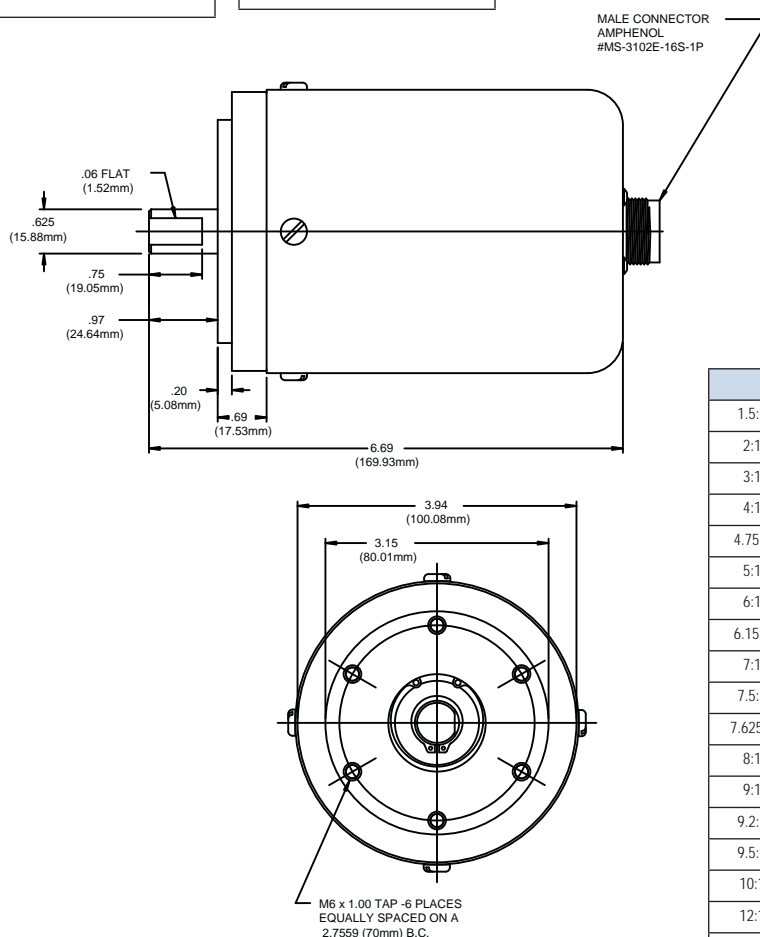

Gear Multipliers		
1:2	1:5	1:9

Single Resolver Gear Reducers			
1.5:1	15:1	50:1	180:1
2:1	16:1	54:1	200:1
3:1	17:1	58:1	210:1
4:1	18:1	60:1	225:1
4.75:1	19:1	64:1	250:1
5:1	19.5:1	65:1	270:1
6:1	20:1	70:1	310:1
6.15:1	21.66:1	73:1	350:1
7:1	23:1	75:1	360:1
7.5:1	24:1	80:1	400:1
7.625:1	25:1	90:1	500:1
8:1	30:1	91:1	520:1
9:1	31.25:1	100:1	1200:1
9.2:1	35:1	115:1	1500:1
9.5:1	38:1	120:1	2000:1
10:1	40:1	128:1	2150:1
12:1	42:1	150:1	2160:1
14:1	48:1	160:1	7760:1



F Series

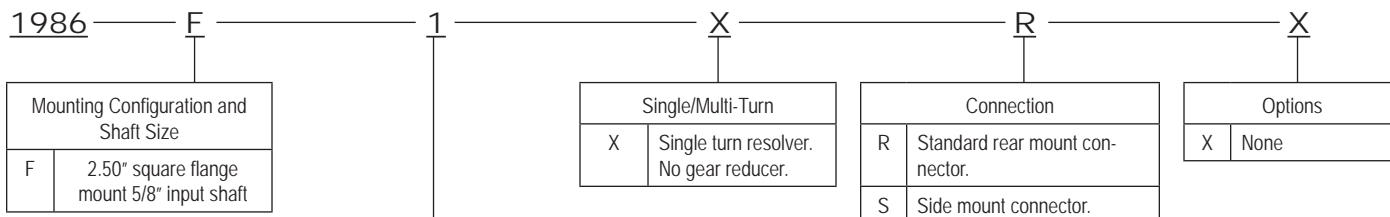

Resolver Electrical Output Characteristics	
1	Standard output compatible with all Gemco electronic modules and Autotech. Resolver No. 04535001
2	Special output compatible with AMCI resolver input devices. Resolver No. 04535076
3	Special output compatible with GE axis positioning modules. Resolver No. 04535044
4	Special output compatible with Modicon motion cards. Resolver No. 04535051
5	Special output compatible with Reliance resolver input card. Resolver No. 04535023
6	Special output compatible with Namco resolver input card. Resolver No. 04535053

Wiring		
GEMCO and GE Resolvers		
Pin	Rotor	Wire Color
A	R1	Red/White
B	R2	Yellow/White
C	S3	Black
D	S1	Red
E	S2	Yellow
F	S4	Blue
AMCI and Modicon Resolvers		
A	R2	Yellow/White
B	R1	Red/White
E	S4	Blue
C	S2	Yellow
F	S3	Black
G	S1	Red
Namco Resolvers		
A	R1	Red/White
B	R2	Yellow/White
C	S4	Blue
E	S2	Yellow
F	S1	Red
G	S3	Black
Reliance Resolvers		
A	R1	Red/White
B	R2	Yellow/White
F	S3	Black
D	S1	Red
G	S2	Yellow
E	S4	Blue

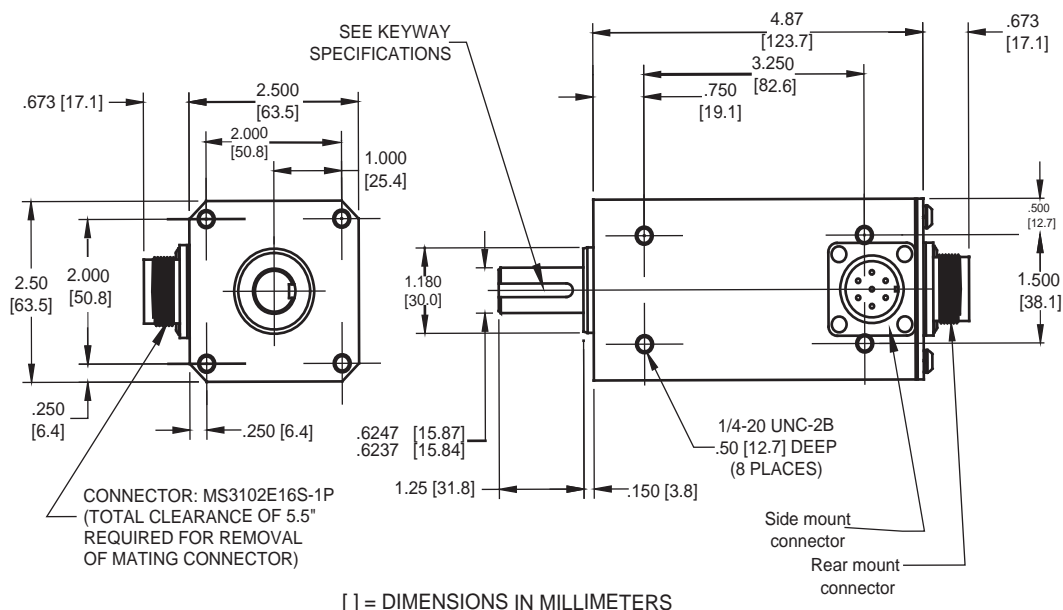



G Series

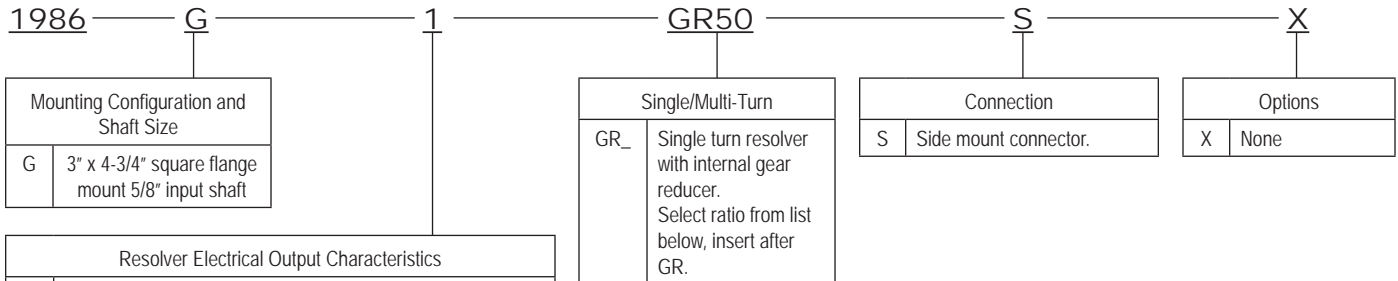

Resolver Electrical Output Characteristics	
1	Standard output compatible with all Gemco electronic modules and Autotech. Resolver No. 04535001
2	Special output compatible with AMCI resolver input devices. Resolver No. 04535076
3	Special output compatible with GE axis positioning modules. Resolver No. 04535044
4	Special output compatible with Modicon motion cards. Resolver No. 04535051
5	Special output compatible with Reliance resolver input card. Resolver No. 04535023
6	Special output compatible with Namco resolver input card. Resolver No. 04535053

Single Resolver Gear Reducers			
2:1	7:1	16:1	64:1
2.5:1	8:1	20:1	100:1
3:1	9:1	24:1	105:1
4:1	10:1	36:1	150:1
4.8:1	12:1	40:1	250:1
5:1	13:1	50:1	256:1
6:1	15:1	60:1	

Wiring		
GEMCO and GE Resolvers		
Pin	Rotor	Wire Color
A	R1	Red/White
B	R2	Yellow/White
C	S3	Black
D	S1	Red
E	S2	Yellow
F	S4	Blue
AMCI and Modicon Resolvers		
A	R2	Yellow/White
B	R1	Red/White
E	S4	Blue
C	S2	Yellow
F	S3	Black
G	S1	Red
Namco Resolvers		
A	R1	Red/White
B	R2	Yellow/White
C	S4	Blue
E	S2	Yellow
F	S1	Red
G	S3	Black
Reliance Resolvers		
A	R1	Red/White
B	R2	Yellow/White
F	S3	Black
D	S1	Red
G	S2	Yellow
E	S4	Blue

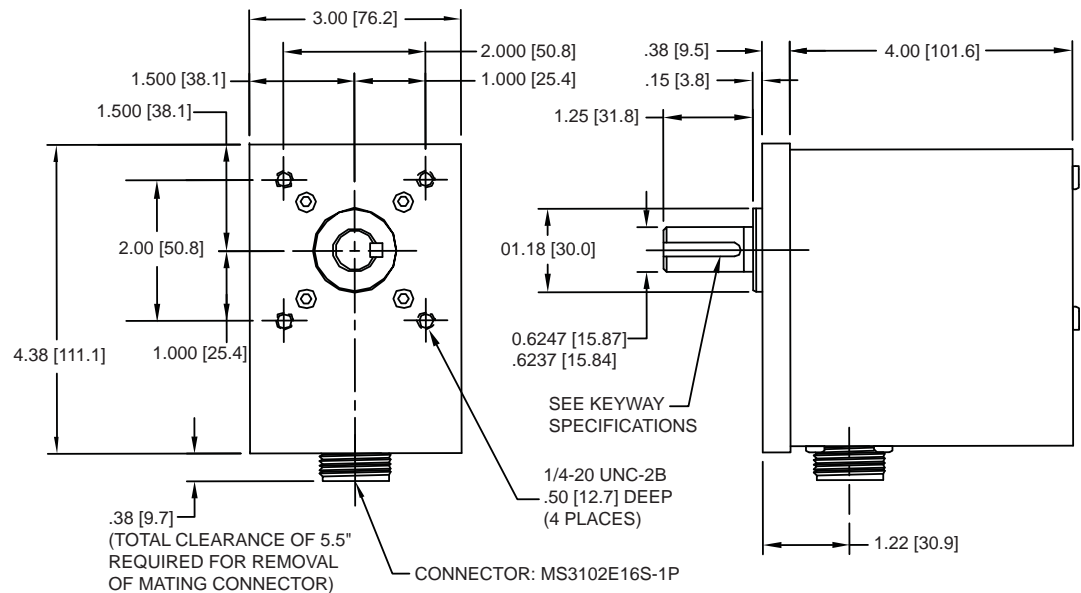

[] = DIMENSIONS IN MILLIMETERS



1986		GG	2		D3		S		X	
Mounting Configuration and Shaft Size			Resolver Electrical Output Characteristics		Single/Multi-Turn		Connection		Options	
GG	3" x 4-3/8" square flange mount 5/8" input shaft		2	Special output compatible with AMCI resolver input devices. Resolver No. 04535076	D3	2 resolvers 100:1 drop-tooth.	S	Side mount connector.	X	None
					D4	2 resolvers 180:1 ratio.				
					D5	2 resolvers 1000:1 ratio.				

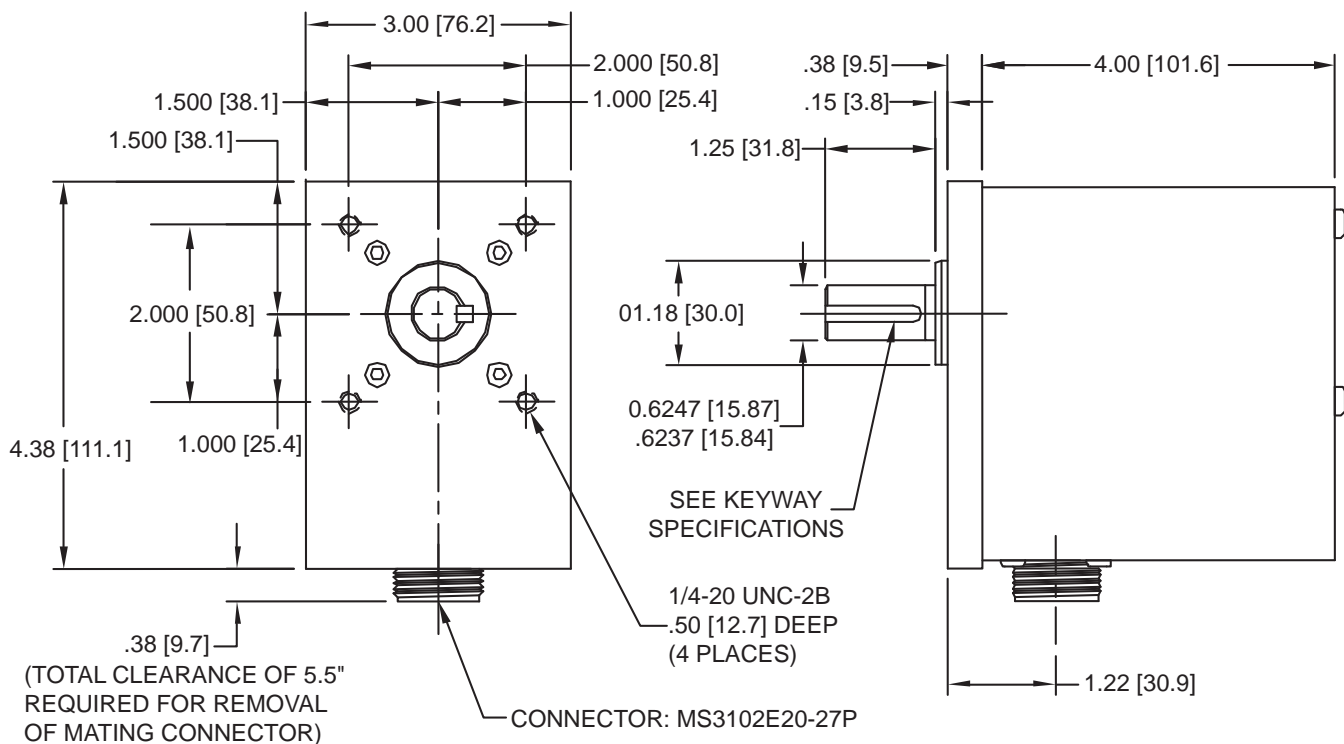

[] = DIMENSIONS IN MILLIMETERS

H Series



Wiring		
Resolver #1 (Fine)		
Pin #	Rotor	Wire Color
A	R1	Red/White
B	R2	Yellow/White
G	S2	Yellow
H	S4	Blue
I	S3	Black
J	S1	Red
Resolver #2 (Coarse)		
A	R1	Red/White
B	R2	Yellow/White
C	S4	Blue
D	S2	Yellow
E	S3	Black
F	S1	Red
AMCI		

1986		H		2		D3		S		X									
Mounting Configuration and Shaft Size				Resolver Electrical Output Characteristics				Single/Multi-Turn		Connection		Options							
H		Servo mount 1/4" input shaft		2		Special output compatible with AMCI resolver input devices. Resolver No. 04535076		D3		2 resolvers 100:1 drop-tooth.		S		Side mount connector.		X		None	

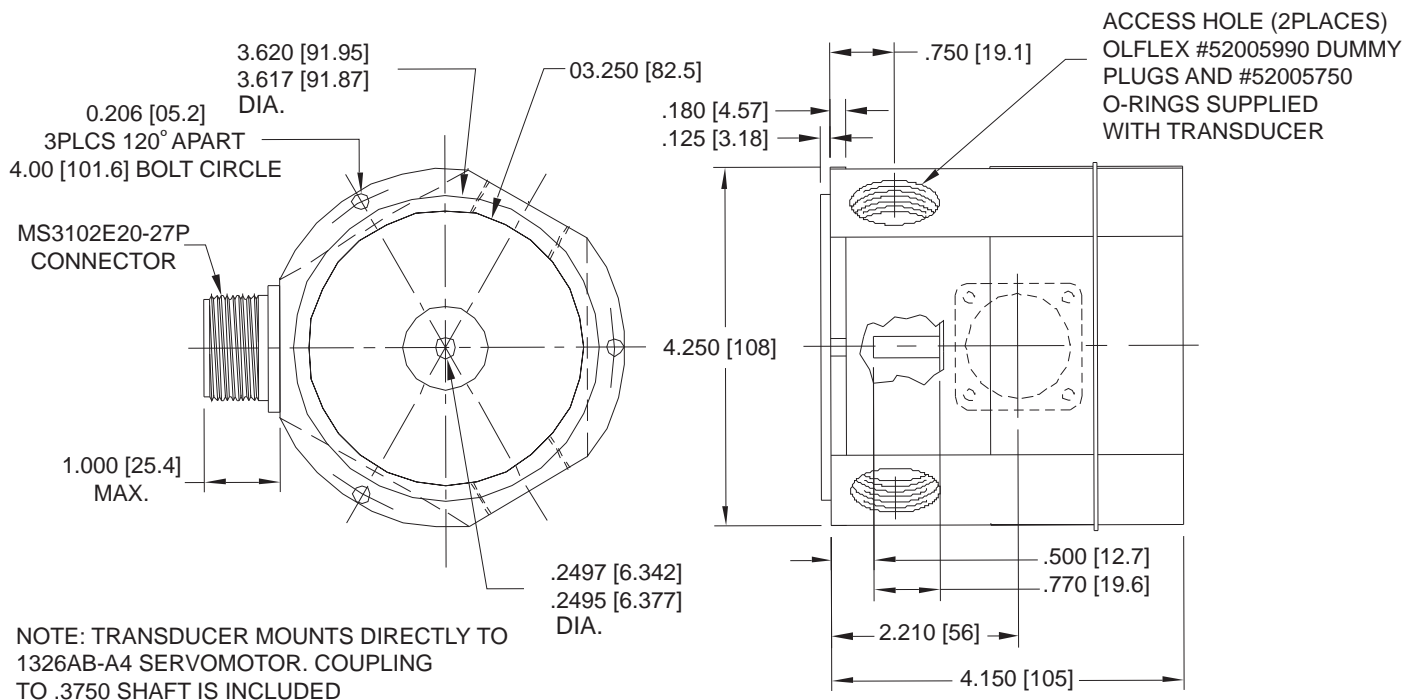

[] = DIMENSIONS IN MILLIMETERS



I Series

1986I		1	X		S	X	
Mounting Configuration and Shaft Size		Resolver Electrical Output Characteristics		Single/Multi-Turn		Options	
I	4.00" round face mount 5/8" input shaft	1	Standard output compatible with all Gemco electronic modules & Autotech. Resolver No. 04535001		X	Single turn resolver. No gear reducer.	
		2	Special output compatible with AMCI resolver input devices. Resolver No. 04535076		GR	Single turn resolver with internal gear reducer 1.5:1 to 520:1.	
					Lengths may vary with gear reducer.		
					Connection		
					S	Side conduit entrance w/ terminal blocks	
					Consult factory for other connector options.		

Single Resolver Gear Reducers							
1.5:1	7.5:1	15:1	24:1*	48:1	75:1	160:1	360:1
2:1	7.625:1	16:1	25:1	50:1	80:1	180:1	400:1
3:1	8:1	17:1	30:1	54:1	90:1	200:1	500:1
4:1	9:1	18:1	31.25:1	58:1	91:1	210:1	520:1
4.75:1	9.2:1	19:1	35:1	60:1	100:1	225:1	
5:1	9.5:1	19.5:1	36:1*	64:1	115:1	250:1	
6:1	10:1	20:1	38:1	65:1	120:1	270:1	
6.15:1	12:1	21.66:1	40:1	70:1	128:1	310:1	
7:1	14:1	23:1	42:1	73:1	150:1	350:1	

[] = DIMENSIONS IN MILLIMETERS

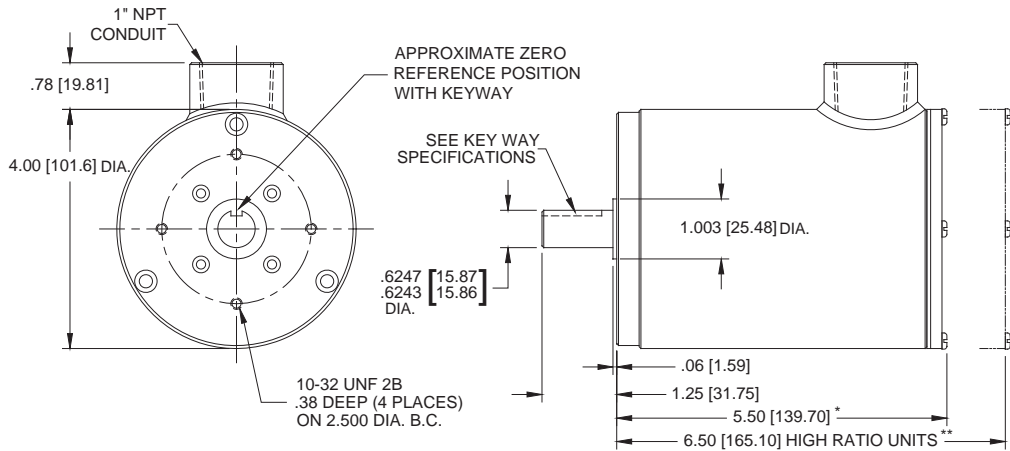

* Single Turn Models. Also 24:1 and 36:1 Ratios.
** Multi Turn Models.

