

# Complete units: Pushbuttons Ø 22MM



## ► MAINTAINED - ILLUMINATED

### Ø 40 MUSHROOM

Push-pull to reset

Black Bezel  
Part Number



L22DM10-3EARM11

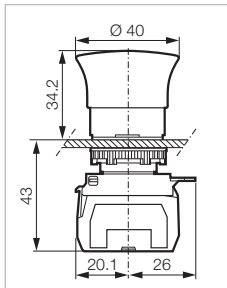

Red LED block

**12/24 Vac/dc**

- Red NC
- Red 2 NC
- Red NO + NC

L22DM10-3EARL01  
L22DM10-3EARL02  
L22DM10-3EARL11

**130 Vac**

- Red NC
- Red 2 NC
- Red NO + NC

L22DM10-3EARM01  
L22DM10-3EARM02  
L22DM10-3EARM11

### Ø 40 MUSHROOM

Push-turn to reset



L22EM10-3EARL02

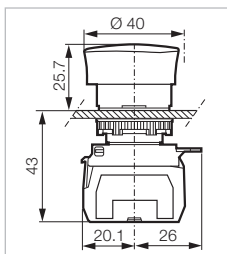

Red LED block

**12/24 Vac/dc**

- Red NC
- Red 2 NC
- Red NO + NC

L22EM10-3EARL01  
L22EM10-3EARL02  
L22EM10-3EARL11

**130 Vac**

- Red NC
- Red 2 NC
- Red NO + NC

L22EM10-3EARM01  
L22EM10-3EARM02  
L22EM10-3EARM11

## ► EMERGENCY STOP MAINTAINED - ILLUMINATED

### Ø 40 EN 418 / ISO 13850

Push-pull to reset



L22DN10-3EARM02

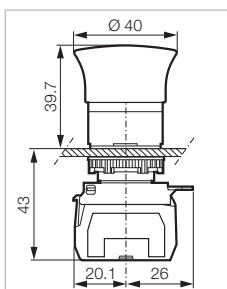

Head position visible from the side with yellow collar  
Compliant with the requirements of emergency stop:  
EN 418 / ISO 13850

Red LED block

**12/24 Vac/dc**

- Red NC
- Red 2 NC
- Red NO + NC

L22DN10-3EARL01  
L22DN10-3EARL02  
L22DN10-3EARL11

**130 Vac**

- Red NC
- Red 2 NC
- Red NO + NC

L22DN10-3EARM01  
L22DN10-3EARM02  
L22DN10-3EARM11