

AR70 and AR111

Low Voltage Halogen Lamps



- Unparalleled beam performance
- Aluminum reflectors
- 3000-hour average rated life
- UV-stop capsule
- Tightly controlled beam with sharp cut-off
- Suitable for use without shielding*

*SYLVANIA does not require lamp containment shielding. Consult most recent UL standards for luminaire requirements.

SYLVANIA AR lamps are outstanding low voltage halogen light sources that produce an unparalleled beam of controlled light. The high precision aluminum reflectors contain a low-pressure halogen light source made with UV-stop quartz. The result of this capsule construction is that the lamps do not require shielding.*

The combination of an axial filament capsule, a computer designed reflector and a cap to eliminate capsule glare creates a lamp with exceptional performance: High center beam candle power values; a smooth, even beam; and a clear, sharp cutoff.

Product Availability

Product	Beam Angle
AR70 (20Watt & 50Watt)	Spot 8°, Flood 25°
AR111 35Watt – 6Volt 35Watt 50Watt 75Watt 100Watt	Super Spot 4° Super Spot 4°, Spot 8°, Flood 25° Super Spot 4°, Spot 8°, Flood 25° Spot 8°, Flood 25°, Wide Flood 45° Spot 8°, Flood 25°, Wide Flood 45°

Application Information

Applications	AR111	AR70
Atriums Retail Artwork and sculpture High-end residential/commercial	<ul style="list-style-type: none">• Exceptional beam control• Fully dimmable• Socket: G53 (push in or screw terminal)• Long distance throws (up to 50,000 CBCP)• Interchangeable with PAR36 in shielded fixtures• For use in downlight, track and accent fixtures	<ul style="list-style-type: none">• Exceptional beam control• Fully dimmable• Socket; BA15D• Smooth, non scattered beam pattern• Small profile• Long distance throws• For use in downlight, track and accent fixtures

Fixture Availability

AR111

Belfer	Kramer	LSI
Capri	Kirlin	Lumiere
CSL	Kurt Versen	Rojey
Flos	Lightolier	Staff
		Translite

AR70

Belfer	Kurt Versen	Staff
Capri	Lightolier	Translite
Cooper	LSI	
Edison Price	Omega	
Kirlin	Rojey	

SEE THE WORLD IN A NEW LIGHT

SYLVANIA



Sample Specification

AR70/AR111

Lamp(s) shall be (a) 12V ____ halogen lamp(s) (AR70,AR111) with a UV-stop capsule, an aluminum reflector and a glare guard (70 or 111-mm diameter). Lamp(s) shall be ____ watts (20, 35, 50, 75 or 100) with a ____ beam spread (4°, 8°, 25° or 45°) or as noted on drawings/schedules. Lamp(s) shall have a ____ Base (BA15D double contact bayonet or G53 push or screw terminal base) and a 3000-hour average rated life.

Lamp Comparison

Item Number	Ordering Abbreviation	Watts	Beam Angle	Average Rated Life (hours)	CBCP (cd)
59017	50AR70/SP8	50	8°	3000	15,000
	Brand X 50ALR18/SP10	50	10°	2000	12,000
	Brand X 50PAR20/HAL//SP10	50	10°	2500	6000
55104	50AR111/SP8	50	8°	3000	23,000
	Brand X 50PAR36/H//NSP8	50	8°	4000	30,000
55129	100AR11/SP8	100	8°	3000	48,000
	Brand X 100PAR/H/SP10	100	10°	2000	17,000

Footcandle

AR70 & AR111 lamps are available in a wide range of beam angles to meet the demand of virtually any display or accent lighting application. For each AR lamp, this table shows how lamp output – in footcandles – varies as a function of distance.

Distance and diameter are measured in feet. Candle power distribution curves are available in IES format at mysylvania.com.

AR70

Distance from Source (in ft.)	8° Spot			25° Flood		
	Diameter (in ft.)	Center FC		Diameter (in ft.)	Center FC	
0'		20W	50W		20W	50W
10'	1.6	77	125	4.7	9	26
20'	3.0	19	31	9.1	2.3	6.5
30'	4.4	9	14	13.5	1.0	2.9
40'	5.8	5	8	18	0.6	1.6
50'	7.2	3	5	22.4	0.4	1.0
60'	8.6	2	3	26.8	0.3	0.7

AR111

Distance from Source (in ft.)	Diameter (in ft.)	4° Super Spot			Diameter (in ft.)	8° Spot			
		35W/6v	35W/12v	50W		35W	50W	75W	100W
0'									
10'	1.1	300	450	500	1.8	140	200	300	480
20'	1.8	75	113	125	3.2	35	50	75	120
30'	2.5	33	50	56	4.6	16	22	33	53
40'	3.2	19	28	31	6.0	9	13	19	30
50'	3.9	12	18	20	7.4	6	8	12	19
60'	4.6	8	13	14	8.8	4	6	8	13

Distance from Source (in ft.)	Diameter (in ft.)	25° Flood				Diameter (in ft.)	45° Wide Flood	
		35W	50W	75W	100W		75W	100W
0'								
10'	4.8	25	35	53.0	85.0	8.6	17.0	28.0
20'	9.2	6.3	8.8	13.3	21.3	16.9	4.3	7.0
30'	13.7	2.8	3.9	5.9	9.4	25.2	1.9	3.1
40'	18.1	1.6	2.2	3.3	5.3	33.5	1.1	1.8
50'	22.5	1.0	1.4	2.1	3.4	41.8	0.7	1.1
60'	27	0.7	1.0	1.5	2.4	50.1	0.5	0.8

Dimensions

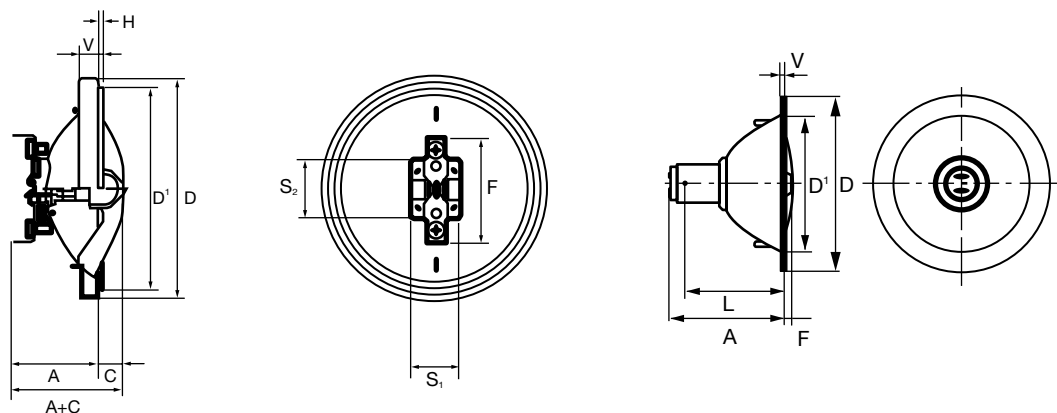

	AR111	mm	inch		AR70	mm	inch
Overall length	A + C	60	2.36		A + F	48.5	1.91
Projection of grip cap	C	15±0.5	0.59+0.02		F	3.0 max.	0.12 max.
Length w/o grip cap	A	45±0.4	1.77+0.02		A	45.5 +1	1.79 +0.04
					L	41.0 max.	1.61
Reflector diameter	D	111-0.2	4.37-0.01		D	70.0 ± 0.2	2.75± 0.08
	D ₁	102.5 ±0.3	4.04+0.01		D ₁	59.76	23.53
Thickness of refl. edge	V	9.5+0.5	0.37+0.02		V	1.2	0.05
	H	2.5-0.7	0.98-0.03				
Dim. of ceramic holder	S ₁ xS ₂	25 x 32	9.84 x 1.26				
Distance of contact strips	F	53.2 ± 1	2.09+0.04				

Ordering and Specification Information

Item Number	Ordering Abbreviation	Watts	Volts	Base	Average Rated Life (hrs.)	CBCP (cd)	Beam Angle
59013	20AR70/SP8	20	12	BA15D	3000	7700	8°
59012	20AR70/FL25	20	12	BA15D	3000	900	25°
59017	50AR70/SP8	50	12	BA15D	3000	12,500	8°
59016	50AR70/FL25	50	12	BA15D	3000	2600	25°
55101	35AR111/SSP4/6V	35	6	G53	3000	30,000	4°
55102	35AR111/SSP4	35	12	G53	3000	45,000	4°
55110	35AR111/SP8	35	12	G53	3000	14,000	8°
55114	35AR111/FL25	35	12	G53	3000	2500	25°
55105	50AR111/SSP4	50	12	G53	3000	50,000	4°
55104	50AR111/SP8	50	12	G53	3000	20,000	8°
55103	50AR111/FL25	50	12	G53	3000	3500	25°
55125	75AR111/SP8	75	12	G53	3000	30,000	8°
55123	75AR111/FL25	75	12	G53	3000	5300	25°
55124	75AR111/WFL45	75	12	G53	3000	1700	45°
55129	100AR111/SP8	100	12	G53	3000	48,000	8°
55127	100AR111/FL25	100	12	G53	3000	8500	25°
55128	100AR111/WFL45	100	12	G53	3000	2800	45°

Ordering Guide

20	AR	70	/	SP	10
Wattage	Aluminum Reflector	Diameter		Beam Spread	Beam Angle
20, 35, 50		70 = 70mm		SSP = Super Spot	4° 8°
75, 100		111 = 111mm		SP = Spot	25° 45°
				FL = Flood	
				WFL = Wide Flood	