

Specifications

For other materials or modifications, please consult TESCOm.

OPERATING PARAMETERS

Pressure rating per criteria of ANSI/ASME B31.3

Maximum Inlet Pressure

500, 3000 psig / 34.5, 207 bar

Outlet Pressure Ranges

0-25, 0-50, 0-100, 0-150, 0-200 psig
0-1.7, 0-3.4, 0-6.9, 0-10.3, 0-13.8 bar

Design Proof Pressure

150% of rated pressure

Leakage

Internal: Bubble-tight

External: $< 2 \times 10^{-8}$ atm cc/sec He

Operating Temperature

-40°F to 140°F / -40°C to 60°C

Flow Capacity

$C_v = 1.0$

$C_v = 1.8$ (Optional)

MEDIA CONTACT MATERIALS

Body

Brass, 316 Stainless Steel

Bonnet

300 Series Stainless Steel

Diaphragm

316 Stainless Steel

Seat

3000 psig / 207 bar Inlet: PCTFE

500 psig / 34.5 bar Inlet: PTFE

Seat Retainer

Nitronic 60

Seal

PTFE

Remaining Parts

316 Stainless Steel

OTHER

Cleaning

CGA 4.1 and ASTM G93

Weight (without gauges)

3.5 lbs / 1.6 kg

Teflon® is a registered trademark of E.I du Pont de Nemours and Company.



TESCOM 44-3200 Series is a compact, high flow, high purity single-stage regulator for specialty, flammable and industrial gas flows of 5-50 SCFM / 141-1415 SLPM. Diffusion-resistant metal diaphragm seal ensures gas purity and integrity.

Applications

- Laboratory and point-of-use gas systems
- Laser assist and resonator gases
- Glove box and isolators

Features and Benefits

- Available in 316 Stainless Steel or Brass
- Choice of inlet pressure ratings: 500 or 3000 psig / 34.5 or 207 bar maximum
- True metal-to-metal diaphragm seal to minimize diffusion
- Five outlet pressure ranges are available
- Gauge ports are standard
- Optional high flow model ($C_v = 1.8$) is available
- Panel mounting is optional
- Non-venting is standard
- Flanged end connections available

44-3200 SERIES

44-3200 Series Regulator Drawing

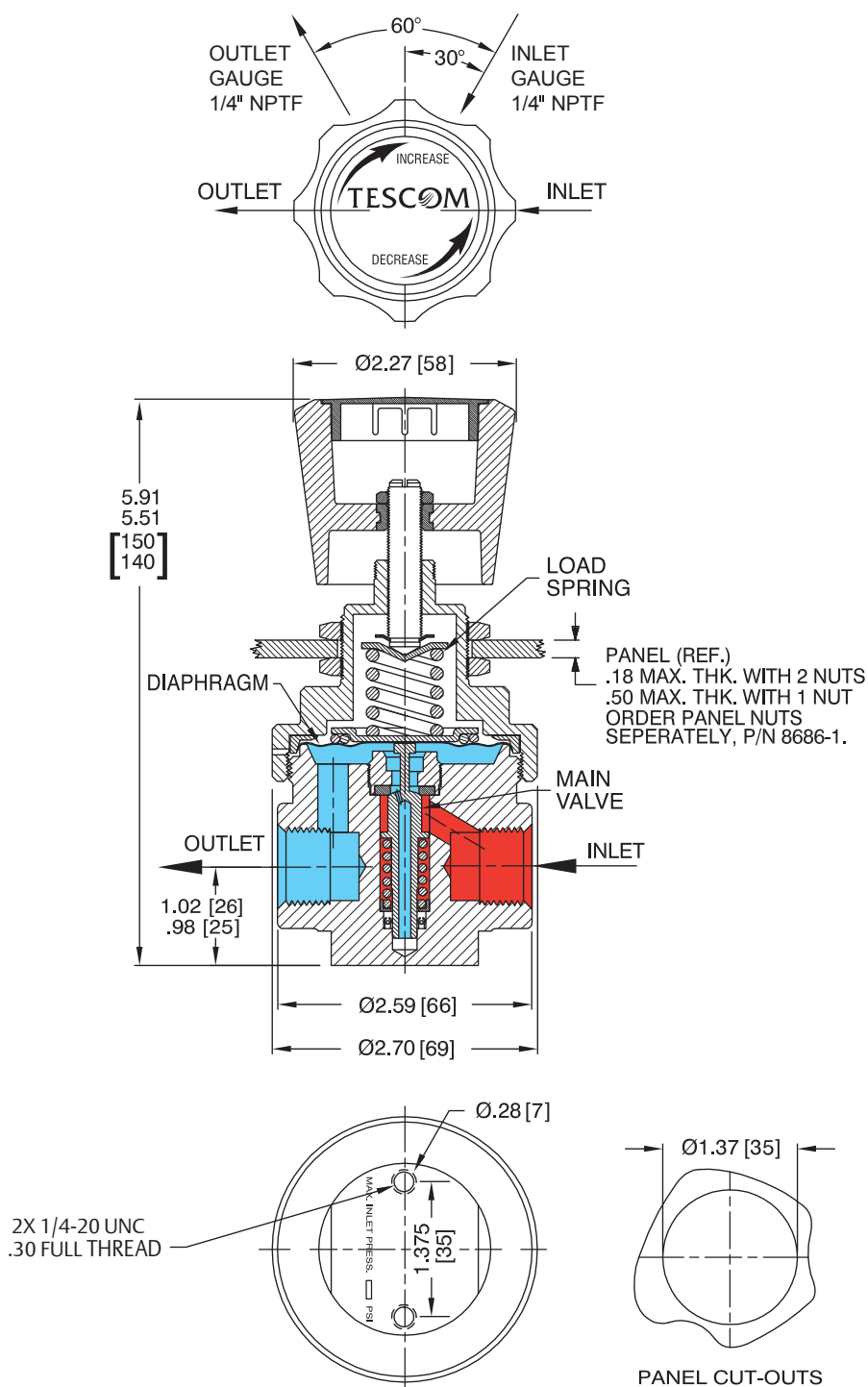

All dimensions are reference and nominal
Metric [millimeter] equivalents are in brackets

44-3200 Series Regulator with Flanges Drawing

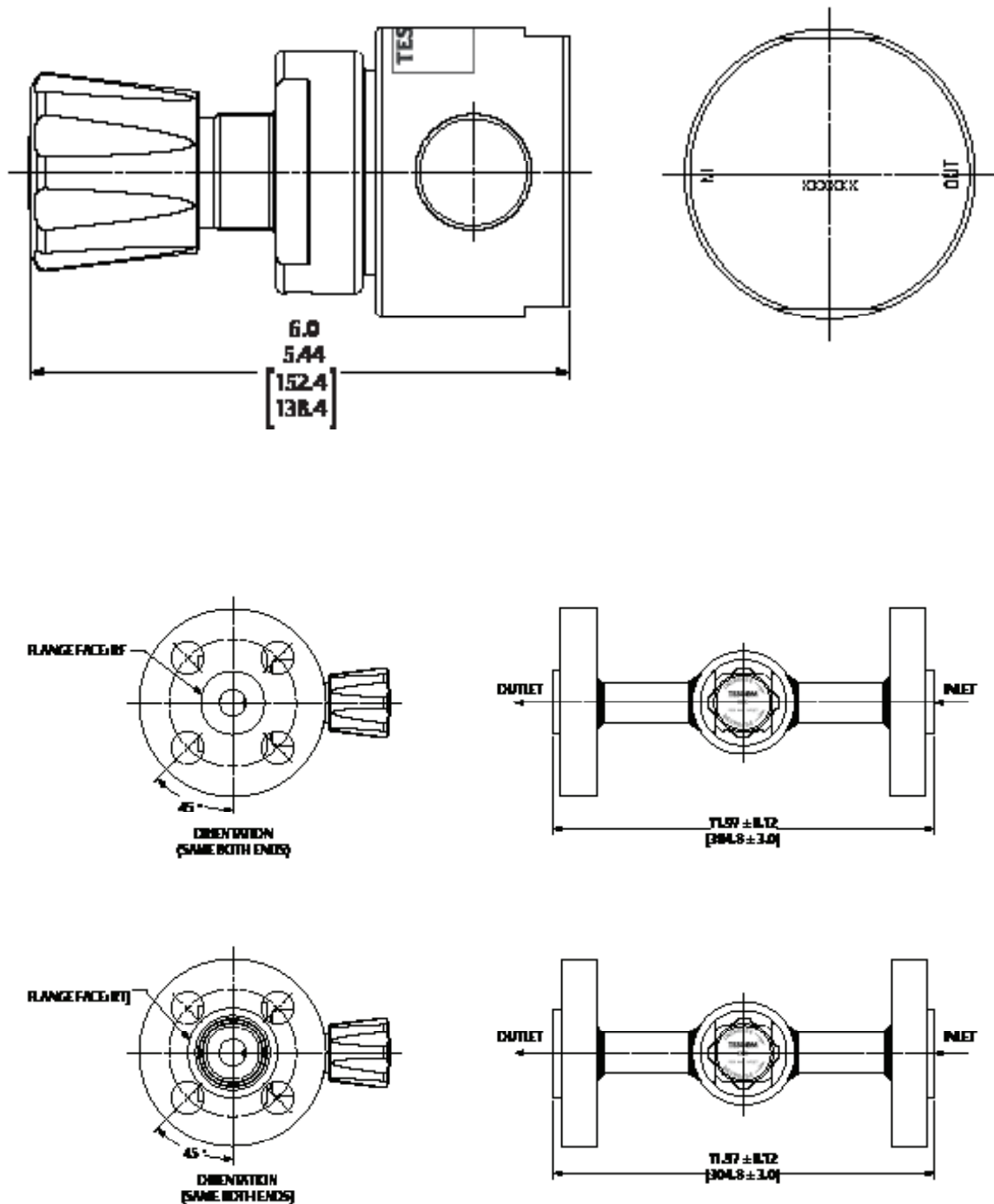

All dimensions are reference and nominal
Metric [millimeter] equivalents are in brackets

44-3200 SERIES

44-3200 Series Regulator Flow Charts

For more information on how to read flow curves, please refer to the Flow Curves and Calculations document (debul2007x012) in the

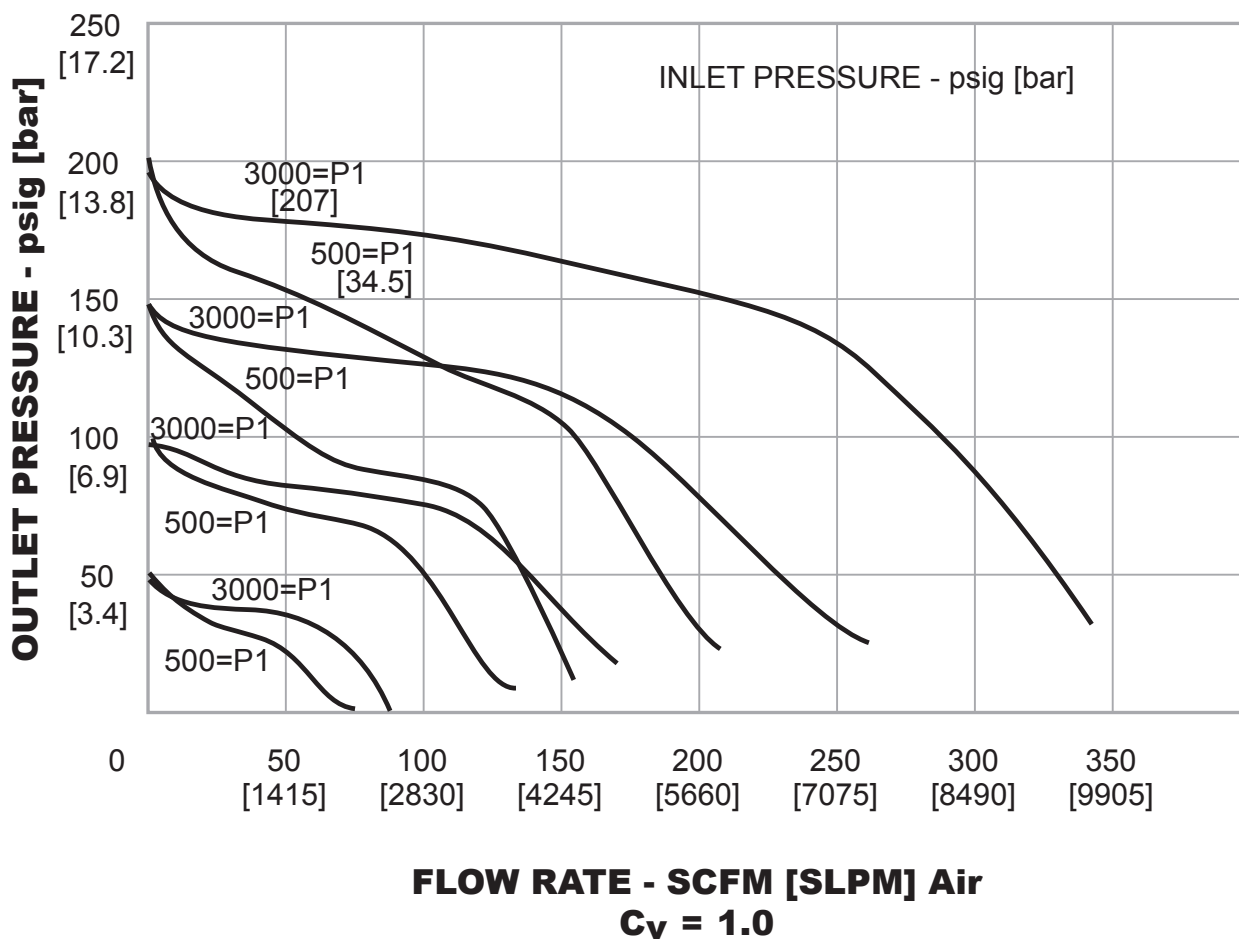

44-3200 Series Regulator Flow Charts

For more information on how to read flow curves, please refer to the Flow Curves and Calculations document (debul2007x012) in the

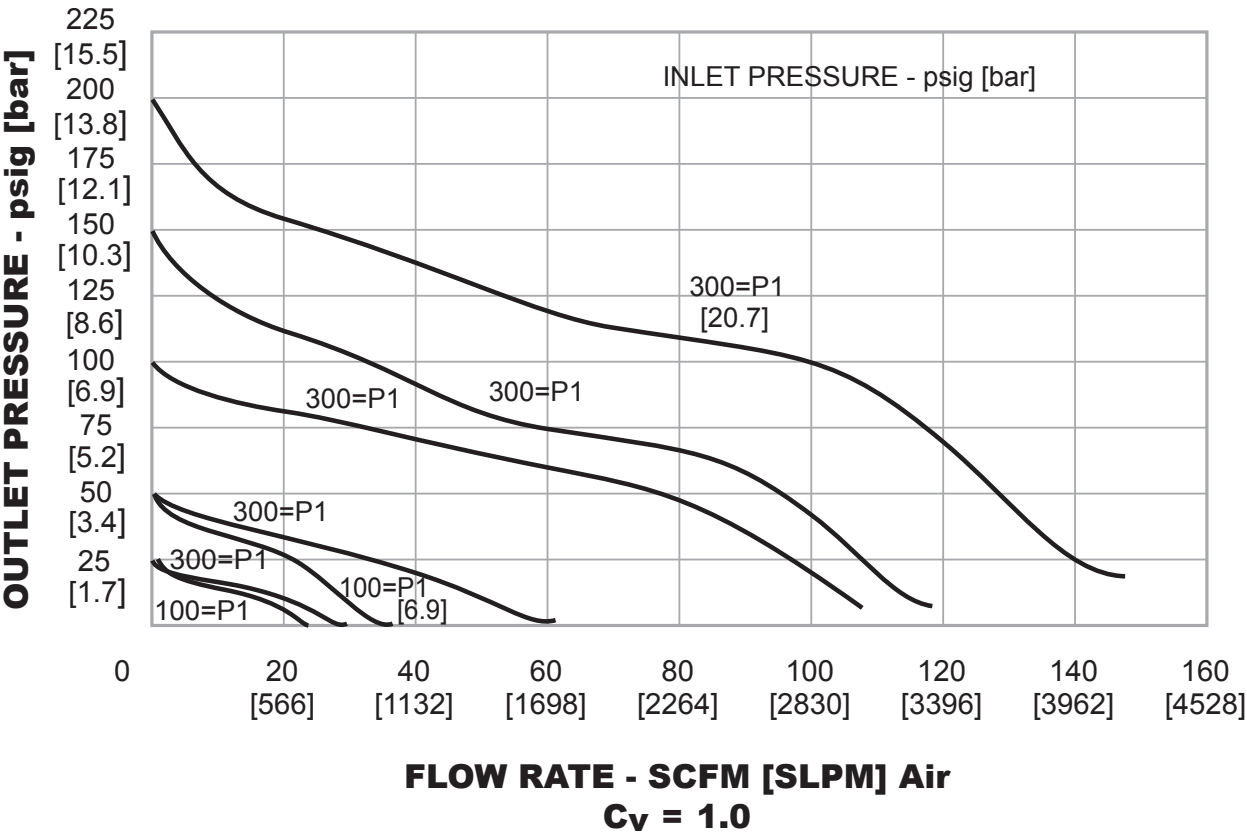

44-3200 SERIES

44-3200 Series Regulator Part Number Selector





Learn more about common options.

For modifications, repair kits and accessories, contact factory.

Threaded End Connection Part Number Selection

44-32	6	1	J		2	8	1	
BASIC SERIES	BODY MATERIAL	OUTLET PRESSURE RANGES	SOFT GOODS		INLET AND OUTLET PORT TYPE	INLET AND OUTLET PORT SIZE	MAXIMUM INLET PRESSURE	OPTIONS
			SEAT	SEAL				
44-32	1 – Brass 6 – 316 Stainless Steel	0 – 0-25 psig 0-1.7 bar 1 – 0-50 psig 0-3.4 bar 2 – 0-100 psig 0-6.9 bar 3 – 0-150 psig 0-10.3 bar 4 – 0-200 psig 0-13.8 bar	H – PTFE J – PCTFE	PTFE, O-ring PTFE, Spring Energized Lip Seal	2 – NPTF	6 – 3/8" 8 – 1/2"	1 – 3000 psig 207 bar 3 – 500 psig 34.5 bar	-001 – One 1/4" gauge port at 90°, C _V = 1.0 -003 – No gauge ports -296 – One 1/4" gauge port at 90°, C _V = 1.8

Flanged End Connector Part Number Selection:

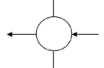
44-32W	6	2	1					B	1	52	1	
BASIC SERIES	BODY, PIPE & FLANGE MATERIAL	OUTLET PRESSURE RANGES	DASH NO	FLOW CAPACITY	SEAT	SEAL	OPERATING TEMPERATURE	GAUGE PORT OPTIONS	FLANGE SIZE	FLANGE CLASS	FLANGE FACE	
44-32W	6 – 316 SST	0 – 0-25 psig 0-1.7 bar	1	1.0	PCTFE	PTFE	-20 to 140°F -29 to 60°C	A – R.H. Inlet, no gauge port		1 – 1/2" 3 – 1"	11 – 150# 21 – 300# 41 – 600#	1 – RF 2 – RTJ
		1 – 0-50 psig 0-3.4 bar	2	1.0	PTFE	PTFE	-20 to 165°F -29 to 74°C	B – R.H. Inlet, in & out gauge port at 60°		52 – 900# / 1500#		
		2 – 0-100 psig 0-6.9 bar					J – R.H. Inlet, 2 outlet gauge port at 90°		63 – 2500#			
		3 – 0-150 psig 0-10.3 bar										
		4 – 0-200 psig 0-13.8 bar										