



G2 SERIES INTRINSICALLY SAFE

A full line of **FLOMEC® G2 Series Turbine Meters** are available in a variety of housing materials. Rugged and dependable, the G2 Series offers:

- Stainless Steel for most water and chemical products
- Aluminum for fuels and petroleum-based products
- PVDF for aggressive chemicals

FEATURES / BENEFITS

- Meter is designed for thin fluids < 100 cP
- Modular design allows for use with Output Modules, Sensors and Remote Display Kits
- 2 Totals (Batch Total = Resettable, Total = Non-Resettable); Rate of Flow, Factory calibrated in gallons or litres. Field calibratable. Includes non-volatile totals.
- High accuracy meter
- Internal parts are simple to replace for easy maintenance
- AAA Alkaline battery life: 2 years

PRODUCT CONFIGURATION

1 PRODUCT IDENTIFIER:

G2 = Industrial Grade Flowmeters

2 TURBINE MATERIAL:

S = Stainless Steel
A = Aluminum
P = PVDF (1/2 in. & 1 in. only)
X = Electronics only (For metal meters)
Z = Electronics only (For plastic meters)

3 TURBINE SIZE:

05 = 1/2 in. **15** = 1-1/2 in.
07 = 3/4 in. **20** = 2 in.
10 = 1 in.

4 FITTING TYPE:

N = NPT (Female)
I = ISO (Female) BSPT (ISO 7 Designation is RC)
F = 150# ANSI Flange (Available on S10, S15 & S20 only)
T = Tri-Clover® Fitting (Available on S05, S07, S10, S15 & S20 only)
X = No Turbine Body

5 ELECTRONIC CHOICE:

Computer Display, Meter Mounted
Q9 = Q9 2-Button Computer
Q1 = Q9 2-Button Computer, Vertical Mount (90° Adapter)
Retrofit Computer Kit (Display Only)
R9 = Q9 2-Button Computer Retrofit Kit (Replaces Q9 Display)
No Electronics - Turbine Only
XX = No Electronics - Turbine Only

6 CALIBRATION OF COMPUTER / DISPLAY:

GM = Gallons Per Minute (Gallons Default)
LM = Liters Per Minute (Litres Default)
XX = No Calibration

7 PACKAGING:

A = 05 Thru 10 Turbines, Turbine Only or w/Q9 Electronics
 05 Thru 20 Electronics Only (Q9 Replacement Kit or R9 Retrofit Kit)
B = 15 & 20 Turbines, Turbine Only or w/Q9 Electronics
 05 Thru 10 Turbines w/Q1 Electronics
C = 15 Thru 20 Turbine w/Q1 Electronics
D = 10 Turbines with ANSI Flange Turbine Only or w/Q9, Q1 Electronics
E = 15 & 20 Turbines with ANSI Flange Turbine Only or w/Q9, Q1 Electronics

APPLICATIONS

- Fuel products
- Monitoring clean fluids
- Plant process water
- Chemical feed lines
- Harsh chemicals (sulfuric acid and bleach)
- Batching
- Blending
- Water
- Industrial fluids
- Plating solutions
- Ammonium
- Food and beverage processing

1 2 3 4 5 6 7
 ---->>>> G2 S 15 N Q9 GM B



SPECIFICATIONS

| | | | | | |
|--------------------------|--|--------------|--------------------|------------------|--|
| Fitting Type: | NPT or ISO (Female) BSPT* (*ISO 7 designation is RC) | | | | |
| | 150# ANSI (Stainless Steel only) | | | | |
| | Tri-Clover® (Stainless Steel only) - Clamp size is one size bigger than meter size | | | | |
| Housing Material: | 316 Stainless Steel, Aluminum, PVDF | | | | |
| Meter Sizes Available: | 1/2" 3/4" 1" 1-1/2" 2" | | | | |
| Flow Range: | 1/2" (05) | 1 - 10 GPM | | (3.8 - 38 L/min) | |
| | 1/2" (05) PVDF only | 1.2 - 12 GPM | | (4.5 - 45 L/min) | |
| | 3/4" (07) | 2 - 20 GPM | | (7.6 - 76 L/min) | |
| | 1" (10) | 5 - 50 GPM | | (19 - 190 L/min) | |
| | 1-1/2" (15) | 10 - 100 GPM | | (38 - 380 L/min) | |
| | 2" (20) | 20 - 200 GPM | | (76 - 760 L/min) | |
| Accuracy (% of Reading): | Turbine Only | | Turbine w/Computer | | |
| | 1/2" (05) | ± 2.0% | | ± 1.5% | |
| | 3/4" (07) | ± 1.5% | | ± 1.0% | |
| | 1" (10) | ± 1.5% | | ± 1.0% | |
| | 1-1/2" (15) | ± 1.0% | | ± 0.75% | |
| | 2" (20) | ± 1.0% | | ± 0.75% | |
| Repeatability: | ± 0.1% (PVDF is ± 0.3%) | | | | |
| Pressure Rating: | | | | | |
| Stainless Steel 316 SS | 1,500 psi (102 bar) | | | | |
| Aluminum | 300 psi (21 bar) | | | | |
| ANSI Flange 316 SS | Flange Rule | | | | |
| Sanitary Flange 316 SS | Limited by fitting, clamp size, & temperature | | | | |
| PVDF | 100 psi (6.9 bar) | | | | |

| | | |
|---|-------------------|--|
| Operating Temperature Range: | | -40° F to 250° F (-40° C to 121° C) |
| | | (PVDF) -20° F to 180° F (-28° C to 82° C) |
| with Intrinsically Safe Display: | | 0° F to +129° F (-18° C to +54° C) |
| Typical K-Factor: | 1/2" (05) | 2,500 PPG (660 Pulses/L) |
| | 3/4" (07) | 1,100 PPG (291 Pulses/L) |
| | 1" (10) | 565 PPG (149 Pulses/L) |
| | 1-1/2" (15) | 215 PPG (57 Pulses/L) |
| | 2" (20) | 100 PPG (26 Pulses/L) |
| Wetted Materials: | Housing: | 316 Stainless Steel or Aluminum |
| | Bearings: | 96% Alumina Oxide Ceramic |
| | Shaft: | Tungsten Carbide |
| | Rotor: | PVDF |
| | Rings: | 316 Stainless Steel |
| Wetted Materials PVDF: | Housing: | PVDF (15% Carbon Fiber Filled) |
| | Bearings & Shaft: | 98% Alumina Ceramic |
| | Rotor: | PVDF |
| | Rings: | Fluorocarbon (Optional PTFE) |
| | | |
| Frequency Range: | 1/2" (05) | 42-420 Hz @ 1-10 GPM (3.8-38 L/min) / 45-450 Hz @ 1.2-12 GPM (4.5-45 L/min) (PVDF) |
| | 3/4" (07) | 37-370 Hz @ 2-20 GPM (7.6-76 L/min) |
| | 1" (10) | 47-470 Hz @ 5-50 GPM (19-190 L/min) / 45-475 Hz @ 5-50 GPM (19-190 L/min) (PVDF) |
| | 1-1/2" (15) | 36-360 Hz @ 10-100 GPM (38-380 L/min) |
| | 2" (20) | 33-330 Hz @ 20-200 GPM (76-760 L/min) |
| Calibration Report: | | Comes standard with G2 Series meters. N.I.S.T. - Certification available. |

DIMENSIONS

NOTE: Q9 Display adds 0.72 in. (18 mm) to height

Stainless Steel Models

| | S05, 1/2 in. | S07, 3/4 in. | S10, 1 in. | S15, 1 1/2 in. | S20, 2 in. |
|-------------------|-----------------------|-----------------------|-----------------------|-----------------------|-----------------------|
| A = Height | 1.4 in. (35.6 mm) | 1.6 in. (40.6 mm) | 1.9 in. (48.3 mm) | 2.6 in. (66.0 mm) | 3.1 in. (78.7 mm) |
| B = Width | 2.0 in. (50.8 mm) | 2.0 in. (50.8 mm) | 2.0 in. (50.8 mm) | 2.7 in. (68.6 mm) | 3.4 in. (86.4 mm) |
| C = Length | 4.2 in. (106.7 mm) | 4.3 in. (109.2 mm) | 4.5 in. (114.3 mm) | 5.3 in. (134.6 mm) | 6.3 in. (160.0 mm) |

Aluminum Models

| | A05, 1/2 in. | A07, 3/4 in. | A10, 1 in. | A15, 1 1/2 in. | A20, 2 in. |
|-------------------|-----------------------|-----------------------|-----------------------|-----------------------|-----------------------|
| A = Height | 1.8 in. (45.7 mm) | 2.0 in. (50.8 mm) | 2.2 in. (55.9 mm) | 2.8 in. (71.1 mm) | 3.2 in. (81.3 mm) |
| B = Width | 2.0 in. (50.8 mm) | 2.0 in. (50.8 mm) | 2.0 in. (50.8 mm) | 2.7 in. (68.6 mm) | 3.3 in. (83.8 mm) |
| C = Length | 4.2 in. (106.7 mm) | 4.3 in. (109.2 mm) | 4.5 in. (114.3 mm) | 5.3 in. (134.6 mm) | 6.3 in. (160.0 mm) |

PVDF Models

| | P05, 1/2 in. | P10, 1 in. |
|-------------------|-----------------------|-----------------------|
| A = Height | 3.2 in. (81.3 mm) | 3.3 in. (83.8 mm) |
| B = Width | 2.1 in. (53.3 mm) | 2.8 in. (71.1 mm) |
| C = Length | 7.3 in. (185.4 mm) | 8.1 in. (205.7 mm) |

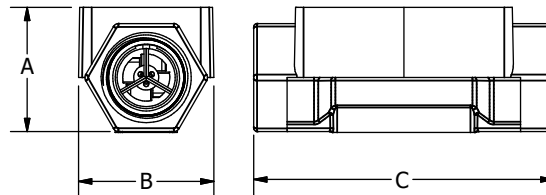

NOTE: For representation purpose only. Actual product models vary in shape, design, etc.

ANSI Flange and Sanitary Flange dimensions not shown. For those dimensions, please refer to product manuals or our website FLOMECMeters.com.

ACCESSORIES

| Part No. | Description | Part No. | Description |
|-----------|-------------------------|-----------|--|
| 120077-01 | FM Approved Sensor | 113275-10 | FM Approved Remote Kit |
| 120077-02 | ATEX Approved Sensor | 125206-2 | 1/2 in. Teflon O-Ring for PVDF Meter (2) |
| 125260-02 | 90° Display Adaptor Kit | 125206-1 | 1 in. Teflon O-Ring for PVDF Meter (2) |

APPROVALS

