

DATA SHEET

WorldWide Electric Corporation



Premium Efficiency Motor: **NAT34-18-56CB**

60 Hz

Document Generated: 27-Feb-2023

Document ID:

Customer:

MOTOR INFORMATION

HP	3/4
RPM	1800
Phase	3
Frequency	60 Hz
Voltage	230/460
Frame Size	56C
Enclosure	TEFC
Degree of Protection	IP43
Service Factor	1.15
Poles	4
Full Load Speed	1725
Insulation Class	F
Temp Rise	80°C
NEMA Code Letter	L
Duty Cycle	S1 / Continuous
Slip	0.04%
NEMA Design	B
Moment of Inertia	0.0485 lb.ft.^2
Sound Pressure Level	68 dB(A)
Max Ambient Temperature	40°C
Max Elevation	1000 m.a.s.l (3300 f.a.s.l)
Mounting	F1
Base	C-Face Removable Base
Rotation	Bi-Directional
Standard	NEMA MG-1
Approvals	CSA, CE

EFFICIENCY/POWER FACTOR

LOAD	EFF	P. F.
100%	74.8 %	76.2
75%	74.7 %	67.1
50%	71.6 %	53.4

TORQUE

FULL LOAD	LRT	BDT
2.25 lb.ft.	240 %	315 %

AMPERAGE INFORMATION

	230V	460V
Full Load Amps	2.6	2.96
Locked Rotor Amps	13.16	6.58
No Load Current	1.6	0.8
Usable at 208V	--	

BEARING INFORMATION

DE Bearing	6203 2RS
ODE Bearing	6203 2RS

ADDITIONAL DATA

F2 Suitable	No
Shaft Material	1045 Carbon Steel
Connection Diagram	230 / 460 V - 9 Lead Y
Approximate Weight	21.5 lbs.

MOTOR DRAWING

WorldWide Electric Corporation



Premium Efficiency Motor: **NAT34-18-56CB**

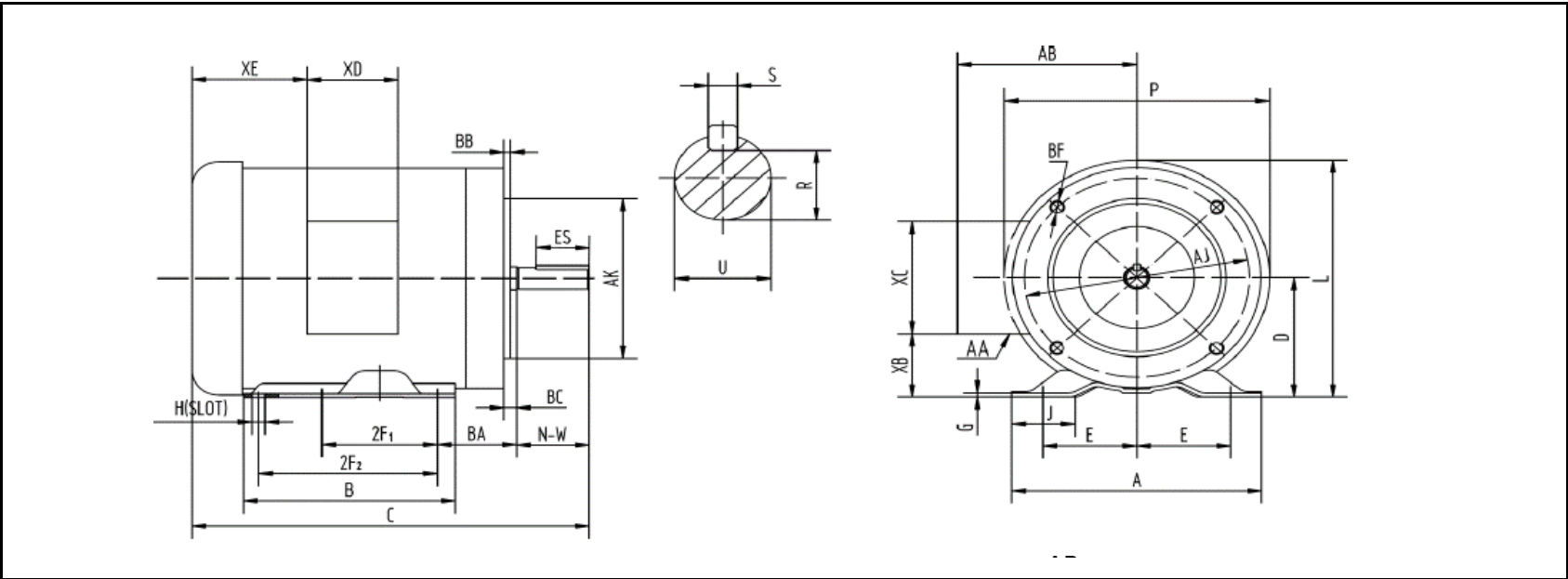

DIMENSION - INCHES

MOUNTING					A	B	C	D	G	J	L	P	AB
E	2F1	2F2	H	BA									
2.44	3	5	0.34	2.75	6.54	6.54	11.9	3.5	0.1	1.65	7.4	7.3	5.2

SHAFT & KEY				
S	ES	R	N-W	U
0.188	1.41	0.517	1.88	0.625

TERMINAL BOX				
AA	XB	XC	XD	XE
3-0.88/2-1.109	1.65	3.7	3.2	2.15

FLANGE				
AK	AJ	BF	BB	BC
4.5	5.875	3/8-16	0.16	-0.19

PERFORMANCE CURVES

WorldWide Electric Corporation



Premium Efficiency Motor:

NAT34-18-56CB

Document Generated: 27-Feb-2023
Document ID:

Customer:

Motor Type					
Output Rating (HP)	3/4		FL Speed	1725	
Full Load Torque	2.25 lb.ft		LRT (%FLT)	240	460 volt FLA 2.96
Rotor Wk^2	0.0485 lb-ft^2		BDT (%FLT)	315	230 volt FLA 2.6

SPEED VS TORQUE & CURRENT CURVE

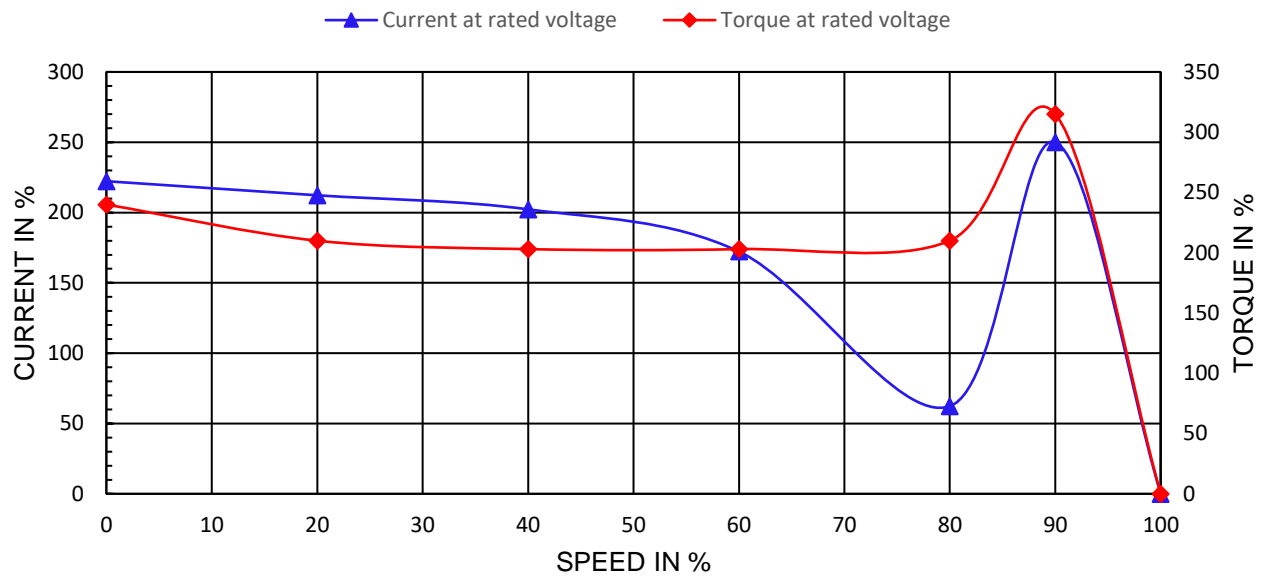

OUTPUT VS EFF., P.F. & CURRENT CURVE

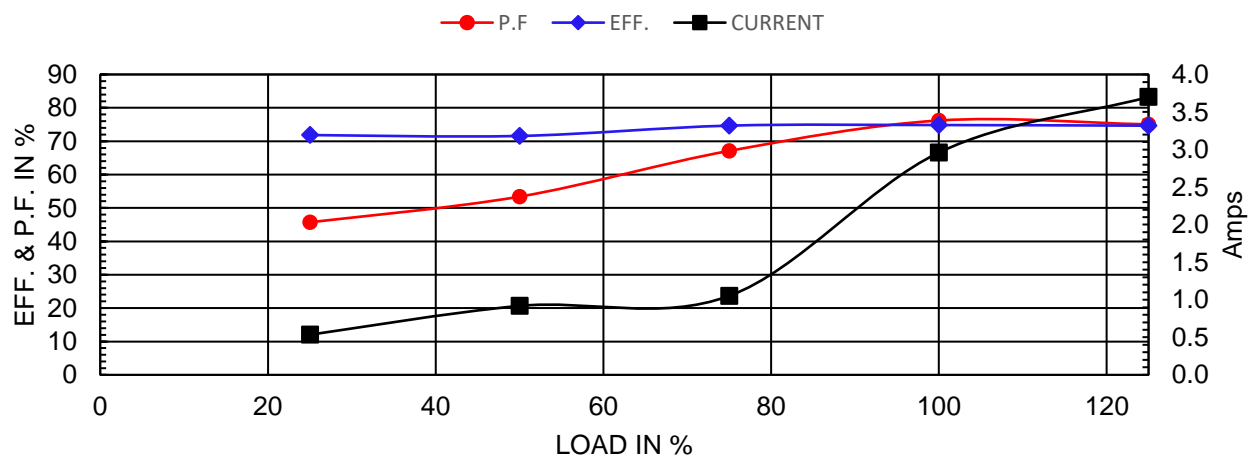

NAMEPLATE / WIRING

WorldWide Electric Corporation



Premium Efficiency Motor: **NAT34-18-56CB**

Document Generated: 27-Feb-2023
Document ID:

Customer:

SAMPLE NAMEPLATE DATA

WORLDWIDE Electric Corp		THREE PHASE INDUCTION MOTOR		C US Energy Verified 256950		CE	
MODEL	FRAME			LOW VOLTAGE		HIGH VOLTAGE	
Hz	ENCL. TEFC			BLUE (T1) — LINE1		BLUE (T1) — LINE1	
HP	PH 3			BROWN (T7) — LINE1		WHITE (T2) — LINE2	
RPM	DUTY CONT			WHITE (T2) — LINE2		ORANGE (T3) — LINE3	
VOLTS	CODE			RED (T8) — LINE2		YELLOW (T4) — INS	
AMPS	INS. F			ORANGE (T3) — LINE3		BROWN (T7) — INS	
	DES.			YEL/BLA (T9) — LINE3		BLACK (T5) — INS	
S. F.	LB/WT			YELLOW (T4) — INS		RED (T8) — INS	
				BLACK (T5) — INS		GRAY (T6) — INS	
				GRAY (T6) — INS		YEL/BLA (T9) — INS	
NOM. EFF (60Hz)	DE/ODE BRG.			ACCEPTABLE FOR FIELD WIRING			
MAX. AMB. 40°C	Date Code XX/XXXXX			THERMALLY PROTECTED : NONE			
SERIAL NO. XXXXXXXXXX		WorldWide Electric Corporation					

MADE IN CHINA

Model	NAT34-18-56CB	Frame	56C
Hz	60 Hz 50Hz	Encl	TEFC
HP	3/4 1/2	PH	3
RPM	1725 1425	DUTY	CONT
Voltage	230/460 190/380	Code	L
Amps	6.15/2.96 2.2/1.1	Ins Cl	F
IP	IP43	Design	B
S.F.	1.15 1.00	LB/WT	21.5 lbs.
Nom.Eff.	74.8%	DE Brng	6203 2RS
		ODE Brng	6203 2RS