

# CODE 790 FAMILY

## 183 mm (7,2") DIAMETER

## 1800 W BLOWER



Brushless blower from these series have 183mm diameter and are the most powerful in our product range. They are reaching power up to 1.8 kW and there are two options with 63.5mm (2.5") and 50mm (2" outlet) available. These blowers are designed for applications where relatively high pressure and high flow are needed. These blowers are available up to 1800W. We also have solutions with special sealing which protects bearing available. Such solutions are intended for use of blowers in pressure applications. Special sealing solution is available up on request.

Very important feature of these blowers is also 3-phase supply (400 VAC). Additional features of these blowers are also 3-phase commutation, precise regulation and high efficiency.

### Possible applications:

- fume/smoke extraction,
- medical Laser fume extraction,
- collators,
- cutting tables / vacuum tables,
- paper handling,
- packaging equipment,
- hopper loader,
- industrial vacuum cleaner,
- central vacuum cleaner,
- etc.



There are plenty of options for each blower available (some are up on request):

- top cooling air inlet with tube
- working air inlet with tube
- speed control 0-10VDC or PWM
- top cooling air inlet
- working air inlet
- without speed control
- speed output

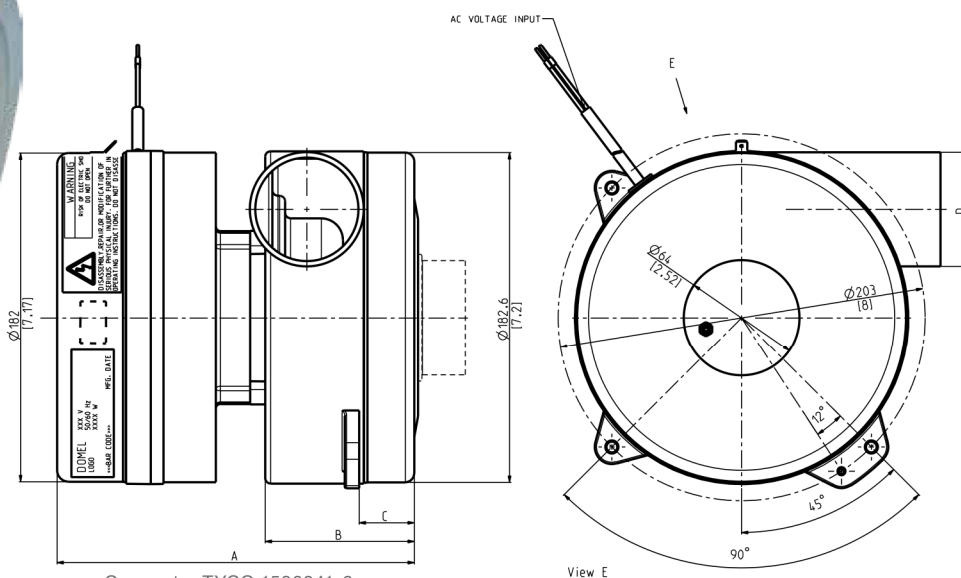

Connector TYCO 1586041-6

PIN	
1	High
4	Low
2	High
5	Low
3	High
6	Low
7	L1
8	L2
9	L3
10	PE

\* Upon customer request isolated voltage supply for regulation purpose only is available

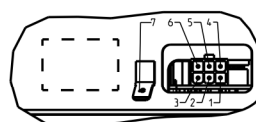

mm  
[in]

Dimensional and performance data are subject to change without notice.

Selection and ordering information for 120VAC/60Hz, 230VAC/50Hz and 3~400V/50Hz - TANGENTIAL DISCHARGE																
Code	P / E	Stage	A		B		C		D		P1	U	Sealed Vacuum		Max. air flow	
	Curve	X	[mm]	[in]	[mm]	[in]	[mm]	[in]	[mm]	[in]	[W]	[V]	[kPa]	[inH <sub>2</sub> O]	[l/s]	[CFM]
790.3.210-xxx	1E	1	198	7,80	82,5	3,25	30,5	1,20	50	1,97	1800	various	16,9	67,9	119	252,1
790.3.220-xxx	2E	2	229	9,02	113,5	4,47	61,5	2,42	50	1,97	1800	various	22,8	91,6	99	209,8
790.3.310-xxx	1P	1	198	7,80	82,5	3,25	30,5	1,20	63,5	2,50	1800	various	16,4	65,9	125	264,9
790.3.320-xxx	2P	2	229	9,02	113,5	4,47	61,5	2,42	63,5	2,50	1800	various	22,4	90,0	105,0	222,5

Data above represent the performance of an average motor sample. Individual data may vary due to normal manufacturing variations.

# TANGENTIAL DISCHARGE

## 120VAC, 230VAC or 3~400V / 50-60 Hz

1800W, Outlet dia.  $\varnothing$  50mm (2")

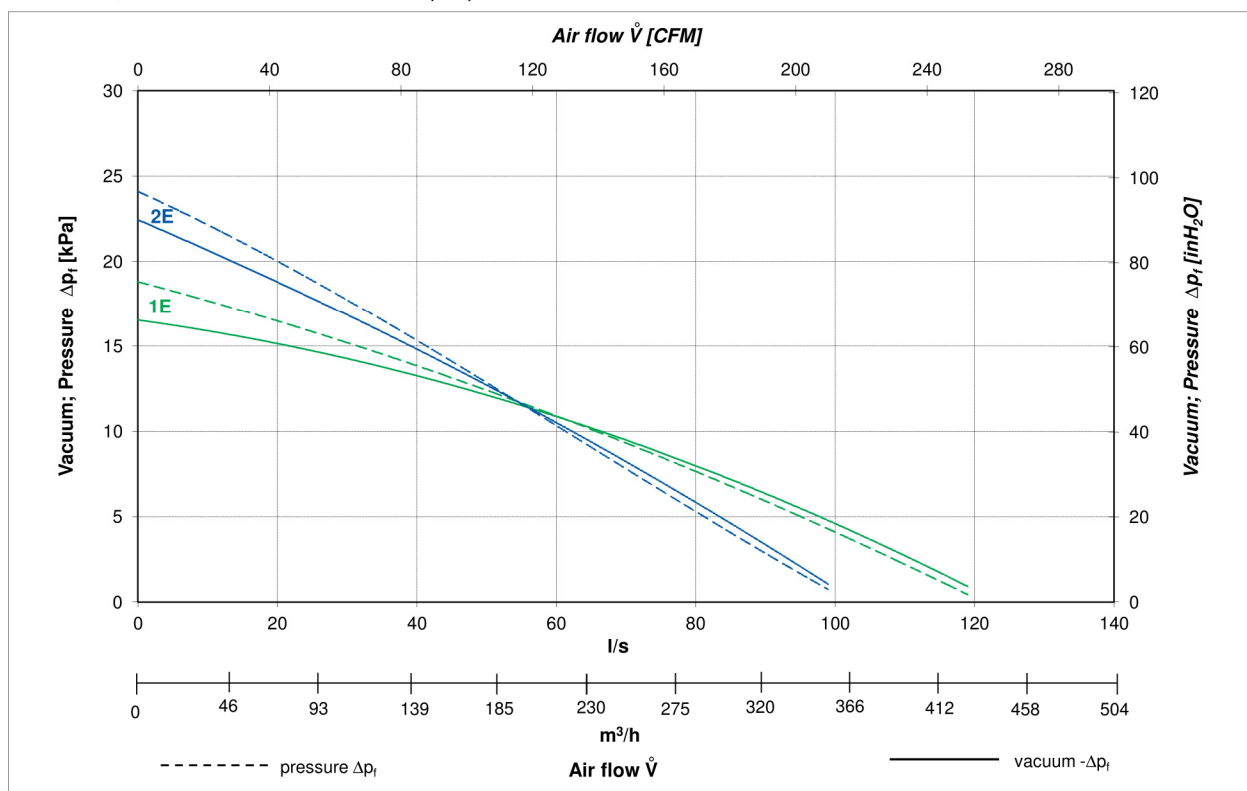

Note: This blower is also available for supply 120VAC, 3~460V or as per your request.

1800W, Outlet dia.  $\varnothing$  63,5mm (2,5")

