



Models R6125-2, R6325A-2, R6135J-10, R6335A-2, R6335B, R6150J-2, R6350A-2, R6350B-2

Maximum pressure, vacuum, and air flow varies for the r6 series, depending on the model(s). Reference the chart for the specific model performance.

PRODUCT FEATURES

- Made in the U.S.A.
- Rugged construction, low maintenance
- Oilless operation
- UL and CSA approved TEFC motors with permanently sealed ball bearings (R6150J-2 and R6135J-10 has ODP motor)
- Automatic restart thermal protection on R6150J-2, R6125-2, R6335A-2, R6325A-2
- Aluminum cover, impeller, and housing
- Inlet and outlet have internal muffling

RECOMMENDED ACCESSORIES

- Pressure gauge AE133
- Inlet filter AJ126F (pressure)
- Vacuum gauge AE134
- Inline filter AJ151G (vacuum)
- Muffler AJ121F
- Relief valve AG258
- Liquid separator RMS300 (vacuum)
- Foam replacement kit K904

MODELS	Maximum Pressure (inH ₂ O)		Maximum Vacuum (inH ₂ O)		Maximum Air Flow (CFM)	
	60 Hz	50 Hz	60 Hz	50 Hz	60 Hz	50 Hz
R6125-2 R6325A-2	45	40	55	50	215	180
R6135J-10 R6335A-2 R6335B	80	75	80	65	215	180
R6150J-2 R6350A-2 R6350B-2	105	78	88	70	207	180

Product Dimensions (inches, mm)

Note: Unit must be mounted horizontally, foot pad down

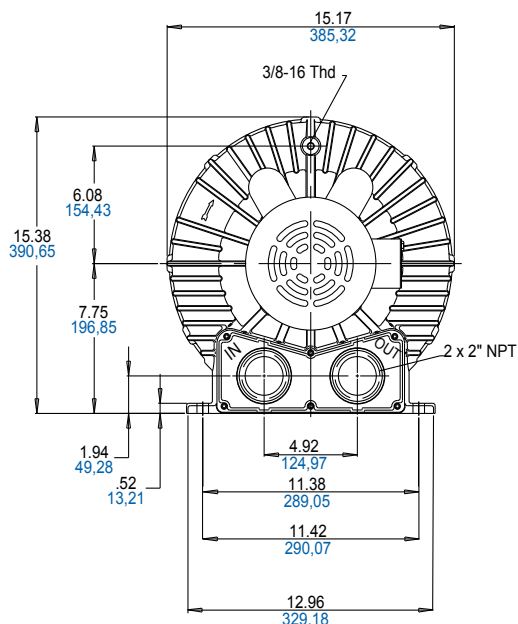
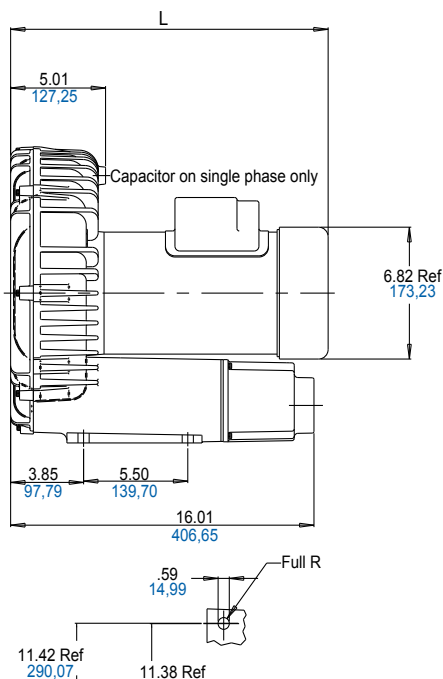

MODEL	L (in)	L (mm)
R6125-2	16.45	418
R6325A-2	15.53	394
R6135J-10	15.86	403
R6335A-2	16.59	421
R6335B	16.00	406
R6150J-2	17.46	443
R6350A-2	17.35	441
R6350B-2		

Product Specifications

MODEL NUMBER		R6125-2	R6325A-2	R6135J-10	R6335A-2
Motor Enclosure		TEFC	TEFC	ODP	TEFC
HP/kW	60 Hz	2.5/1,9	2.5/1,9	3.5/2,6	3.5/2,6
	50 Hz	1.5/1,1	1.85/1,38	-	2.5/1,9
Voltage	60 Hz	115/208-230-1	208-230/460-3	230-1	208-230/460-3
	50 Hz	110/220-240-1	190-220/380-415-3	-	190-220/380-415-3
Amps	60 Hz	22/12.5-11	6.9-6.9/3.45	19	9.7-8.8/4.4
	50 Hz	18/9.5	6.6-6.7/3.3-3.5	-	8.8/4-3.9
Starting Amps	60 Hz	58 @ 230V	58 @ 230V	125 @ 230V	50 @ 460V
	50 Hz	42 @ 240V	23.5 @ 380V	-	40.5 @ 380V
Insulation Class		F	B	F	F
Recommended NEMA Starter Size		1/0	0/00	1P	1/0
Net Weight (lbs/kg)		87/39,5	76/34,5	112/50,8	82/37,2

MODEL NUMBER		R6335B	R6150J-2	R6350A-2	R6350B-2
Motor Enclosure		TEFC	ODP	TEFC	TEFC
HP/kW	60 Hz	3.5/2,6	5.0/3,7	5.0/3,7	5.0/3,7
	50 Hz	-	-	4.8/3,6	-
Voltage	60 Hz	575-3	230-1	208-230/460-3	575-3
	50 Hz	-	-	190-220/380-415-3	-
Amps	60 Hz	3.6	22.3	13.0-12.0/6.0	4.8
	50 Hz	-	-	14.4-13.4/7.2-6.8	-
Starting Amps	60 Hz	34.9 @ 575V	96 @ 230V	125 @ 230V	35 @ 575V
	50 Hz	-	-	57 @ 380V	-
Insulation Class		F	F	F	F
Recommended NEMA Starter Size		0	1P	1/0	0
Net Weight (lbs/kg)		82/37,2	125/56,8	112/50,8	112/50,8

Product Performance

Models R6125-2, R6325A-2

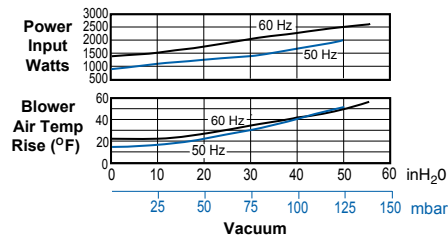
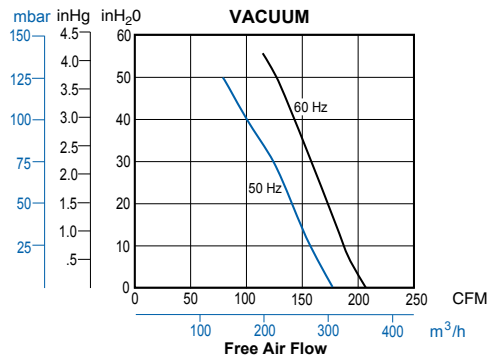
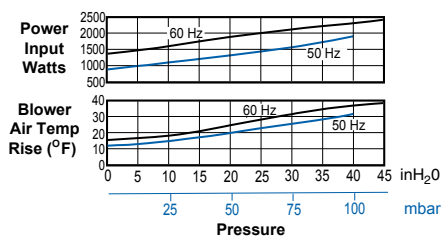
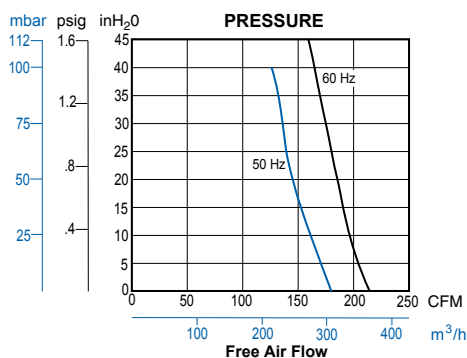

Product Performance

Models R6135J-10, R6335A-2, R6335B

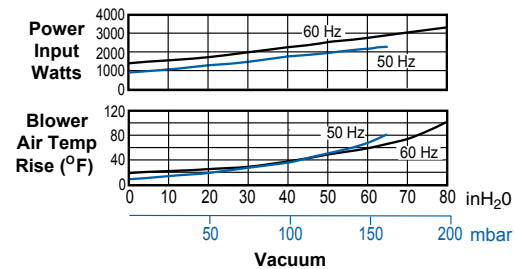
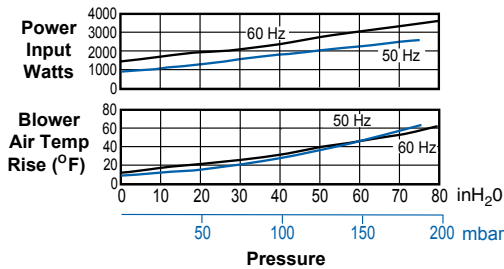
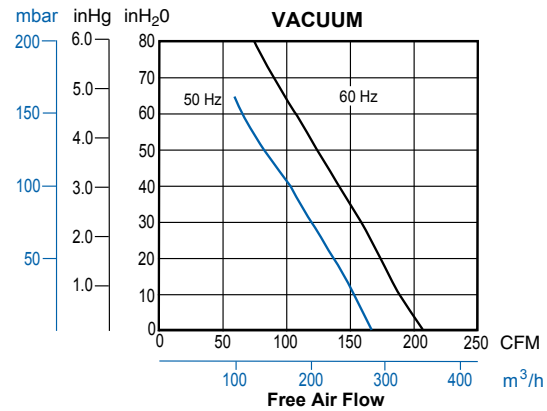
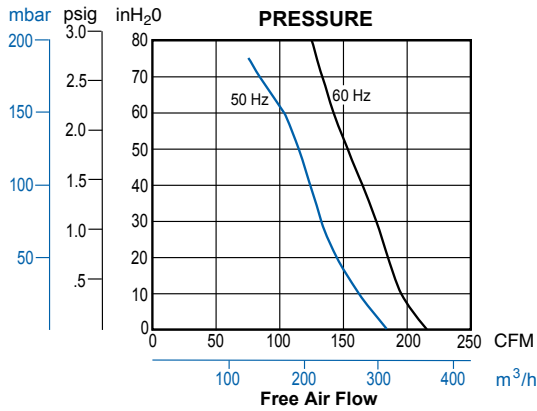

Models R6150J-2, R6350A-2, R6350B-2

