

# Rotary Cam Switches

**Front mounting** Four hole mounting 36 × 36 mm

## Front mounting switches with four hole mounting 36 × 36 mm

- 20 A / 25 A / 32 A
- 1 up to 24 contacts
- IP66 (front)

- Control Switch
- ON-OFF Switch
- Multi-step Switch
- Instrument Switch
- Changeover Switch
- Motor Switch



### Setup of order code number: Type - Switching programme - Mounting form

Ordering example:

4 pole Changeover Switch without OFF 60°, 20 A, M-handle silver/black →

Type	Switching programme	Mtg. form
M220	61040	003M1
<b>Order code no.</b>	<b>M220-61040-003M1</b>	

Type	Rated data (IEC 60947)			Degree of Protection Terminals	Terminal accessibility
	Operational current $I_e$ AC-21A (A)	Operational power (at 380–440 V) AC-23A (kW)	AC-3A (kW)		
<b>P220</b> <b>P225</b>	20 25	7.5 11	5.5 7.5	IP1B IP1B	Terminals accessible from mounting direction
<b>M220</b> <b>M225</b>	20 25	7.5 11	5.5 7.5	IP20 IP20	Terminals accessible laterally
<b>T225</b>	32	15	11	IP20	Terminals accessible laterally

Switching programme	Stages	Contacts	Description
<b>61191</b>	1	1	ON-OFF Switch 90°, 1 pole
<b>61192</b>	1	2	ON-OFF Switch 90°, 2 pole
<b>61001</b>	1	1	ON-OFF Switch 60°, 1 pole
<b>61002</b>	1	2	ON-OFF Switch 60°, 2 pole
<b>61025</b>	1	2	Changeover Switch with centre OFF 60°, 1 pole
<b>61026</b>	2	4	Changeover Switch with centre OFF 60°, 2 pole
<b>61027</b>	3	6	Changeover Switch with centre OFF 60°, 3 pole
<b>61037</b>	1	2	Changeover Switch without OFF 60°, 1 pole
<b>61040</b>	4	8	Changeover Switch without OFF 60°, 4 pole
<b>61050</b>	2	4	Multi-step Switch without OFF, 4 steps, 1 pole
<b>61313</b>	3	6	Voltmeter Selector Switch with centre OFF, 3 phase line to line + 3 phase line to N
<b>61325</b>	3	6	Ammeter Selector Switch with centre OFF, 3 transformers, 1 pole
<b>61211</b>	3	5	Motor Reversing Switch, 3 pole

Switching diagrams and further switching programmes from page 56.

Mounting form	Operator
<b>003M1</b>	M-handle silver/black

Dimensions in mm:

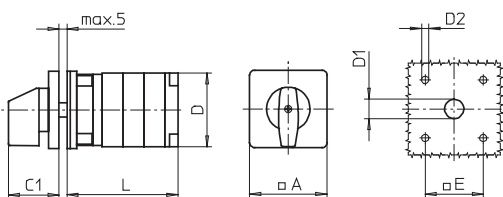

Type	A	C1	D	D1	D2	E	L with ... stages (max. 12)					each additional
							1	2	3	4	5	
<b>P220</b>	48	32	44	12	4.5	36	47	60	73	86	99	13
<b>P225</b>	48	32	46	12	4.5	36	51	66	81	96	111	15
<b>M220</b>	48	32	46	12	4.5	36	40	50	60	70	80	10
<b>M225</b>	48	32	48	12	4.5	36	43	56	69	82	95	13
<b>T225</b>	48	32	50	12	4.5	36	45	60	75	90	105	15