

LW200 – Float Level Switch

- ▶ Container inner pressure has no impact on measuring
- ▶ Up to 4 switching points (4 floats)
- ▶ NC / NO programmable
- ▶ Easy to use, applicable to various medium
- ▶ Stainless steel wetted parts
- ▶ Measuring range up to 2m

With liquid level fluctuation, a magnetic float triggers the switch inside of the tube.

Specifications

Measuring Range (Rod length L)	250mm/ 500mm/ 750mm/1000mm/1500mm 2000mm/ others customizable
Hysteresis	2% of F.S.
Applicable Medium	Corrosive liquids compatible with 304stainless steel
Pressure Rating	20bar
Medium Density	≥0.7g/cm ³
Temperature	
Operating/Medium	-20...80℃ / -20...100℃
Storage	-30...+80℃
Materials	
Electrical Head	Cast aluminium
Process Connection /Tube/Float	304 stainless steel (316 stainless steel or PTEE customizable)
Protection Class	IP65
Electrical Connection	M12×1 plug, solenoid plug

Applications

- ▶ Food and pharmaceutical industry
- ▶ Power plant
- ▶ Petrochemical
- ▶ Water treatment
- ▶ Boiler
- ▶ Papermaking



Wiring

Wiring	Normally opened	Normally closed												
<div><table><tr><th>Plug</th><th>Cable</th></tr><tr><td>1</td><td>Brown</td></tr><tr><td>2</td><td>White</td></tr><tr><td>3</td><td>Blue</td></tr><tr><td>4</td><td>Black</td></tr><tr><td>5</td><td>Gray</td></tr></table></div> <div>M12×1 plug</div>	Plug	Cable	1	Brown	2	White	3	Blue	4	Black	5	Gray		
Plug	Cable													
1	Brown													
2	White													
3	Blue													
4	Black													
5	Gray													

Plug
1
2
3

Solenoid plug

 Note 1: up to 2 floats for the product with solenoid plug. Note 2: NC, NO can be swapped by simply changing the mounting direction. (Normally opened) |

Note 1: up to 2 floats for the product with solenoid plug.
Note 2: NC, NO can be swapped by simply changing the mounting direction.
(Normally opened)

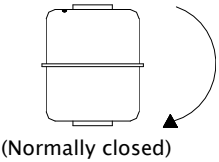

Optional Floaters

Size	Model I	Model II	Model III
A(inch/mm)	1.65 / (42)	2 / (51)	2.05 / (52)
B(inch/mm)	1.97 / (50)	2.44 / (62)	2.76 / (70)
C(inch/mm)	0.61 / (15.5)	0.61 / (15.5)	0.71 / (18)

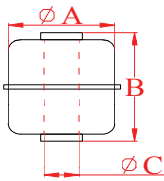

Dimensions in inches (mm)

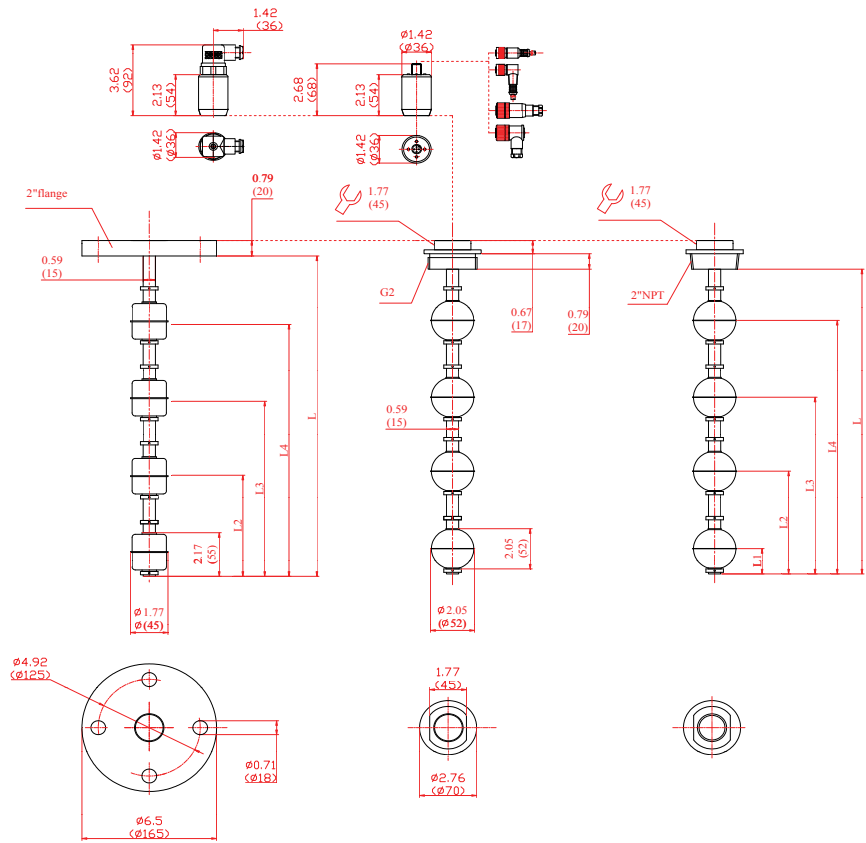

Order Code

LW :	Float level switch
200 :	Series#
01 :	1 float
02 :	2 floats
03 :	3 floats (only for the product with M12 plug)
04 :	4 floats (only for the product with M12 plug)
F :	Flange connection
G :	G2 male thread
N :	2"NPT male thread

LW	200/	03/	F	S	M1000	S	/
----	------	-----	---	---	-------	---	---

S : M12X1 5-pin plug
H : Solenoid plug
MXXXX : Rod length(metric system) L=xxxx mm
IXXXX : Rod length(english system) L=xxxx inch
Note : M1000 means that the rod length is 1000mm with the valid range 940mm.

Float shape
S : Ball
C : Cylinder

Note: Please indicate the length of L1...L4.

Sepecial Order on Request

- ▶ Electrical/process connection
- ▶ Float material/size
- ▶ Rod material/length