

Multi-axis Controller

V14



The V14 is a robust switching device for remote control and electro-hydraulic applications. Due to its modular design, this control unit can be used universally. The integrated sensor system has signal and potentiometer tracks in conductive plastic technology. Switching contacts are also available as an option.

Technical data

Mechanical life V14	6 million operating cycles
Operation temperature	-40°C to +85°C
Degree of protection	up to IP65



1

		V14L	S8	P	T	Example					
						-01 Z C	+03 R	-A05 C61	+A110	-X	
Basic unit											
V14L	2-axis left										
Control-handle extended											
	Standard 60 mm**										
S8	+20 mm										
*Only available in combination with grip!											
Gate											
P	Cross gate										
Grip / Palm grip											
T	Dead man										
Axis 1 (direction 1-2)											
01	2 contacts (2A 250 V AC15)										
Z	Spring return										
C	Mechanical encoder										
Axis 2 (direction 3-4)											
03	6 contacts (2A 250 V AC15)										
R	Friction brake										
Description axis 1 (direction 1-2)											
A05	Arrangement MSP21										
C61	Mechanical encoder MEC 1-2										
Description axis 2 (direction 3-4)											
A110	Arrangement MS24-0										
Special model											
X	Special / customer specified										

Technical details may vary based on configuration or application! Technical data subject to change without notice!

Multi-axis Controller

V14



Combination possibilities with our grips



	V14L	S8	P	T	-
Basic unit					
V14.1L	1-axis left				
V14.1R	1-axis right				
V14L	2-axis left				
V14R	2-axis right				
Control-handle extended					
	Standard 60 mm*				
S8	+20 mm				
*Only available in combination with a handle!					
Gate					
P	Cross gate				
P X	Special gate				
Grip / palm grip					
	Knob 25 mm (standard)				
M	Mechanical zero interlock				
MH	Mechanical zero interlock + signal contact				
T	Dead man				
H	Signal button				
GK1	Knob 42 mm				
GK1M	Mechanical zero interlock				
GK1MN	Mechanical zero interlock (push down)				
GK1T	Dead man				
GK1H	Signal button				
GK1MH	Mechanical zero interlock + signal contact				
GK1D	Push button				
GK1DV	Flush push button				
GS9	Hall-twist grip with spring return				
GS9-D	Hall-twist grip with spring return and push button on top				
B...	Palm grip B... (see page palm grip page 170)				

01 Z C + 03 R - A05 C61 + A110 - X

Identification of the installation variants with switching directions:

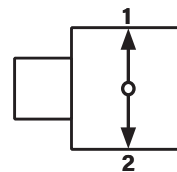

V14.1L

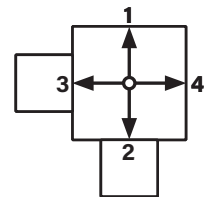

V14L

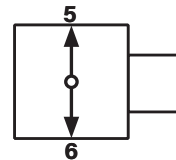

V14.1R

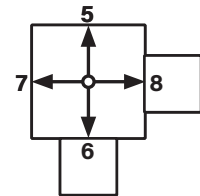

V14R

*Attention! The Multi-axis Controller V14 is not suitable for large palm grips (B3, B7/B8, B9...)

V14L S8 P T - 01 Z C + 03 R - A05 C61 + A110 - X

Axis 1: direction 1-2 left / direction 5-6 right

(Standard contacts gold-plated 2A 250V AC15)

01	2 contacts	Standard contact - arrangement see page 151	
02	4 contacts	e.g.	
03	6 contacts	A05	MS21
		A0500	MS21-00
		A110	MS24-0
		A99 contact - arrangement according customer request	

Technical details may vary based on configuration or application! Technical data subject to change without notice!

V14

1

Technical details may vary based on configuration or application! Technical data subject to change without notice!

Multi-axis Controller

V14



1

T = Dead man's button
H = Signal button
M = Latch for mechanical zero interlock

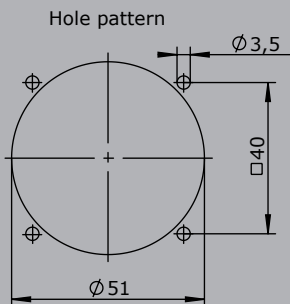
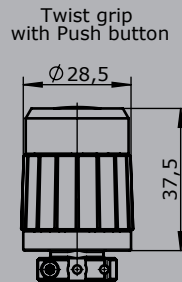
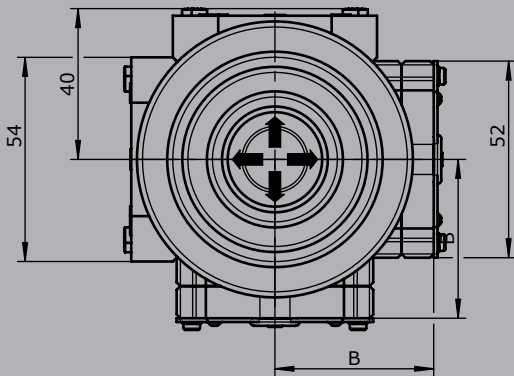
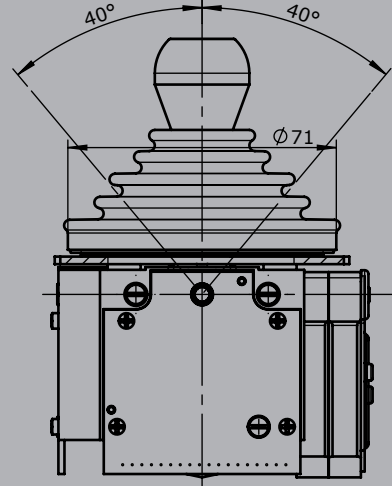
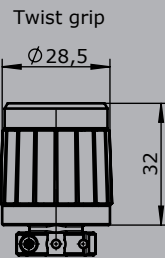
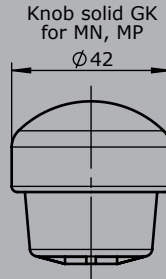
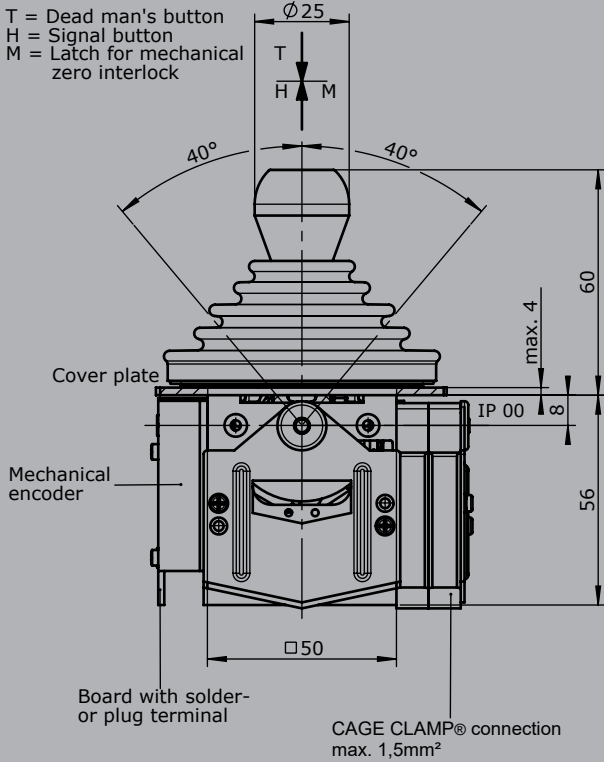

Type	No. of contacts	Dim.
01	2	36
02	4	45
03	6	54