

FUJI KOATSU

PART No.231

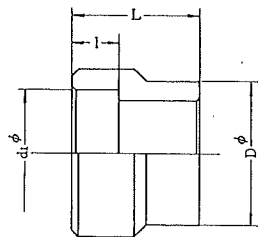

PART No.	d ₁	D	l	L	質量(g)
231-10-8	14.3	17.3	12	31	50
231-15-10	17.8	21.7	13	34	90
231-20-15	22.2	27.2	13	38	100
231-25-20	27.7	34.0	16	42	230
231-32-25	34.5	42.7	17	48	460
231-40-32	43.2	48.6	18	52	480
231-50-40	49.1	60.5	20	56	800

PART No.110

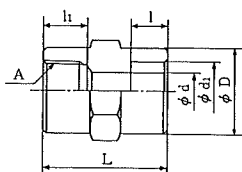

PART No.	A	d	d ₁	D	H	h ₁	l	L
110-8	Rc 1/4	7.8	14.3	22	22	13	10	30
110-10	Rc 3/8	10.9	17.8	27	27	15	13	35
110-15	Rc 1/2	14.3	22.2	32	32	17	13	37
110-20	Rc 3/4	19.4	27.7	38	38	19	16	45
110-25	Rc 1	25.0	34.5	46	50	22	16	47
110-32	Rc 1 1/4	32.9	43.2	55	55	25	18	55
110-40	Rc 1 1/2	38.4	49.1	63	65	25	19	57
110-50	Rc 2	49.5	61.1	75	75	30	22	70

PART No.111

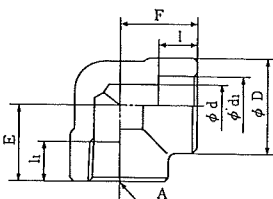

PART No.	A	h ₁	E	F	l	d	d ₁	D
111-8	Rc 1/4	11	21.1	21.1	10	7.8	14.3	23
111-10	Rc 3/8	12	26.5	26.5	13	10.9	17.8	28
111-15	Rc 1/2	15	28.9	28.9	13	14.3	22.2	33
111-20	Rc 3/4	17	35.1	35.1	16	19.4	27.7	38
111-25	Rc 1	19	38.2	38.2	16	25.0	34.5	47
111-32	Rc 1 1/4	22	45.0	45.0	18	32.9	43.2	57
111-40	Rc 1 1/2	22	50.8	50.8	19	38.4	49.1	64
111-50	Rc 2	26	60.1	60.1	22	49.5	61.1	77

PART No.112

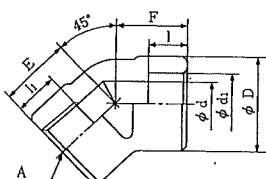

PART No.	A	h ₁	E	F	l	d	d ₁	D
112-8	Rc 1/4	11	17.9	17.9	10	7.8	14.3	23
112-10	Rc 3/8	12	20.9	20.9	13	10.9	17.8	28
112-15	Rc 1/2	15	24.1	24.1	13	14.3	22.2	33
112-20	Rc 3/4	17	28.7	28.7	16	19.4	27.7	38
112-25	Rc 1	19	31.3	31.3	16	25.0	34.5	47
112-32	Rc 1 1/4	22	35.5	35.5	18	32.9	43.2	57
112-40	Rc 1 1/2	22	39.6	39.6	19	38.4	49.1	64
112-50	Rc 2	26	47.4	47.4	22	49.5	61.1	77

PART No.115

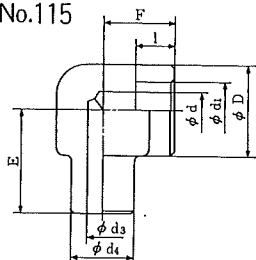

PART No.	d	d ₁	d ₂	d ₃	d ₄	D	l	E	F
115-8	7.8	14.3	17	9.0	15	22	10	29	19
115-10	10.9	17.8	22	11.5	18	26	13	33	21
115-15	14.3	22.2	27	15.0	23	32	13	38	23
115-20	19.4	27.7	33	19.5	28	38	16	43	33
115-25	25.0	34.5	42	25.0	35	47	16	48	40



PART No.128

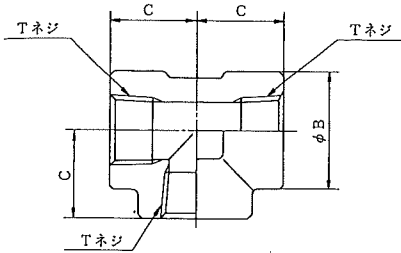

PART No.	Tネジ	φ B	C	質量 (g)
128-8	Rc 1/4	23	21	125
128-10	Rc 3/8	27	25	210
128-15	Rc 1/2	34	29	350
128-20	Rc 3/4	38	33	380
128-25	Rc 1	47	38	760
128-32	Rc1 1/4	57	45	1110
128-40	Rc1 1/2	64	50	1500
128-50	Rc 2	77	59	2410
128-65	Rc2 1/2	95	67	4100
128-80	Rc 3	110	86	6800

PART No.130

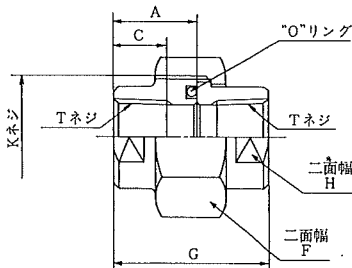

PART No.	Tネジ	A	Kネジ	F	H	G	Oリング JIS B 2401	質量 (g)
130-8	Rc 1/4	20.0	M30P=2	35	19	38.0	P18	140
130-10	Rc 3/8	20.0	M36P=2	41	23	38.0	P20	210
130-15	Rc 1/2	21.5	M39P=2	46	29	44.0	G25	300
130-20	Rc 3/4	26.0	M48P=2	54	35	50.0	G30	490
130-25	Rc 1	29.0	M56P=2	63	44	56.0	G35	730
130-32	Rc1 1/4	29.0	M68P=2	77	54	59.5	G45	1370
130-40	Rc1 1/2	36.0	M72P=2	80	60	72.0	G50	1420
130-50	Rc 2	36.0	M85P=2	95	71	72.0	G65	1910

PART No.131

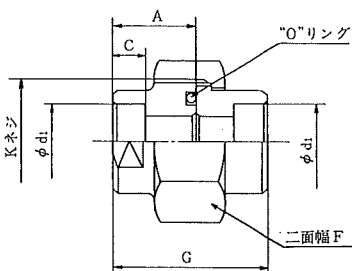

PART No.	φφ d1	Kネジ	A	C	F	G	Oリング JIS B 2401	質量 (g)
131-8	14.3	M30P=2	20.0	10	35	38.0	P18	150
131-10	17.8	M36P=2	20.0	10	41	38.0	P20	220
131-15	22.2	M39P=2	21.5	10	46	44.0	G25	330
131-20	27.7	M48P=2	26.0	13	54	50.0	G30	510
131-25	34.5	M56P=2	29.0	13	63	56.0	G35	740
131-32	43.2	M68P=2	29.0	13	77	59.5	G45	1400
131-40	49.1	M72P=2	36.0	13	80	72.0	G50	1500
131-50	61.1	M85P=2	36.0	17	95	72.0	G65	2000

PART No.132

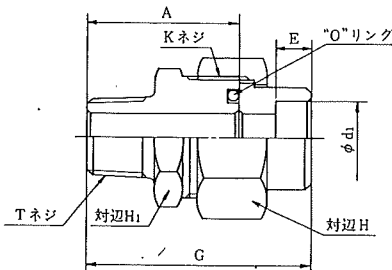

PART No.	Tネジ	A	Kネジ	H1	H	E	φd1	G	Oリング JIS B 2401	質量 (g)
132-8	R 1/4	40.0	M30P=2	32	35	10	14.3	58	P18	280
132-10	R 3/8	44.0	M36P=2	38	41	10	17.8	62	P20	350
132-15	R 1/2	46.5	M39P=2	41	46	10	22.2	69	G25	500
132-20	R 3/4	56.0	M48P=2	50	54	13	27.7	80	G30	800
132-25	R 1	60.0	M56P=2	58	63	13	34.5	87	G35	1130
132-32	R1 1/4	66.5	M68P=2	70	77	13	43.2	97	G45	2140
132-40	R1 1/2	71.0	M72P=2	75	80	13	49.1	107	G50	2300
132-50	R 2	80.0	M85P=2	90	95	17	61.1	116	G65	3200

PART No.133

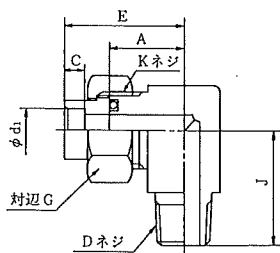

PART No.	Dネジ	C	E	Kネジ	φd1	J	A	G	H	Oリング JIS B 2400	質量 (g)
133-8	R 1/4	10	47.0	M30P=2	14.3	32	29	35	21	P18	340
133-10	R 3/8	10	48.0	M36P=2	17.8	38	30	41	23	P20	380
133-15	R 1/2	10	57.5	M39P=2	22.2	45	35	46	30	G25	880
133-20	R 3/4	13	64.0	M48P=2	27.7	52	40	54	35	G30	1100
133-25	R 1	13	70.0	M56P=2	34.5	60	43	63	42	G35	1850
133-32	R1 1/4	13	77.5	M68P=2	43.2	75	47	77	70	G45	3380
133-40	R1 1/2	13	90.0	M72P=2	49.1	75	54	80	85	G50	4500
133-50	R 2	17	96.0	M85P=2	61.1	87	60	95	90	G65	6500