



TENTUBE SERIES

Specifications

Pressure:

Vacuum to 100 psi, 6.9 bar per line

Temperature:

Acetal fitting inserts:

-40°F to 180°F (-40°C to 82°C)

Polypropylene fitting inserts:

32°F to 180°F (0°C to 82°C)

Materials:

Main components: Nylon

Valves: Acetal

Valve springs: 316 stainless steel

Fitting inserts: Acetal or polypropylene

O-rings: Buna-N with acetal
or EPDM with polypropylene

Panel mount adapter: Acetal

Tube shroud: Acetal

Color:

Main components:

Black with red locking latch

Tube shroud: Black

Panel mount adapter: Black

Tubing Sizes:

1/16" to 1/8" ID, 1.6mm to 3.2mm ID

The Tentube™ coupling provides one easy-to-use quick disconnect for up to ten separate fluid lines. The Tentube is available with valves on the body side in panel mount or in-line configurations for maximum design flexibility. The Tentube can connect and disconnect up to ten lines with the use of a simple slide latch. Tubing orientation is ensured by keying the coupling body and insert. Different fluids and tubing sizes can be accommodated by using acetal or polypropylene inserts in three popular sizes.

Features

- Ten line connection
- Separate flow paths
- Insert is keyed to body
- Acetal or polypropylene inserts

Benefits

- Fast, efficient operation
- Pressure and/or vacuum in one coupling
- Ensures correct line orientation
- Maximize design flexibility

Note: Use TMF and TFF inserts and bodies for custom designed assemblies. See page 69.

Panel Mount Dimensions

	PANEL OPENING	MAX. PANEL THICKNESS	MIN. PANEL THICKNESS
COUPLING BODIES	see drawing	.44	.06

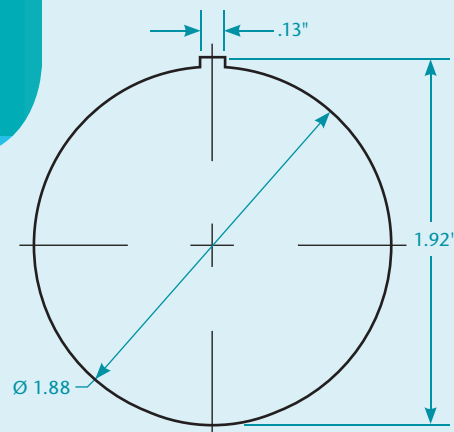

Tentube Air Flow, 100 psig Inlet Pressure

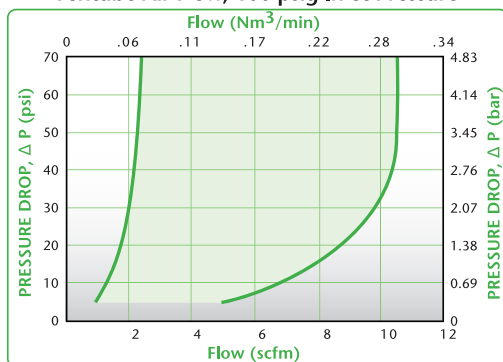

Tentube Water Flow

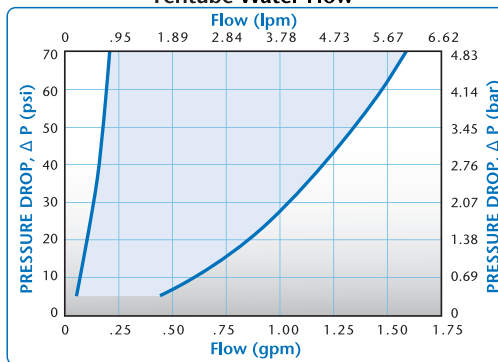

These graphs are intended to give you a general idea of the performance capabilities of each product line. The shaded area of each graph represents the operating range of the product family, i.e., upper and lower values are shown. Therefore, depending on the exact coupling configurations selected, you can reasonably expect values to fall within the shaded area.

Tentube™ Complete ACETAL / POLYPROPYLENE

TERMINATIONS COMPLETE COUPLING SET	TUBING SIZE 1/16" ID 1/8" ID	METRIC EQ. 1.6mm ID 3.0mm ID 3.2mm ID	ACETAL STRAIGHT THRU TT1001 TT10M3 TT1002	ACETAL SHUTOFF TTD1001 TTD10M3 TTD1002	POLYPROPYLENE STRAIGHT THRU TT100112 TT100212	
TERMINATIONS COUPLING BODY WITH FEMALE FITTING BODIES	TUBING SIZE 1/16" ID 1/8" ID Without fitting bodies	METRIC EQ. 1.6mm ID 3.0mm ID 3.2mm ID	ACETAL STRAIGHT THRU TFB1001 TFB10M3 TFB1002 TFB10	ACETAL SHUTOFF TFBD1001 TFBD10M3 TFBD1002	POLYPROPYLENE STRAIGHT THRU TFB100112 TFB100212	
TERMINATIONS COUPLING INSERT WITH MALE FITTING INSERTS	TUBING SIZE 1/16" ID 1/8" ID Without fitting inserts	METRIC EQ. 1.6mm ID 3.0mm ID 3.2mm ID	ACETAL STRAIGHT THRU TMB1001 TMB10M3 TMB1002 TMB10		POLYPROPYLENE STRAIGHT THRU TMB100112 TMB100212	

Inserts & Bodies

ACETAL / POLYPROPYLENE

TERMINATIONS FITTING INSERTS (SEE NOTE ON PAGE 68)	TUBING SIZE 1/16" ID 1/8" ID	METRIC EQ. 1.6mm ID 3.0mm ID 3.2mm ID	ACETAL STRAIGHT THRU TMF01 TMFM3 TMF02		POLYPROPYLENE STRAIGHT THRU TMF0112 TMF0212	
TERMINATIONS FITTING BODIES (SEE NOTE ON PAGE 68)	TUBING SIZE 1/16" ID 1/8" ID	METRIC EQ. 1.6mm ID 3.0mm ID 3.2mm ID	ACETAL STRAIGHT THRU TFF01 TFFM3 TFF02	ACETAL SHUTOFF TFFD01 TFFDM3 TFFD02	POLYPROPYLENE STRAIGHT THRU TFF0112 TFF0212	

Note: Acetal bodies and inserts are also available in white. To order, add MWHT to the end of the part number.

Accessories

DESCRIPTION Tube shroud - snaps into either half Panel mount adapter & nut - 7/16" max. panel thickness; requires 1.875" diameter hole Tube jacketing - black, 40 foot coils	PART NO. TS10 TPM10 TJ10	
---	--	--

All measurements are in inches (millimeters) unless otherwise noted. Tubing must meet stated inside and outside diameters. Couplings are pictured with valves unless otherwise noted.