

# Immersion Pumps

## STA401...409

Semi-open impellers

### STA401...409

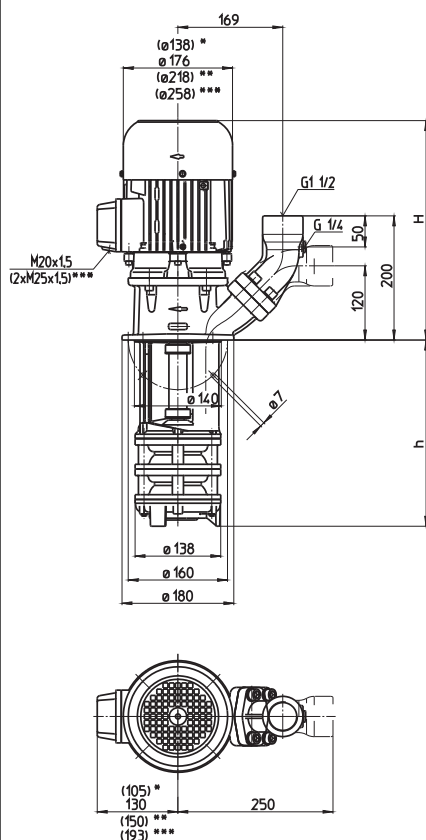

- \*) Dimensions for STA401  
 \*\*) Dimensions for STA405, 406, 407  
 \*\*\*) Dimensions for STA409

| Type              | Vol. del.<br>at manom.<br>del. head<br>l/min / m | Height<br>H mm | Depth<br>of im-<br>mersion<br>h mm | Weight<br>kg | Power<br>kW | Voltage<br>3 ~<br>V | Fre-<br>quen-<br>cy<br>Hz | Current<br>A | Speed<br>1/min |
|-------------------|--|----------------|------------------------------------|--------------|-------------|---------------------|---------------------------|--------------|----------------|
| <b>STA401/120</b> | 250/5  | 334            | 120                                | 21.5         | 0.85        | 220-240             | 50                        | 3.64         | 2850           |
| <b>200</b>        |  |                | 200                                | 22.5         |             | 380-415             | 50                        | 2.10         | 2850           |
| <b>270</b>        |  |                | 270                                | 23.5         |             |                     |                           |              |                |
| <b>350</b>        |  |                | 350                                | 24.5         | 0.98        | 460                 | 60                        | 2            | 3450           |
| <b>440</b>        |  |                | 440                                | 25.5         |             |                     |                           |              |                |
| <b>550</b>        |  |                | 550                                | 27.5         |             |                     |                           |              |                |
| <b>750</b>        |  |                | 750                                | 34.0         |             |                     |                           |              |                |
| <b>900</b>        |  |                | 900                                | 36.0         |             |                     |                           |              |                |
| <b>STA402/170</b> | 250/12   | 380            | 170                                | 31.0         | 1.3         | 220-240             | 50                        | 4.85         | 2900           |
| <b>250</b>        |  |                | 250                                | 32.5         |             | 380-415             | 50                        | 2.80         | 2900           |
| <b>320</b>        |  |                | 320                                | 33.5         |             |                     |                           |              |                |
| <b>400</b>        |  |                | 400                                | 34.5         | 1.49        | 460                 | 60                        | 2.7          | 3500           |
| <b>490</b>        |  |                | 490                                | 35.5         |             |                     |                           |              |                |
| <b>600</b>        |  |                | 600                                | 37.0         |             |                     |                           |              |                |
| <b>800</b>        |  |                | 800                                | 44.0         |             |                     |                           |              |                |
| <b>950</b>        |  |                | 950                                | 46.0         |             |                     |                           |              |                |
| <b>STA403/220</b> | 250/20   | 439            | 220                                | 40           | 1.9         | 220-240             | 50                        | 6.84         | 2900           |
| <b>300</b>        |  |                | 300                                | 41           |             | 380-415             | 50                        | 3.95         | 2900           |
| <b>370</b>        |  |                | 370                                | 42           |             |                     |                           |              |                |
| <b>450</b>        |  |                | 450                                | 43           | 2.18        | 460                 | 60                        | 3.9          | 3500           |
| <b>540</b>        |  |                | 540                                | 44           |             |                     |                           |              |                |
| <b>650</b>        |  |                | 650                                | 46           |             |                     |                           |              |                |
| <b>850</b>        |  |                | 850                                | 52           |             |                     |                           |              |                |
| <b>1000</b>       |  |                | 1000                               | 55           |             |                     |                           |              |                |
| <b>STA404/270</b> | 250/27   | 439            | 270                                | 44           | 2.6         | 220-240             | 50                        | 9.30         | 2880           |
| <b>350</b>        |  |                | 350                                | 45           |             | 380-415             | 50                        | 5.35         | 2880           |
| <b>420</b>        |  |                | 420                                | 46           |             |                     |                           |              |                |
| <b>500</b>        |  |                | 500                                | 48           | 2.94        | 460                 | 60                        | 5.1          | 3480           |
| <b>590</b>        |  |                | 590                                | 49           |             |                     |                           |              |                |
| <b>700</b>        |  |                | 700                                | 51           |             |                     |                           |              |                |
| <b>900</b>        |  |                | 900                                | 57           |             |                     |                           |              |                |
| <b>1050</b>       |  |                | 1050                               | 59           |             |                     |                           |              |                |
| <b>STA405/320</b> | 250/33   | 478            | 320                                | 57           | 3.3         | 220-240             | 50                        | 11.6         | 2930           |
| <b>400</b>        |  |                | 400                                | 58           |             | 380-415             | 50                        | 6.7          | 2930           |
| <b>470</b>        |  |                | 470                                | 59           |             |                     |                           |              |                |
| <b>550</b>        |  |                | 550                                | 60           | 3.8         | 460                 | 60                        | 6.4          | 3520           |
| <b>640</b>        |  |                | 640                                | 61           |             |                     |                           |              |                |
| <b>750</b>        |  |                | 750                                | 64           |             |                     |                           |              |                |
| <b>950</b>        |  |                | 950                                | 70           |             |                     |                           |              |                |
| <b>1100</b>       |  |                | 1100                               | 72           |             |                     |                           |              |                |
| <b>STA406/370</b> | 250/39   | 478            | 370                                | 59           | 4.0         | 220-240             | 50                        | 14.50        | 2920           |
| <b>450</b>        |  |                | 450                                | 61           |             | 380-415             | 50                        | 8.35         | 2920           |
| <b>520</b>        |  |                | 520                                | 62           |             |                     |                           |              |                |
| <b>600</b>        |  |                | 600                                | 63           | 4.55        | 460                 | 60                        | 7.9          | 3520           |
| <b>690</b>        |  |                | 690                                | 64           |             |                     |                           |              |                |
| <b>800</b>        |  |                | 800                                | 66           |             |                     |                           |              |                |
| <b>1000</b>       |  |                | 1000                               | 73           |             |                     |                           |              |                |
| <b>STA407/420</b> | 250/45   | 508            | 420                                | 71           | 5.0         | 220-240             | 50                        | 17.3         | 2920           |
| <b>500</b>        |  |                | 500                                | 72           |             | 380-415             | 50                        | 10.0         | 2920           |
| <b>570</b>        |  |                | 570                                | 73           |             |                     |                           |              |                |
| <b>650</b>        |  |                | 650                                | 75           | 5.75        | 460                 | 60                        | 9.5          | 3520           |
| <b>740</b>        |  |                | 740                                | 76           |             |                     |                           |              |                |
| <b>850</b>        |  |                | 850                                | 78           |             |                     |                           |              |                |
| <b>STA409/520</b> | 250/52   | 549            | 520                                | 97           | 6.0         | 380-415             | 50                        | 11.2         | 2950           |
| <b>600</b>        |  |                | 600                                | 98           |             |                     |                           |              |                |
| <b>670</b>        |  |                | 670                                | 99           | 6.9         | 460                 | 60                        | 10.7         | 3550           |
| <b>750</b>        |  |                | 750                                | 100          |             |                     |                           |              |                |
| <b>840</b>        |  |                | 840                                | 102          |             |                     |                           |              |                |
| <b>950</b>        |  |                | 950                                | 104          |             |                     |                           |              |                |

## Immersion Pumps

are plain centrifugal pumps with the impeller fitted on the driving shaft extension. They are mounted on top of the container, the pump extension being immersed in the coolant.

The maximum coolant level must stay a few mm/inches below the mounting flange.

The STA series offers a **(SAE) flange** with pressure gauge connection port.

The flange can be rotated for either horizontal or vertical pipe connections.



All types are also available as quick-suctioning immersion pumps equipped with "BRINKMANN's Suction De-aeration System". See series SAL.



All types are also available as suction immersion pump with a connection to the vacuum filters on the suction side. See series STS.

## Applications

Types of fluid  
coolants  
cooling/cutting oils  
Kinematic viscosity  
...45 mm<sup>2</sup>/s (45 cSt)  
Pumping temperature  
0...80° C  
higher temperatures upon request

## Construction

|                 |                     |
|-----------------|---------------------|
| Pump body       | cast iron           |
| Cover           | cast iron           |
| Impellers       | brass               |
| Shaft           | steel               |
| Optional:       |                     |
| Suction cover   | with threaded inlet |
| Impellers       | cast steel          |
| Noise level     |                     |
| STA401          | 62 dBA              |
| STA402...STA404 | 66 dBA              |
| STA405...STA407 | 71 dBA              |
| STA409          | 74 dBA              |

