

# P | Cabling

## Data sheet

### REGplus IP20 C6<sub>A</sub>modul 180°M

Page 1/8

P/N

130B117003-E

EAN 4250184136545

2023/04/17

Version: AC

## Illustrations



Dimensional drawing

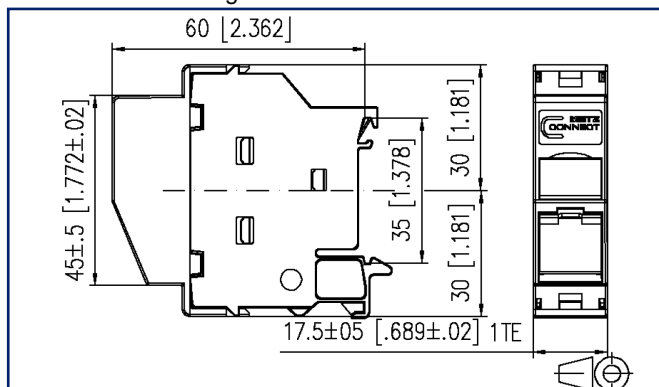

See enlarged drawings at the end of document

## Product specification

- termination unit for mounting on TH35 rails to DIN EN 60715 in electrical distribution panels for home and industrial installations
- equipped with C6<sub>A</sub>modul 180° RJ45 individual module
- cable feed 45° from the top, plug direction 45° downwards
- certified to GHMT Cat.6<sub>A</sub> re-embedded PVP
- Cat.6<sub>A</sub> component test according to ISO/IEC 11801, DIN EN 50173-1, ANSI/TIA-568.2-D and IEC 60603-7-51, GHMT certified
- compliance with class E<sub>A</sub> up to 500 MHz according to ISO/IEC 11801, DIN EN 50173-1
- tested: component up to 600 MHz, link up to 800 MHz
- suitable for 10 GBit Ethernet (IEEE 802.3an), Remote Powering (PoE, PoE plus, UPoE and 4PPoE) and HDBaseT
- easy to install connection of data lines AWG 26/1 to 22/1 (solid wire) and AWG 26/7 to 22/7 (stranded wire) to insulation displacement connectors (IDC)
- conductor assignment to T568A and T568B is directly printed on the stuffer cap
- migration to 25G-systems without special tools
- width of 1HP allows mounting up to 12 REG plus in standard electrical distribution panels
- When mounted as a device of protection class I, the equipotential bonding is realized directly over the top hat rail by means of an integrated equipotential plate. This has to be connected to the equipotential bonding of the building by means of a bonding terminal
- A cover protects the module against direct contact. If mounted in distributor panels with protective insulation, protection class II is guaranteed. In this case, it is necessary to remove the equipotential bonding spring.
- integrated dust protection cover (also colored)

# P | Cabling

## Data sheet

## REGplus IP20 C6<sub>A</sub>modul 180°M

Page 2/8

P/N

130B117003-E

EAN 4250184136545

2023/04/17

Version: AC

### Technical Data

#### General Data

|   |  |
|---|--|
| Fields of application                         | office areas                           |
| Mechanical measurement according to MICE      | M1                                     |
| Ingress measurement according to MICE         | I1                                     |
| Climatic measurement according to MICE        | C1                                     |
| Electromagnetic measurement according to MICE | E2                                     |
| Design  | wall outlet                            |
| Mounting style                                | Standard rail TH35                     |
| Shielding                                     | shielded                               |
| Transmission technology                       | Copper                                 |
| Color   | light gray                             |
| Dimensions                                    |  |
| Dimension (L x W x H)                         | 60 mm x 17.5 mm x 60 mm                |
| Dimension (L x W x H)                         | 2.362 in. x 0.689 in. x 2.362 in.      |
| Horizontal pitch                              | 1HP                                    |
| Labeling option                               | label window with identification label |
| Marking option                                | by dust protection                     |

#### Transmission characteristics

|                                 |                |
|---------------------------------|----------------|
| Category (ISO)                  | 6 <sub>A</sub> |
| Class (ISO/IEC)                 | E <sub>A</sub> |
| Category (TIA)                  | 6A             |
| Remote Powering                 | yes            |
| PoE                             | IEEE 802.3af   |
| PoE plus                        | IEEE 802.3at   |
| UPoE                            | yes            |
| 4PPoE                           | IEEE 802.3bt   |
| HDBaseT                         | yes            |
| Transmission rate up to 10 GBit | IEEE 802.3an   |

# P | Cabling

## Data sheet

## REGplus IP20 C6<sub>A</sub>modul 180°M

Page 3/8

P/N

130B117003-E

EAN 4250184136545

2023/04/17

Version: AC

### Technical Data

#### Connections/interfaces

|   |   |
|---|---|
| Connector technology interface 1                | IDC-connection                                |
| Connector technology interface 2                | RJ45-jack                                     |
| Number of ports interface 2                     | 1   |
| Number of ports interface 2 equipped            | 1   |
| Number of positions/contacts interface 1        | 8   |
| Number of positions/contacts interface 2        | 8P/8C   |
| Termination data, solid wire (min. - max.)      |   |
| Conductor cross section, solid wire             | AWG 26/1 - AWG 22/1                           |
| Conductor cross section, solid wire             | 0.128 mm <sup>2</sup> - 0.324 mm <sup>2</sup> |
| Conductor diameter, solid wire (bare copper)    | 0.409 mm - 0.643 mm                           |
| Conductor diameter, solid wire (bare copper)    | 0.016 in. - 0.025 in.                         |
| Termination data, stranded wire (min. - max.)   |   |
| Conductor cross section, stranded wire          | AWG 26/7 - AWG 22/7                           |
| Conductor cross section, stranded wire          | 0.141 mm <sup>2</sup> - 0.355 mm <sup>2</sup> |
| Conductor diameter, stranded wire (bare copper) | 0.483 mm - 0.762 mm                           |
| Conductor diameter, stranded wire (bare copper) | 0.019 in. - 0.03 in.                          |
| Module plug-in direction                        | 45° downwards                                 |
| Cable access/outlet                             | 45° from the top                              |

#### Elektrische/ Optische Eigenschaften

|   |                |
|---|----------------|
| Current carrying capacity                           | max. 1 A       |
| Contact resistance                                  | max. 20 mOhm   |
| Insulation resistance                               | min. 500 MOhm  |
| Dielectric strength conductor-conductor (secondary) | min. 1000 V DC |

#### Mechanical data

|                                |           |
|--------------------------------|-----------|
| Insertion and withdrawal force | max. 30 N |
| Position/mounting of latch     | top       |
| standard installation position |           |

# P | Cabling

## Data sheet

## REGplus IP20 C6<sub>A</sub>modul 180°M

Page 4/8

P/N

130B117003-E

EAN 4250184136545

2023/04/17

Version: AC

### Technical Data

#### Materials and material properties

|                              |                       |
|------------------------------|-----------------------|
| Material - Housing           | GD-Zn (zinc die-cast) |
| Material - Cover part(s)     | PA66                  |
| Material - Lower housing     | PA66                  |
| Material - Label window      | ABS, transparent      |
| Material - Dust protection   | ABS                   |
| Material - Contact           | FeNiCo                |
| Material - Contact finish    | Au (gold)             |
| Material - Stuffer cap       | PA 6.6 UL94 V0        |
| Material - Finish            | Ni (nickel)           |
| Material - Ground connection | CuSn4                 |
| Material - Strain relief     | PA 6.6 UL94 V0        |
| RoHS                         | compliant             |

#### Environmental conditions

|                             |  |
|-----------------------------|--|
| Temperature (min. - max.)   |  |
| Temperature - Storage °C    | -40 °C - 70 °C                                     |
| Temperature - Storage °F    | -40 °F - 158 °F                                    |
| Temperature - Operating °C  | -40 °C - 70 °C                                     |
| Temperature - Operating °F  | -40 °F - 158 °F                                    |
| Particulate ingress         | IP2X   |
| Liquid ingress/immersion    | IPX0   |
| Rapid change of temperature | -40°C / -40°F - +70°C / 158°F / 25 cycles t=30 min |

#### Certifications

GHMT PVP



yes

# P | Cabling

## Data sheet

## REGplus IP20 C6<sub>A</sub>modul 180°M

Page 5/8

P/N

130B117003-E

EAN 4250184136545

2023/04/17

Version: AC

## Technical Data

### Approvals

UL listed (file no.)



DUXR.E178484

## Standards/Regulations

### Generic cabling systems

General requirements

ANSI/TIA-568

### Connectors for electronic equipment

Free and fixed connectors

DIN EN 60603-7-51:2011-01

### Connectors for electronic equipment - Tests and measurements

Test standard for connectors (engaging and separating connectors under electrical load)

DIN-EN 60512-99-001, DIN-EN 60512-99-002

Endurance tests

IEC 60512-9-3: 03-2009

### Interference proof

Immunity for industrial environments

DIN EN 61000-6-2:2006-03

### Climate tests

IEC 60512-11

## Classifications

ETIM 5.0

EC001024

ETIM 6.0

EC001024

ETIM 7.0

EC001024

ETIM 8.0

EC001024

ETIM 9.0

EC001024

## Packing details

Type of packaging

10 pc(s) / box

Packaging unit - Weight (gram)

641 g

Packaging unit - Weight (pound)

1.41 lb

Packaging dimension

235 mm x 165 mm x 135 mm

Packaging dimension

9.252 in. x 6.496 in. x 5.315 in.

# P | Cabling

## Data sheet

## REGplus IP20 C6<sub>A</sub>modul 180°M

Page 6/8

P/N

130B117003-E

EAN 4250184136545

2023/04/17

Version: AC

### Accessories

| P/N            | Designation   |
|----------------|---|
| 130898-00-I    | BLIND module light gray   |
| 130898-00-RW-I | BLIND module pure white   |
| 130898-01-I    | COAX modul F jack / F jack  |
| 130898-02-I    | COAX modul IEC jack / F jack                                      |
| 130898-03-I    | COAX modul IEC plug / F jack                                      |
| 130908-I-B1    | UAE modul Cat.5e white  |
| 130909-I       | UAE modul Cat.6 jack T568A white                                  |
| 130910-I       | E-DAT modul Cat.6 <sub>A</sub> 8(8) jack, T568A                   |
| 130910-I-B1    | E-DAT modul Cat.6 <sub>A</sub> 8(8) jack, T568B                   |
| 130910-Z       | E-DAT modul Cat.6 <sub>A</sub> 8(8) jack, T568A (12 pcs)          |
| 1309A0-I       | E-DAT modul coupler 8(8) 180° class E <sub>A</sub>                |
| 1309A1-I       | E-DAT modul coupler 8(8) 90° class E <sub>A</sub>                 |
| 130A11-29-I    | UAE modul 8(8) Cat.6 <sub>A</sub> black                           |
| 130A11-I       | UAE modul 8(8) Cat.6 <sub>A</sub> white                           |
| 130B11-25-E    | 25Gmodul  |
| 130B11-25-Z    | 25Gmodul (12 pcs)   |
| 130B11-E       | C6 <sub>A</sub> modul 180° jack                                   |
| 130B11-Z       | C6 <sub>A</sub> modul 180° jack (12 pcs)                          |
| 130B12-E       | C6 <sub>A</sub> modul 270° jack                                   |
| 15091001-I     | OpDAT modul ST OS2  |
| 15091071-I     | OpDAT modul LC-Duplex OS2   |
| 15091072-I     | OpDAT modul LC-Duplex OM3   |
| 15091075-I     | OpDAT modul LC-Duplex OM4   |
| 15091076-I     | OpDAT modul LC-Duplex APC OS2                                     |
| 1509107B-I     | OpDAT modul LC-Duplex OM2   |
| 816979-0103-I  | Dust protection covers for Modul patch panels subway / REG gray   |
| 816979-0105-I  | Dust protection covers for Modul patch panels subway / REG yellow |
| 816979-0106-I  | Dust protection covers for Modul patch panels subway / REG blue   |
| 816979-0107-I  | Dust protection covers for Modul patch panels subway / REG green  |
| 816979-0108-I  | Dust protection covers for Modul patch panels subway / REG red    |

# P | Cabling

Data sheet

**REGplus IP20 C6<sub>A</sub>modul 180°M**

Page 7/8

P/N

**130B117003-E**

**EAN 4250184136545**

2023/04/17

Version: AC

## Accessories

899011-01

Label sheet for Modul patch panels / REG

# P | Cabling

Data sheet

**REGplus IP20 C6<sub>A</sub>modul 180°M**

Page 8/8

P/N

130B117003-E

EAN 4250184136545

2023/04/17

Version: AC

## Illustrations

Dimensional drawing

