

DISCRETE SIGNAL & POWER CONTACTS

- Models for dry circuit to 500 amps
- .016" (.4mm) to .650" (16.5mm) diameter pins with mating sockets
- Long life contacts
- Contact resistance from .04 to 8 milliohms
- Ideal for test, burn-in, and highpower use

INDIVIDUAL CONTACTS

Individual pins and sockets are available for those applications where special constraints prohibit the use of multi-pin connectors.

Optional Configurations not shown - Please Consult factory.



Contact Dia. Inches (mm)	.016 (.40)	.018 (.45)	.024 (.60)	.030 (.76)	.040 (1.02)	.059 (1.50)	.098 (2.50)	.138 (3.50)	.169 (4.30)	.241 (6.12)	.500 (12.70)	.650 (16.50)
Page	146	147	148	149	150	151	152	153	154	155	156	156
Contact Styles M=Male F=Female												
Crimp	M, F	M, F	M, F		M, F	M	M, F		M	M, F		
Solder Cup	M, F	M	M, F		M, F	M, F	M, F	M, F	M			
Straight Dip	M, F	M, F	M, F	M, F	M	M, F						
Open Both Ends	F	F			F	F		F				
Closed End		F		F	F	F	F					
Threaded Stud						F		M, F	M, F	M, F	M, F	M, F
Press In							F	F	F	F		
Right Angle Block								M, F				
Contact Resis. (milliohms)	<8	<8	<5	<5	<2.5	<2.5	<.8	<.5	<.37	<.25	<.08	<.04
Current Rating	1	2.5	4	5	8	10	15	25, 40 & 50	100	200	350	500
Extrac. Force	.3-1.6oz.	.5-1.6oz.	.3-2.0oz.	.5-3.2oz.	1.0-3.9oz.	1.2-5oz.	6.0-25oz.	7-32oz.	15-90oz.	80-160oz	9-20 lb.	20-37 lb.
Contact Life	100,000 Cycles											
Materials	Beryllium copper wires and brass body											
Plating Reference	G = 10µ in. Gold on mating surfaces H = 50µ in. Gold AH = 50µ in. Gold on mating surface and gold flash on socket body only GT = 10µ in. Gold on mating surface and tin lead on socket body only HT = 50µ in. Gold on mating surface and tin lead on socket body only ABH = 50µ in. Gold on mating surface and tin lead on tail. All other surfaces gold flash. ALT = 30µ in. Gold on mating surface and tin on tail. All other surfaces gold flash. L = 250µ in. Gold * Suffix at end of part number determines plating. Example: The G in YPN005-001G equals 10µ in. Gold.											

Note: Performance specifications are based on mating Hypertronics contacts.

Ø .016" (.40mm) CONTACTS

Materials: Beryllium copper wires and brass body
 Plating: Gold over nickel
 Resistance: < 8 milliohms
 Current Rating: 1.0 amps
 Extraction Force: Min. .3 oz., Max 1.6 oz.
 Life: 100,000 cycles

Plating Reference

Male Pins: G = 10 µin gold (min) over Ni
 H = 50 µin gold (min) over Ni
 Female Sockets: AH = 50 µin gold (min) over Ni on mating surface, gold flash over Ni on termination

MALE CONTACTS (PINS)

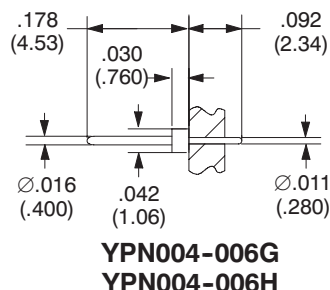
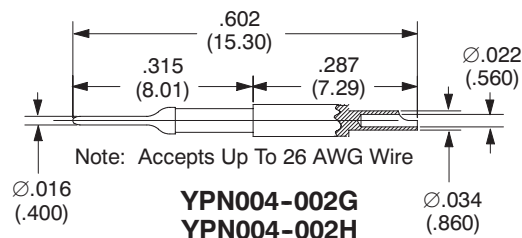
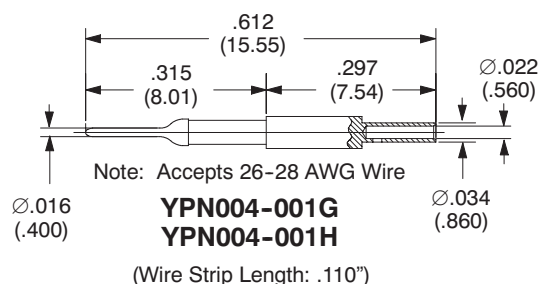

FEMALE CONTACTS (SOCKETS)

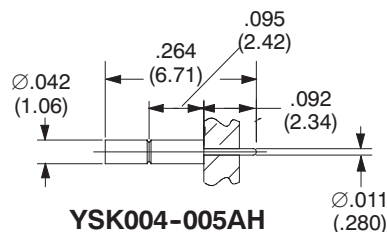
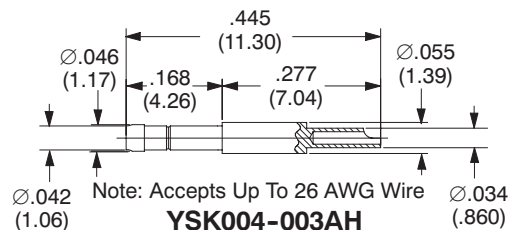
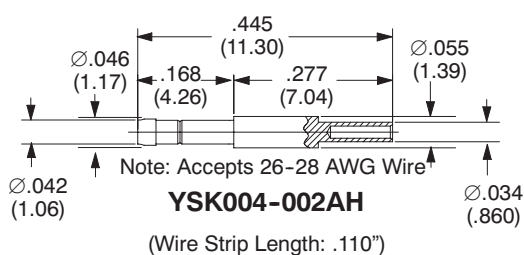

Notes

1) Dimensions in inches (mm).

Ø .024" (.60mm) CONTACTS

Materials: Beryllium copper wires and brass body
 Plating: Gold over nickel
 Resistance: < 5 milliohms
 Current Rating: 4 amps
 Extraction Force: Min. .5 oz., Max 3.2 oz.
 Life: 100,000 cycles

Plating reference

Male Pins: G = 10 µin. gold (min) over Ni
 H = 50 µin. gold (min) over Ni
 Female Sockets: AH = 50 µin. gold (min) over Ni on mating surface and gold flash over Ni on termination

MALE CONTACTS (PINS)

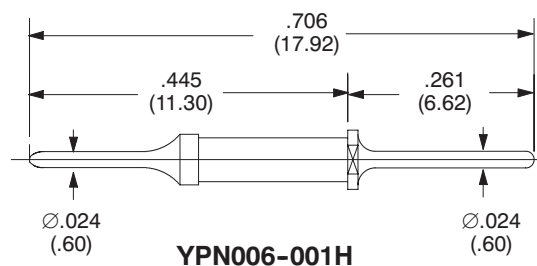
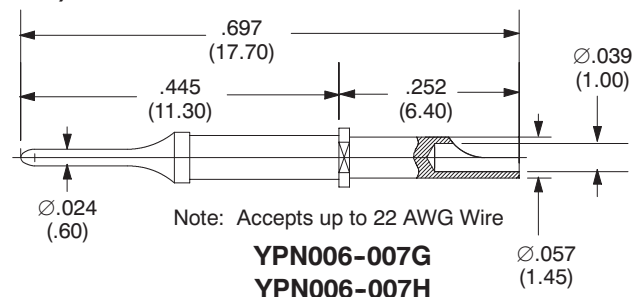
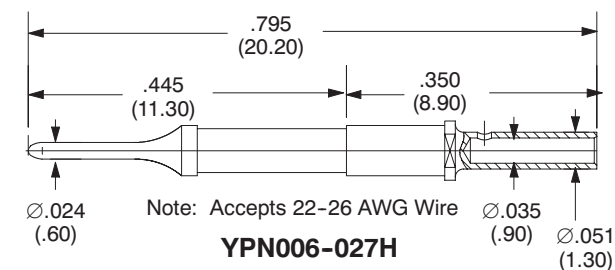

FEMALE CONTACTS (SOCKETS)

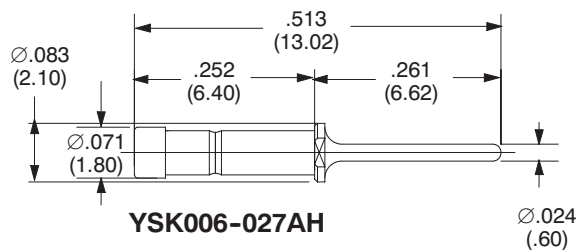
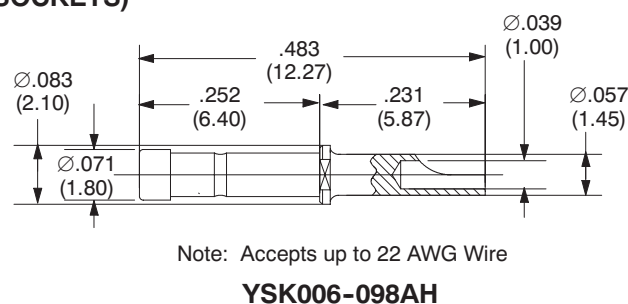
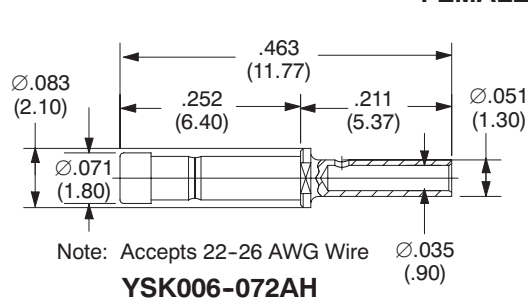

Notes

1) Dimensions in inches (mm).

Ø .030" (.76mm) CONTACTS

Materials: Beryllium copper wires and brass body
Plating: Gold over nickel
Resistance: < 5 milliohms
Current Rating: 5 amps
Extraction Force: Min. .5 oz., Max 3.2 oz.
Life: 100,000 cycles

Plating reference

Male Pins:

G = 10 µin. gold (min) over Ni

H = 50 µin. gold (min) over Ni

Female Sockets:

AH = 50 µin. gold (min) over Ni on mating surface and gold flash over Ni on termination

GT = 10 µin. gold (min) over Ni on mating surface and tin lead on socket body only.

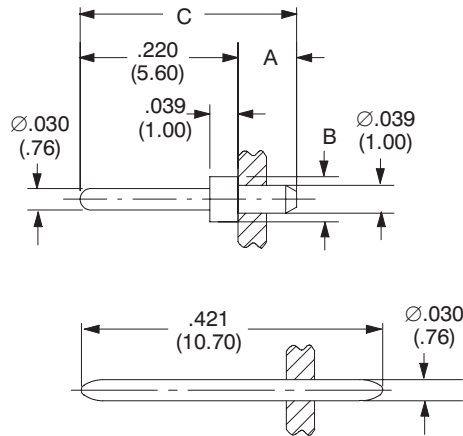

YPN0076-001H

MALE CONTACTS (PINS)

PART NUMBER	DIM A	DIM B	DIM C
YPN0076-004H	.145 (3.69)	Ø.062 (1.58)	.365 (9.28)
YPN0076-005H	.150 (3.81)	Ø.081 (2.05)	.370 (9.40)
HSP030M2G HSP030M2H	.082 (2.08)	Ø.063 (1.60)	.302 (7.68)
HSP030M3G	.110 (2.80)	Ø.081 (2.05)	.331 (8.40)

FEMALE CONTACTS (SOCKETS)

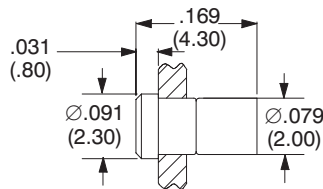

YSK0076-021AH

Note: Suggested Solder Mount Hole
Ø.084 ± .002
(Ø2.13 ± 0.05)

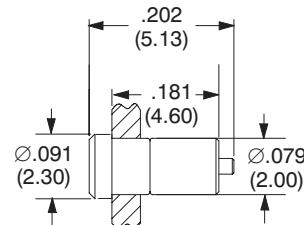

YSK0076-014AH

Note: Suggested Solder Mount Hole
Ø.084 ± .002
(Ø2.13 ± 0.05)

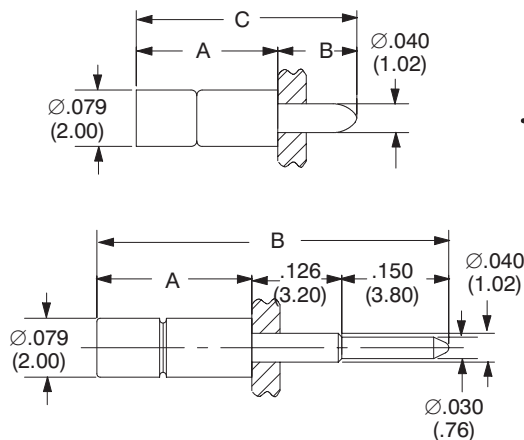

PART NUMBER	DIM A	DIM B	DIM C
YSK0076-011AH YSK0076-011GT	.199 (5.05)	.110 (2.80)	.309 (7.85)
YSK0076-012GT	.199 (5.05)	.187 (4.75)	.386 (9.80)
YSK0076-040AH YSK0076-040GT	.207 (5.27)	.135 (3.43)	.343 (8.70)

PART NUMBER	DIM A	DIM B
YSK0076-026AH	.209 (5.30)	.484 (12.30)
YSK0076-068AH	.217 (5.50)	.492 (12.50)

Notes

1) Dimensions in inches (mm).

Ø .018" (.45mm) CONTACTS

Materials: Beryllium copper wires and brass body
Plating: Gold over nickel
Resistance: < 8 milliohms
Current Rating: 2.5 amps
Extraction Force: Min. .5 oz., Max 1.6 oz.
Life: 100,000 cycles

Plating reference:

Male Pins: G = 10 µin. gold (min) over Ni
H = 50 µin. gold (min) over Ni
Female Sockets: AH = 50 µin. gold (min) over Ni on mating surface and gold flash over Ni on termination
HT = 50 µin. gold (min) over Ni on mating surface and tin lead on termination
ABH = 50 µin. gold (min) over Ni on mating surface and tin lead on tail. All other surfaces gold flash.

MALE CONTACTS (PINS)

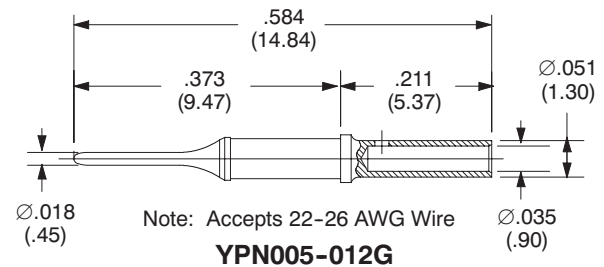
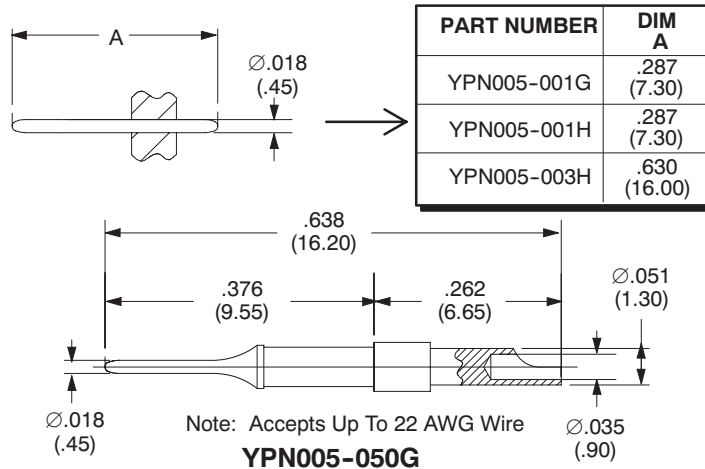

FEMALE CONTACTS (SOCKETS)

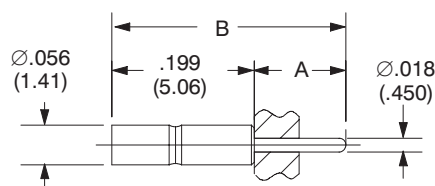
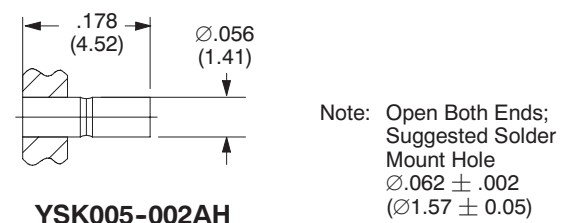
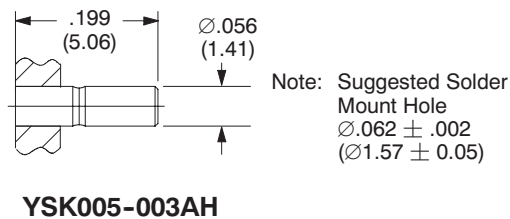
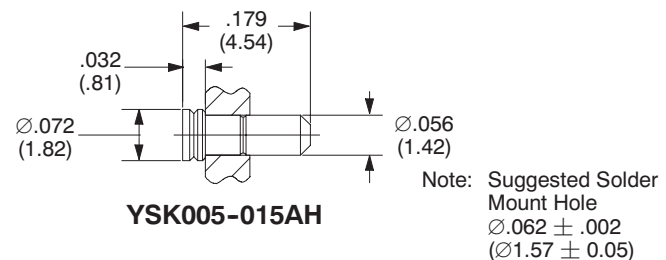
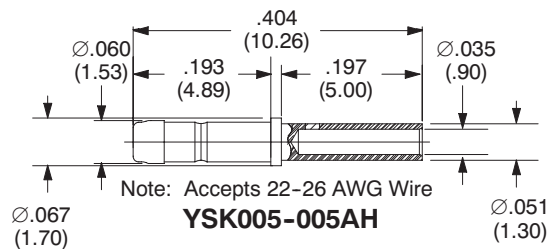

PART NUMBER	DIM A	DIM B
YSK005-004AH	.128 (3.25)	.327 (8.31)
YSK005-008AH	.307 (7.80)	.506 (12.86)

Notes

1) Dimensions in inches (mm).

Ø .040" (1.02mm) CONTACTS

Materials: Beryllium copper wires and brass body
 Plating: Gold over nickel
 Resistance: < 2.5 milliohms
 Current Rating: 7.5 amps
 Extraction Force: Min. 1.0 oz., Max 3.9 oz.
 Life: 100,000 cycles

Plating Reference

Male Pins: G = 10 µin gold (min) over Ni
 H = 50 µin gold (min) over Ni
 Female Sockets: AH = 50 µin gold (min) over Ni on mating surface, gold flash over Ni on termination

MALE CONTACTS (PINS)

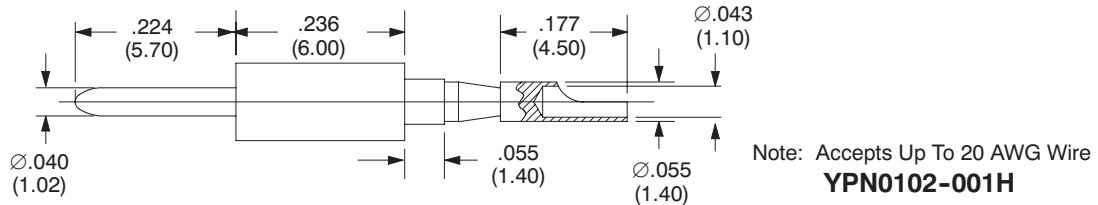
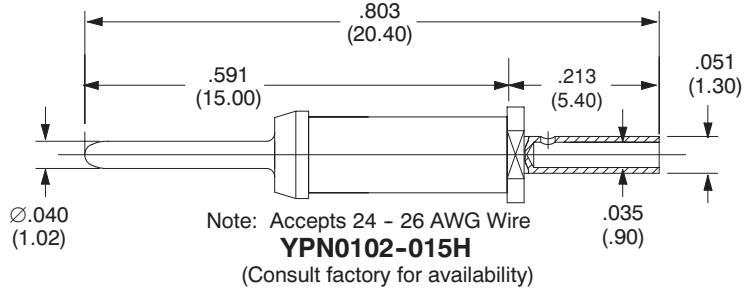
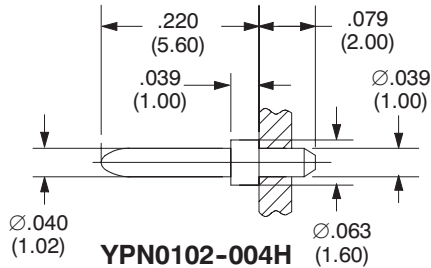

FEMALE CONTACTS (SOCKETS)

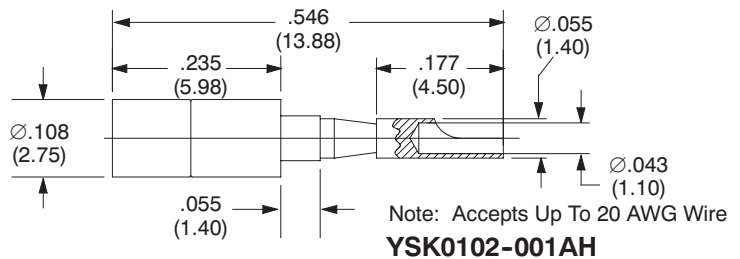
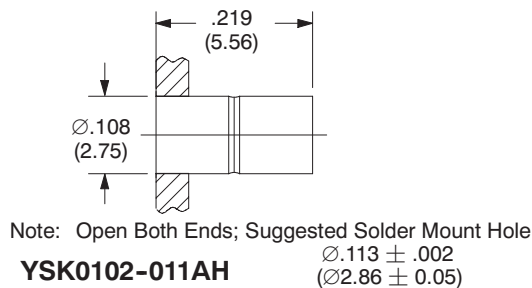
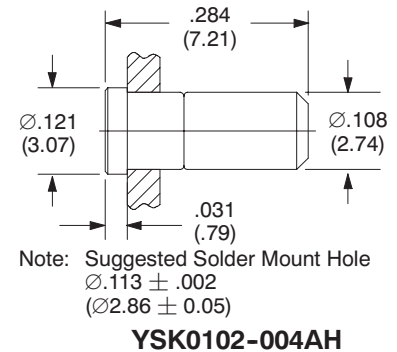
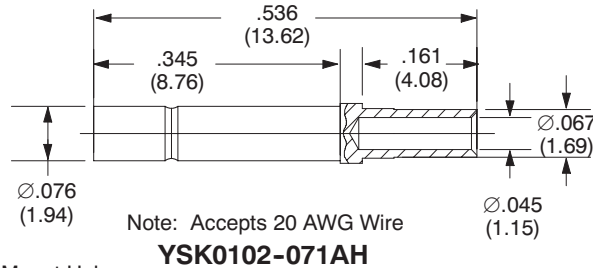
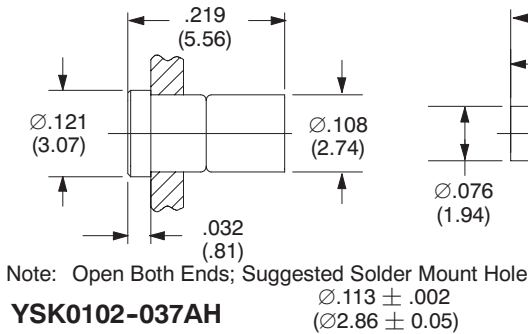

Notes

1) Dimensions in inches (mm).

Ø .059" (1.5mm) CONTACTS

Materials: Beryllium copper wires and brass body
Plating: Gold over nickel
Resistance: < 2.5 milliohms
Current Rating: 8-10 amps
Extraction Force: Min. 1.2 oz., Max 5 oz.
Life: 100,000 cycles

Plating Reference

Male Pins: G = 10 µin gold (min) over Ni
H = 50 µin gold (min) over Ni
Female Sockets: AH = 50 µin gold (min) over Ni on mating surface, gold flash over Ni on termination

MALE CONTACTS (PINS)

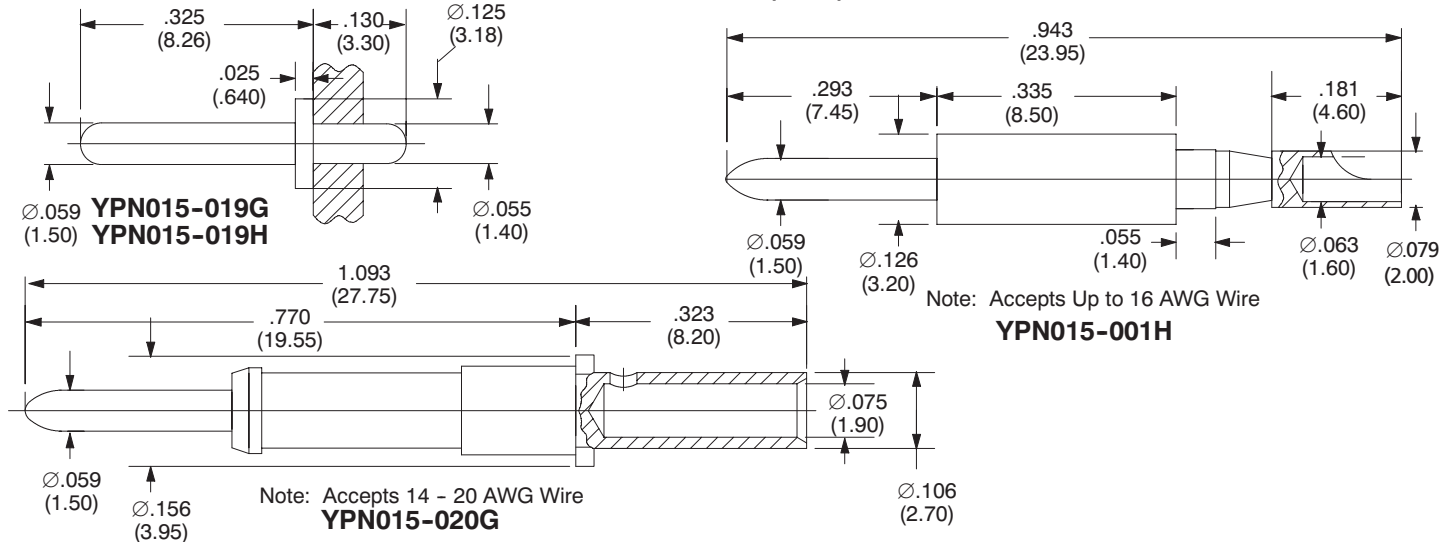

FEMALE CONTACTS (SOCKETS)

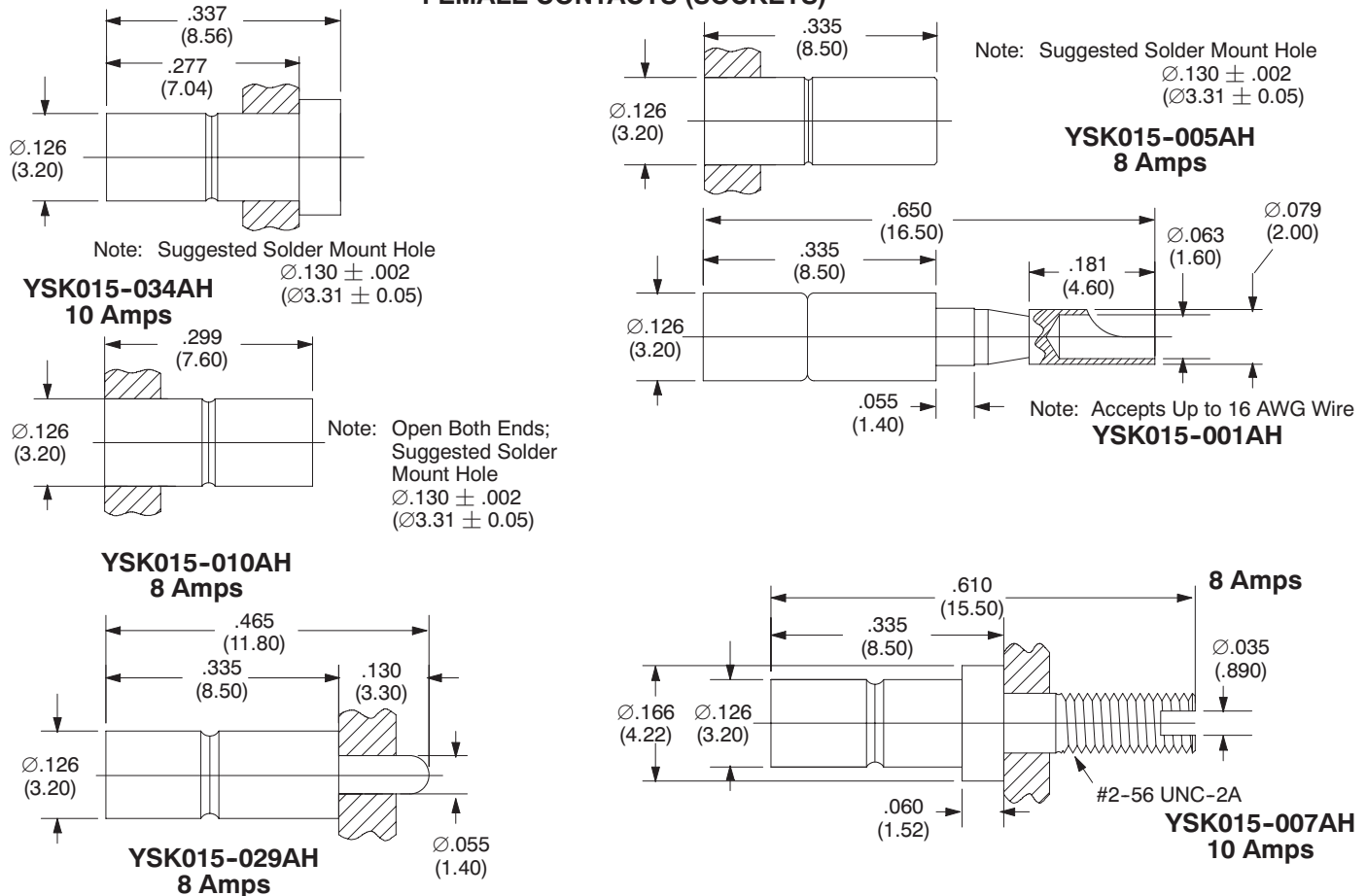

Notes

1) Dimensions in inches (mm).

Ø .098" (2.5mm) CONTACTS

Materials: Beryllium copper wires and brass body
 Plating: Gold over nickel
 Resistance: < .8 milliohms
 Current Rating: 15 amps
 Extraction Force: Min. 6 oz., Max 25 oz.
 Life: 100,000 cycles

Plating Reference

Male Pins: G = 10 µin gold (min) over Ni
 H = 50 µin gold (min) over Ni
 Female Sockets: AH = 50 µin gold (min) over Ni on mating surface, gold flash over Ni on termination

MALE CONTACTS (PINS)

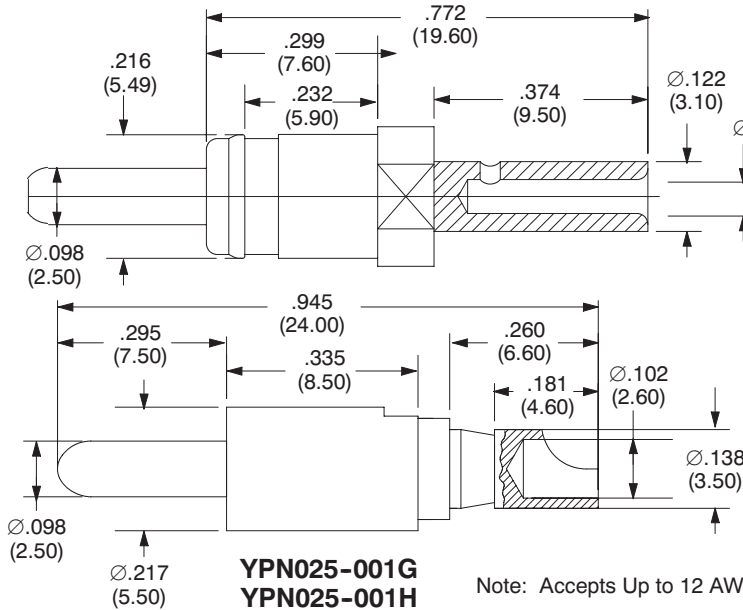

PART NUMBER	DIM A	WIRE SIZE
YPN025-002G	Ø.059 (1.50)	18 - 22 AWG
YPN025-002H	Ø.059 (1.50)	18 - 22 AWG
YPN025-003G	Ø.076 (1.95)	13 - 14 AWG
YPN025-003H	Ø.076 (1.95)	13 - 14 AWG
CRIMP TOOL: M300BT POSITIONER: SP611		

FEMALE CONTACTS (SOCKETS)

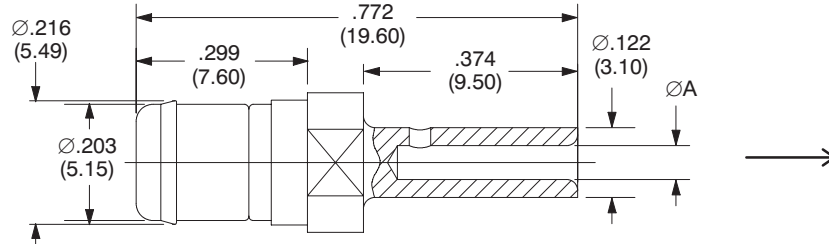

PART NUMBER	DIM A	WIRE SIZE
YSK025-003AH	Ø.059 (1.50)	18 - 22 AWG
YSK025-004AH	Ø.074 (1.87)	13 - 14 AWG
CRIMP TOOL: M300BT POSITIONER: SP611		

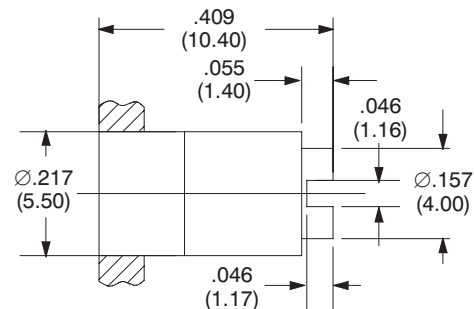
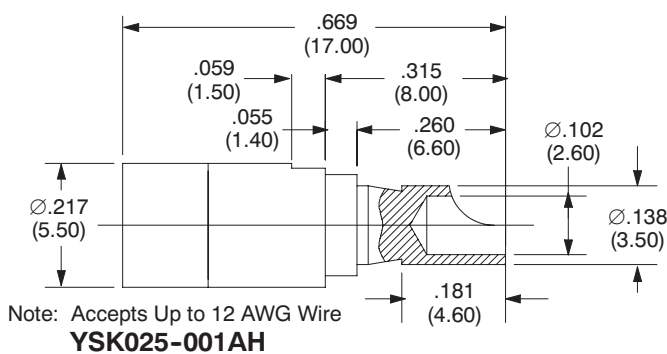

Notes

1) Dimensions in inches (mm).

Ø .138" (3.5mm) CONTACTS

Materials: Beryllium copper wires and brass body
Plating: Gold over nickel
Resistance: < .5 milliohms
Current Rating: 25, 40, & 50 amps
Extraction Force: Min. 7 oz., Max 32 oz.
Life: 100,000 cycles

Plating Reference

Male Pins: G = 10 µin gold (min) over Ni
H = 50 µin gold (min) over Ni
Female Sockets: AH = 50 µin gold (min) over Ni on mating surface, gold flash over Ni on termination

MALE CONTACTS (PINS)

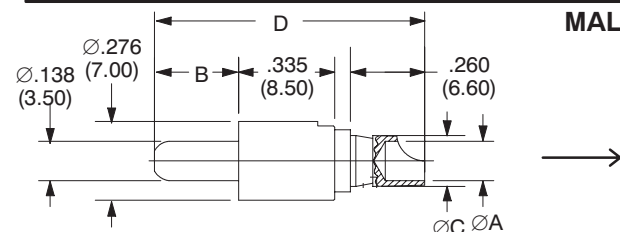

Part Number	Dim A	Dim B	Dim C	Dim D	Wire Size	Current Rating
YPN035-001H	.137 (3.50)	.295 (7.50)	.177 (4.50)	.945 (24.00)	10 AWG	25 Amps
YPN035-024H	.177 (4.50)	.374 (9.50)	.193 (4.90)	.193 (4.90)	8 AWG	50 Amps

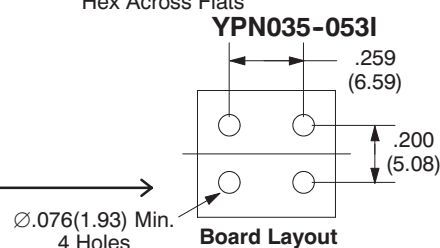
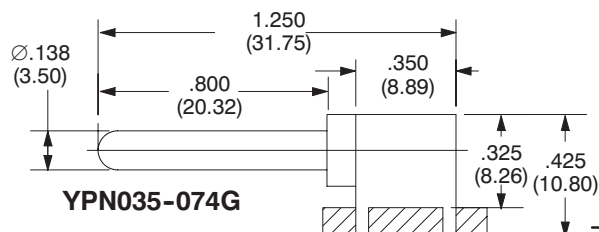
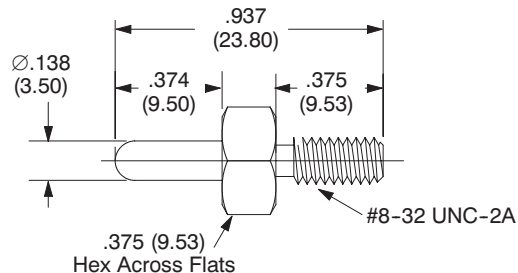
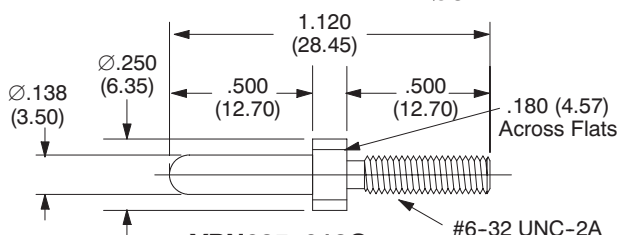

Board Layout

FEMALE CONTACTS (SOCKETS)

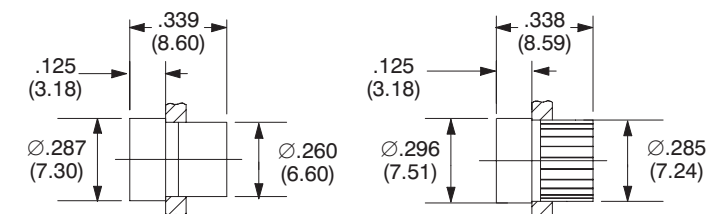
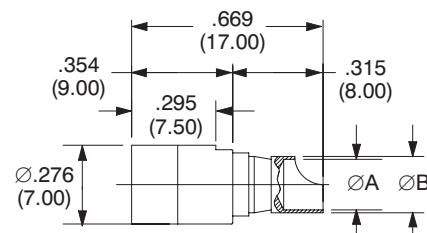
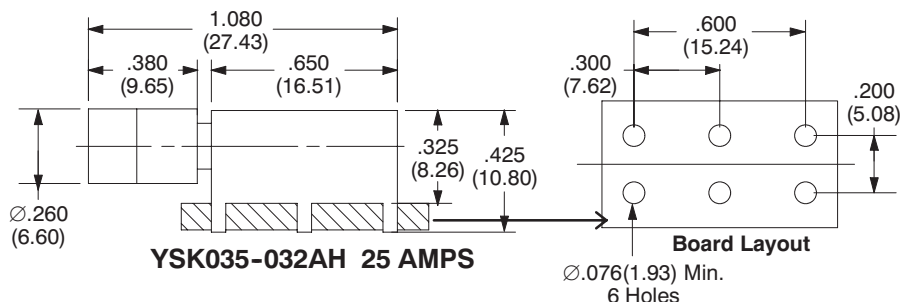

YSK035-004AH 25 AMPS

Part Number	Dim A	Dim B	Wire Size	Current Rating
YSK035-001AH	.137 (3.50)	.177 (4.50)	10 AWG	25 Amps
YSK035-006AH	.137 (3.50)	.177 (4.50)	10 AWG	40 Amps
YSK035-027AH	.177 (4.50)	.193 (4.90)	8 AWG	50 Amps

Ø .169" (4.3mm) CONTACTS

Materials: Beryllium copper wires and brass body
 Plating: Gold over nickel
 Resistance: < .37 milliohms
 Current Rating: 100 amps
 Extraction Force: Min. 15 oz., Max 90 oz.
 Life: 100,000 cycles

Plating Reference

Male Pins: G = 10 µin gold (min) over Ni
 H = 50 µin gold (min) over Ni
 Female Sockets: AH = 50 µin gold (min) over Ni on mating surface, gold flash over Ni on termination

MALE CONTACTS (PINS)

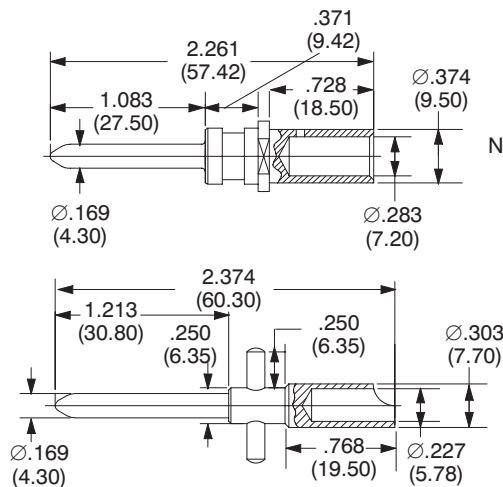

Note: Accepts 4 AWG Wire
YPN043-016RG

Note: Accepts Up To 5 AWG Wire
 Mates Only With YSK043-008AH
YPN043-009H
 (Consult factory for availability)

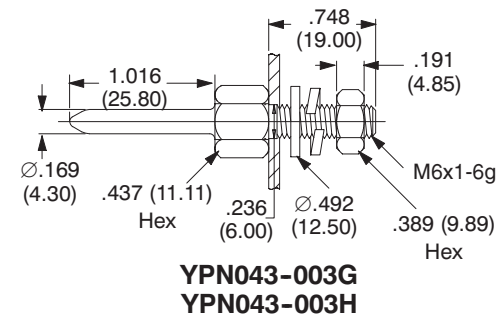

FEMALE CONTACTS (SOCKETS)

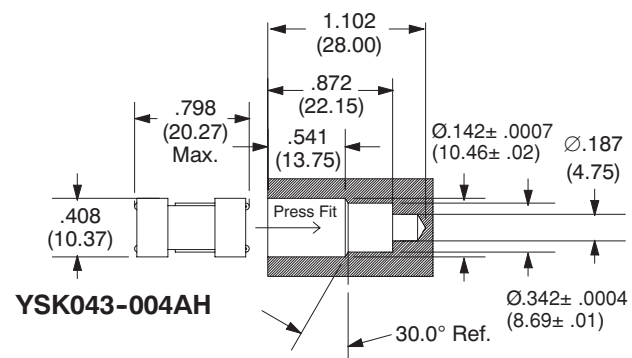
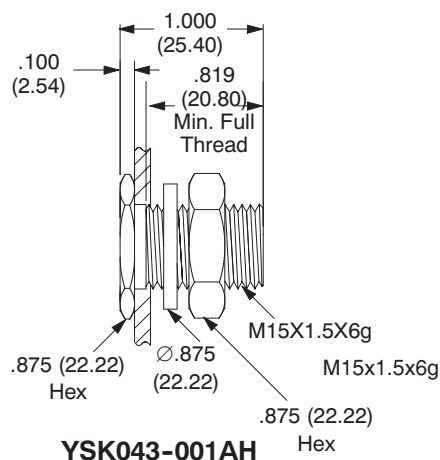
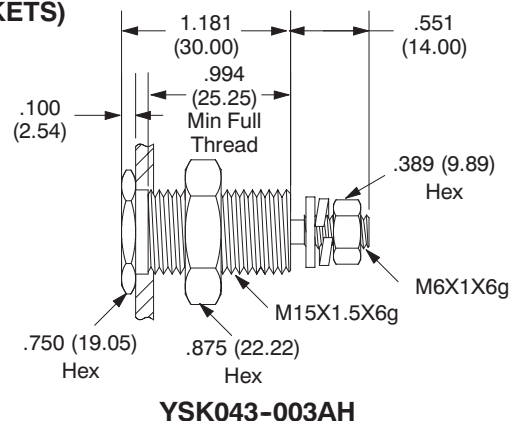
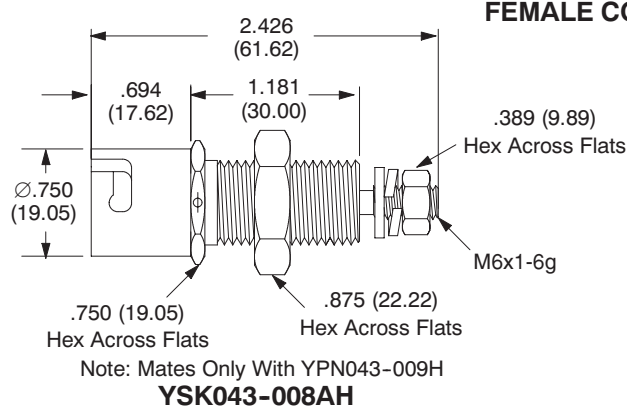

Notes

1) Dimensions in inches (mm).

Ø .241" (6.12mm) CONTACTS

Materials: Beryllium copper wires and brass body
Plating: Gold over nickel
Resistance: < .25 milliohms
Current Rating: 200 amps
Extraction Force: Min. 80 oz., Max 160 oz.
Life: 100,000 cycles

Plating Reference G = 10 µin gold (min) over Ni
Male Pins: H = 50 µin gold (min) over Ni
R1= 30 µin gold (min) over Ni
Female Sockets: AH = 50 µin gold (min) over Ni on mating surface, gold flash over Ni on termination

MALE CONTACTS (PINS)

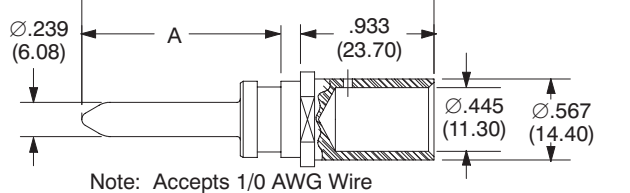

Note: Accepts 1/0 AWG Wire

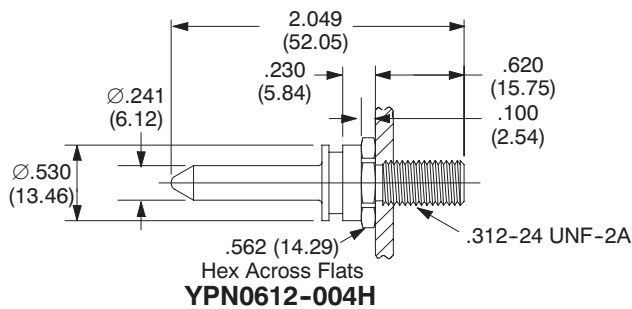

Part Number	Dim A	Dim B
YPN0612-021Rl	1.392 (35.35)	2.463 (62.55)
YPN0612-023Rl	1.626 (41.30)	2.697 (68.50)

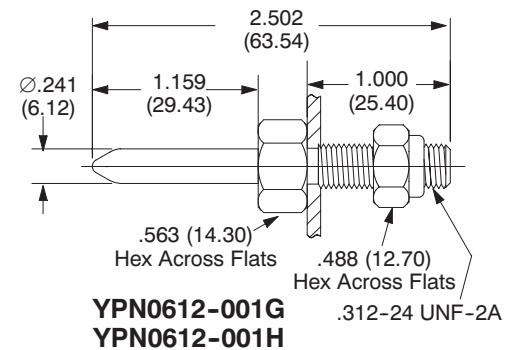

FEMALE CONTACTS (SOCKETS)

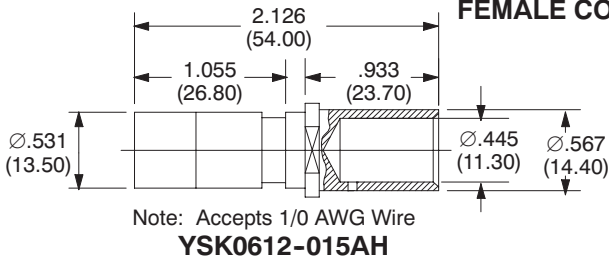

Note: Accepts 1/0 AWG Wire

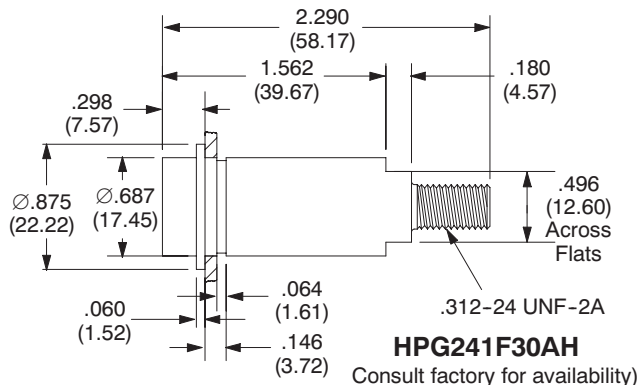

Consult factory for availability)

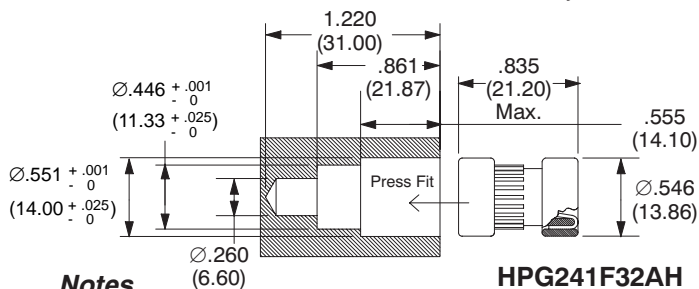

(Consult factory for availability)

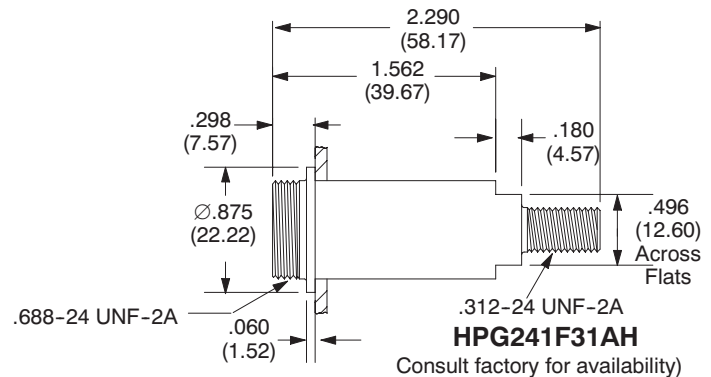
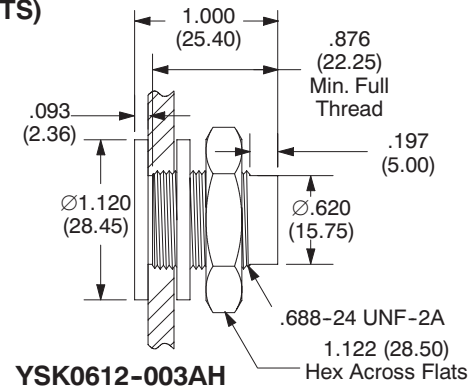

Consult factory for availability)

Notes

1) Dimensions in inches (mm).

Ø .500" (12.70mm) CONTACTS

Materials: Beryllium copper wires and brass body
 Plating: Gold over nickel
 Resistance: < .08 milliohms
 Current Rating: 350 amps
 Extraction Force: Min. 9 lbs., Max 20 lbs.
 Life: 100,000 cycles

Plating Reference
 Male Pins: G = 10 µin gold (min) over Ni
 H = 50 µin gold (min) over Ni
 Female Sockets: AH = 50 µin gold (min) over Ni on mating surface, gold flash over Ni on termination

MALE CONTACTS (PINS)

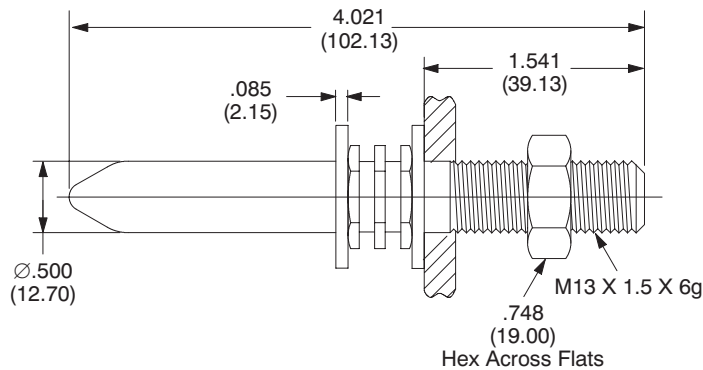

YPN127-004G
 YPN127-004H

FEMALE CONTACTS (SOCKETS)

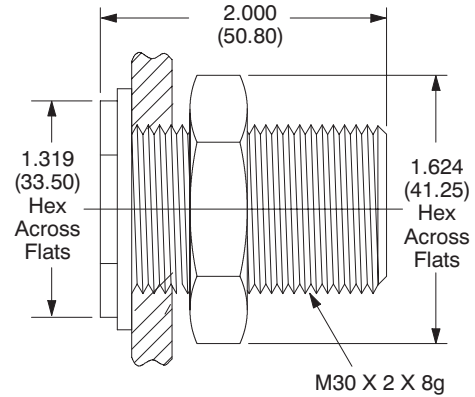

YSK127-004AH

Ø .650" (16.50mm) CONTACTS

Materials: Beryllium copper wires and brass body
 Plating: Gold over nickel
 Resistance: < .04 milliohms
 Current Rating: 500 amps
 Extraction Force: Min. 20 lbs., Max 37 lbs.
 Life: > 100,000 cycles

Plating Reference
 Male Pins: G = 10 µin gold (min) over Ni
 H = 50 µin gold (min) over Ni
 Female Sockets: AH = 50 µin gold (min) over Ni on mating surface, gold flash over Ni on termination

MALE CONTACTS (PINS)

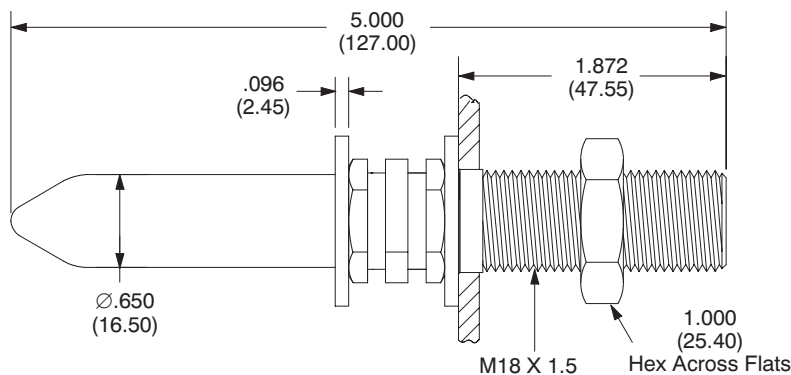

YPN165-002G
 YPN165-002H
 Consult factory for availability)

FEMALE CONTACTS (SOCKETS)

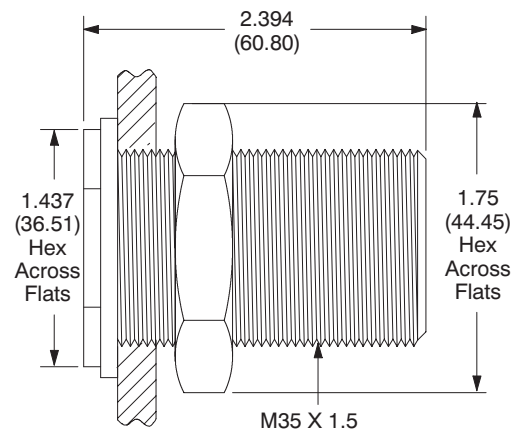

YSK165-001AH
 Consult factory for availability)

Notes

1) Dimensions in inches (mm).