

LIMIT SWITCH - INDUCTIVE DOUBLE SENSOR

TYPE 5300



GENERAL

| | |
|-------------------------|---------------------------------|
| FUNCTION: | PNP |
| VOLTAGE: | 10V DC - 30V DC |
| VOLTAGE DROP: | 3V DC |
| NO-LOAD SUPPLY CURRENT: | 22.5 mA |
| OPERATIONAL CURRENT: | 200 mA |
| ASSURED OPERAT. DIST.: | 0 - 4 mm |
| OUTPUT TYPE: | 3-WIRE |
| CONNECTION: | 5 M CABLE OR M12 MALE CONNECTOR |
| TEMPERATURE: | -25°C TO 70°C |
| MATERIAL: | GLASS FIBRE REINFORCED PLASTIC |
| MOUNTING: | VDI / VDE 3845 |
| ENCLOSURE: | IP67 |
| OUTPUT INDICATOR: | YELLOW LED |
| VOLTAGE INDICATOR: | GREEN LED |

OPTION

| | |
|------------|--------------------------------------|
| INDICATOR: | 3-WAYS "T" OR "L" |
| FUNCTION: | NPN |
| CONNECTOR: | M12 FEMALE CONNECTOR, STRAIGHT/ANGLE |
| TARGET: | ALUMINUM, COPPER |
| ATEX: | EX, II G EX IA II C T6 |

DIMENSIONS

SENSOR

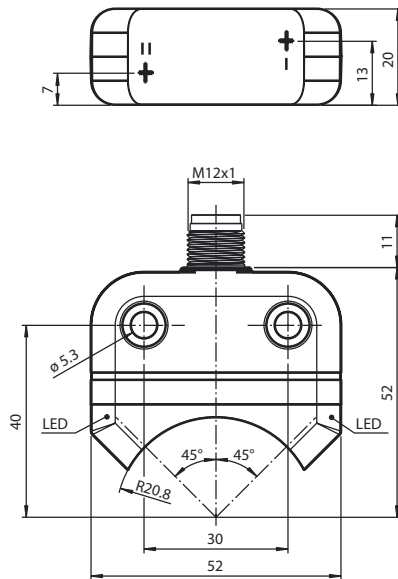

FIELD-ATTACHABLE CONNECTOR

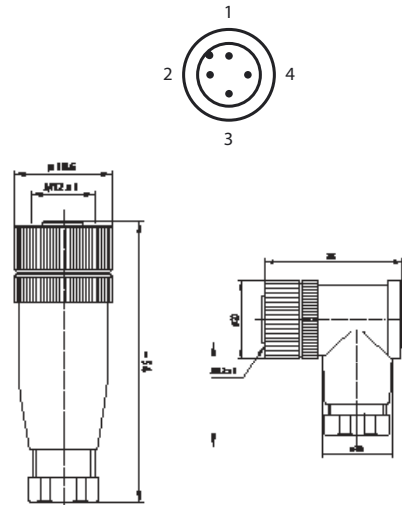

DESCRIPTION

- **Inductive double sensor with 90° activation** between open and closed position. Suitable for the most of our valves.
- **Short circuit protection.**
- **Can be supplied in ATEX edition.**
- **Complies with EN 60947-5-2**, connection equipment for low voltage.
- **Excellent visual indication** of open and closed valve via LED diodes.
- **Made of corrosion resistant material** (glass fibre reinforced plastic).
- **Easy mounting.**

MOUNTING KIT FOR PNEUMATIC ACTUATOR DVC TYPE 505

| ACTUATOR SIZE | ITEM NO. BRACKET INCL. BOLTS AND WASHERS | ILLUSTRATION |
|---------------|--|--|
| 505-40 | NO BRACKETS REQUIRED |   2 PCS. M5X25MM UMBRACOBOLT A2  2 PCS. M5 LOCKING WASHER A2 |
| 505-52 | NO BRACKETS REQUIRED | |
| 505-63 | NO BRACKETS REQUIRED | |
| 505-75 | NO BRACKETS REQUIRED | |
| 505-83 | NO BRACKETS REQUIRED | |
| 505-92 | NO BRACKETS REQUIRED | |
| 505-105 | NO BRACKETS REQUIRED | |
| 505-125 | BRACKETS IN AISI 304 |   2 PCS. M5X50MM UMBRACOBOLT A2  2 PCS. M5 LOCKING WASHER A2 |
| 505-140 | BRACKETS IN AISI 304 | |
| 505-160 | BRACKETS IN AISI 304 | |
| 505-190 | BRACKETS IN AISI 304 |   2 PCS. M5X10MM UMBRACOBOLT A2  2 PCS. M5X25MM UMBRACOBOLT A2  2 PCS. M5 LOCKING WASHER A2 |
| 505-210 | BRACKETS IN AISI 304 | |
| 505-240 | BRACKETS IN AISI 304 | |
| 505-270 | BRACKETS IN AISI 304 | |

TYPE 505 ACTUATORS FROM DVC ARE DELIVERED STANDARD WITH INDICATOR IN ABS AND STAINLESS STEEL ACTIVATION TARGET.

ELECTRICAL DIAGRAM

